

- LEGEND**
- PROPOSED LIGHT POLE, SPECIAL (DECORATIVE ORNAMENTAL) AND DECORATIVE LIGHT TYPE A, 250 WATT
 - PROPOSED LIGHT POLE, SPECIAL (DECORATIVE ORNAMENTAL) AND DECORATIVE LIGHT TYPE B, 150 WATT
 - PROPOSED LIGHTING CONTROLLER, BASE MOUNTED, 480 VOLT, 100 AMP
 - PROPOSED UNIT DUCT, 600V, 3-1C NO. 10, 1/2" DIA. POLYETHYLENE
 - PROPOSED UNIT DUCT, 600V, 3-1C NO. 8, 1/2" DIA. POLYETHYLENE
 - PROPOSED CONDUIT IN TRENCH (T) 3/4" DIA., GALVANIZED STEEL
 - PROPOSED CONDUIT IN TRENCH (T) 2" DIA., GALVANIZED STEEL
 - REMOTE CONTROLLED VIDEO SYSTEM, LAYER II (DATALINK) SWITCH, VIDEO ENCODER, CLOSED CIRCUIT TELEVISION CABINET, WIRELESS VIDEO DISTRIBUTION SYSTEM, CAT 5 ETHERNET CABLE, AND CAMERA MOUNTING ASSEMBLY

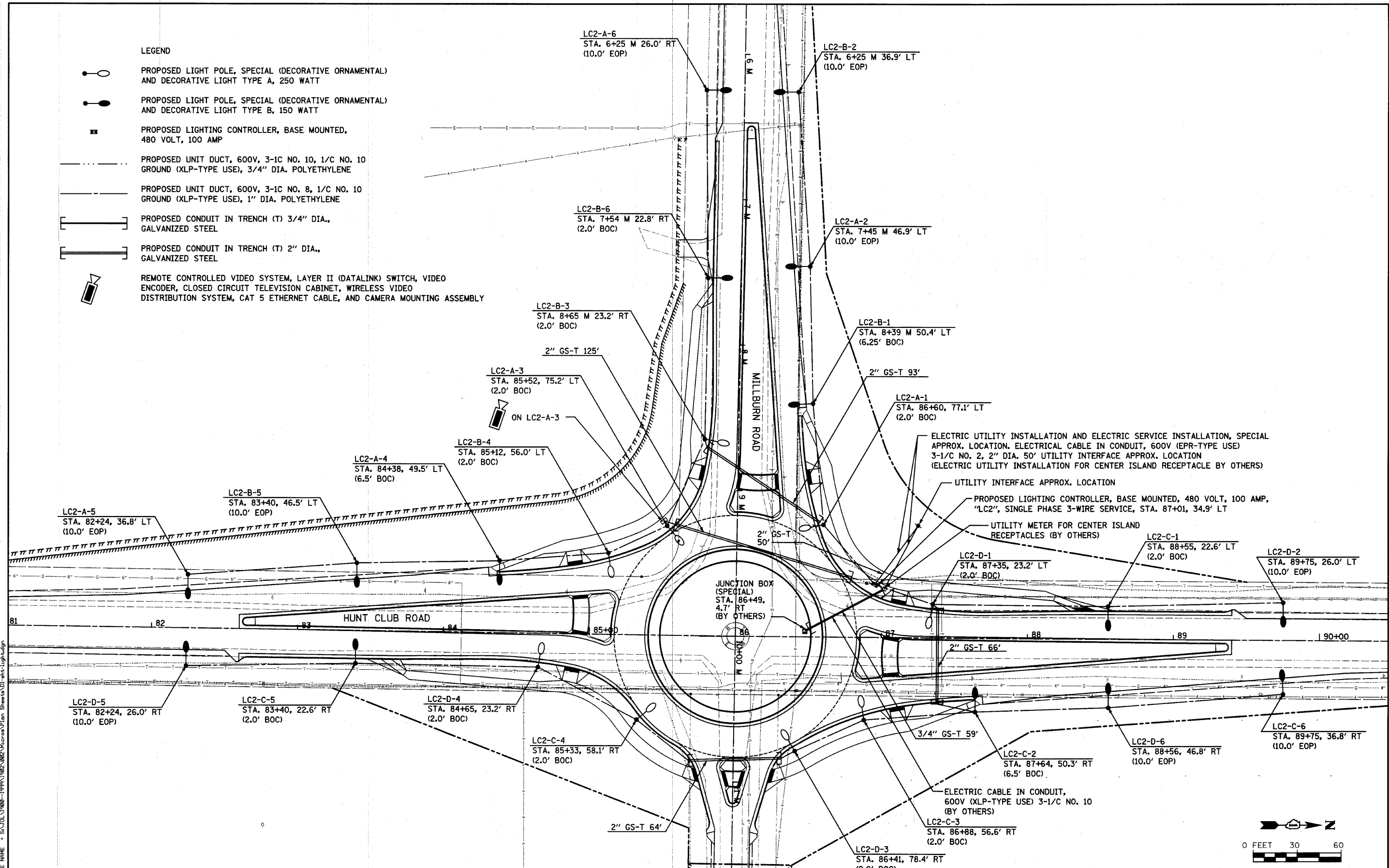

FILE NAME = S:\JUL\1900-1999\1902\002\Micro\Plan_Sheets\01-akt-light.dgn



USER NAME = marcg	DESIGNED -	REVISED - LCD0T - 05/17/10
PLOT SCALE = 3/8" = 1' IN.	DRAWN -	REVISED - SAI - 08/03/10
PLOT DATE = 9/13/2012	CHECKED -	REVISED - SAI - 9/10/10
	DATE -	REVISED -

**STATE OF ILLINOIS
DEPARTMENT OF TRANSPORTATION**

LIGHTING PLAN				
SCALE: AS SHOWN	SHEET NO.	OF SHEETS	STA.	TO STA.

F.A. RTE.	SECTION	COUNTY	TOTAL SHEETS	SHEET NO.
2661	02-00076-13-CH	LAKE	177	78
FED. ROAD DIST. NO. 1 [ILLINOIS] FED. AID PROJECT				
CONTRACT NO. 63457				