

FILE NAME = s:\p\1906-1999\1902\002\micross\Plan Sheets\DL-shr-interacc.dgn

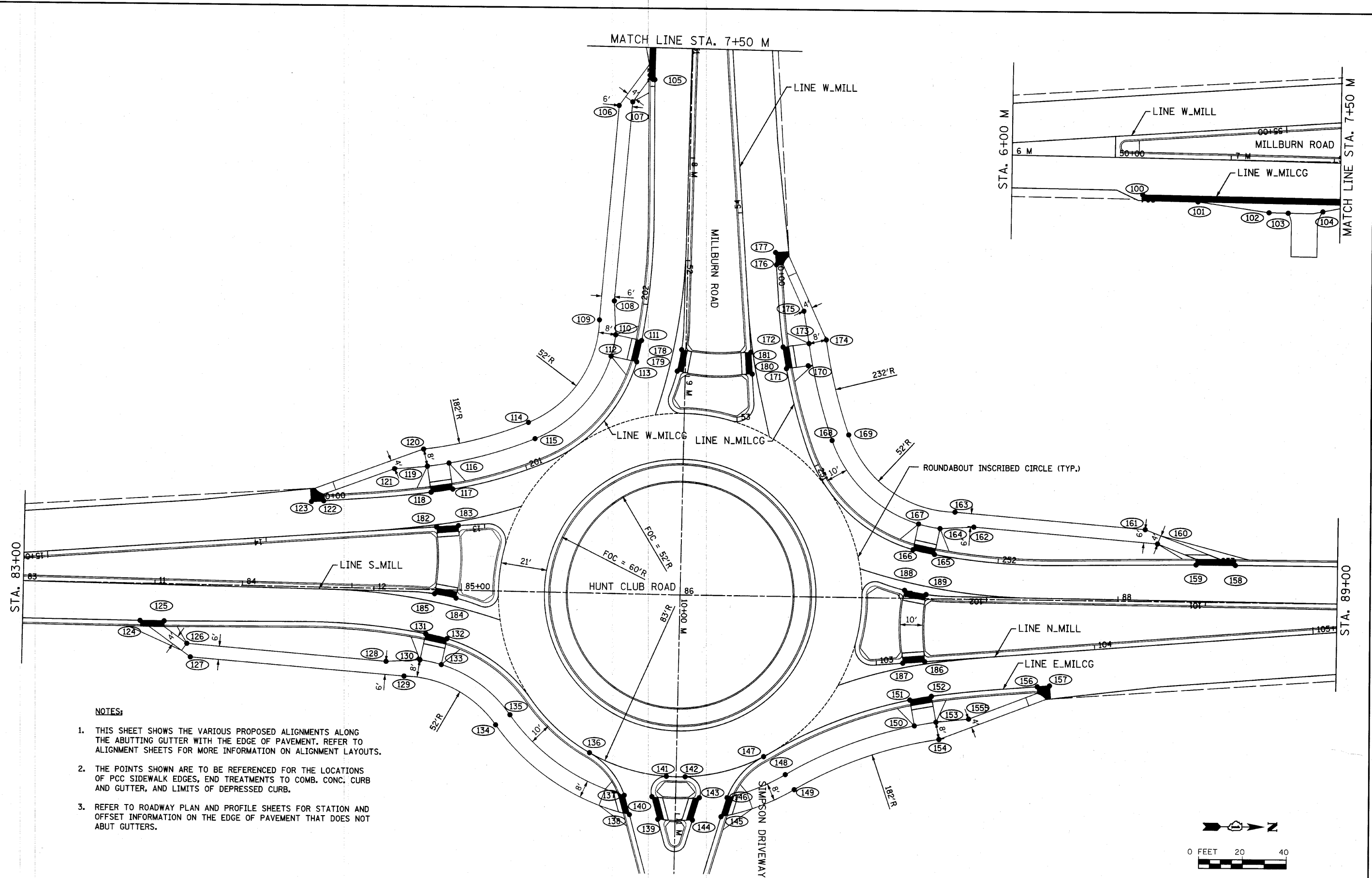

- NOTES:**
1. THIS SHEET SHOWS THE VARIOUS PROPOSED ALIGNMENTS ALONG THE ABUTTING GUTTER WITH THE EDGE OF PAVEMENT. REFER TO ALIGNMENT SHEETS FOR MORE INFORMATION ON ALIGNMENT LAYOUTS.
 2. THE POINTS SHOWN ARE TO BE REFERENCED FOR THE LOCATIONS OF PCC SIDEWALK EDGES, END TREATMENTS TO COMB. CONC. CURB AND GUTTER, AND LIMITS OF DEPRESSED CURB.
 3. REFER TO ROADWAY PLAN AND PROFILE SHEETS FOR STATION AND OFFSET INFORMATION ON THE EDGE OF PAVEMENT THAT DOES NOT ABUT GUTTERS.

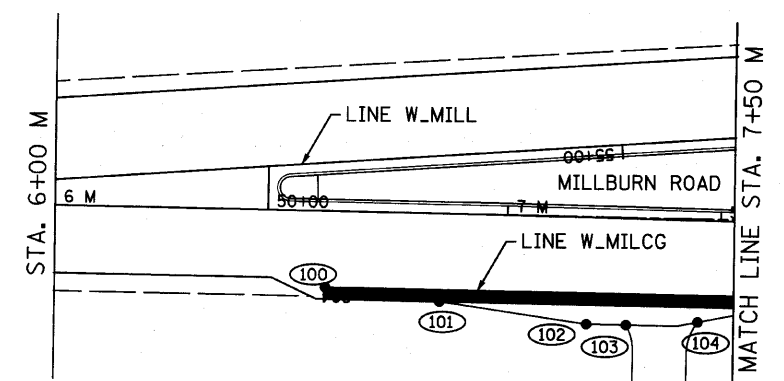

1170 SOUTH HOUBOLT ROAD JOLIET, ILLINOIS 60431 (815) 744-4200	USER NAME = soren	DESIGNED -	REVISED -
	PLOT SCALE = 20.0000' / IN.	DRAWN -	REVISED -
	PLOT DATE = 4/1/2012	CHECKED -	REVISED -
		DATE -	REVISED -

**STATE OF ILLINOIS
DEPARTMENT OF TRANSPORTATION**

ROUNDABOUT DETAIL SHEET
MILLBURN ROAD AND HUNT CLUB ROAD
SCALE: AS SHOWN | SHEET NO. OF SHEETS | STA. N/A TO STA. N/A

F.A.U. RTE.	SECTION	COUNTY	TOTAL SHEETS	SHEET NO.
2661	02-00076-13-CH	LAKE	177	90
CONTRACT NO. 63457				
FED. ROAD DIST. NO. 1 ILLINOIS FED. AID PROJECT				