

PAY ITEM NUMBER	PAY ITEMS	UNITS	URBAN TOTAL QUANTITY	CONSTRUCTION TYPE CODE	
				ROADWAY 80% FEDERAL 20% LOCAL 1000-2A	BRIDGE 80% FEDERAL 20% LOCAL X028-2A
20101000	TEMPORARY FENCE	FOOT	195	195	---
20201200	REMOVAL AND DISPOSAL OF UNSUITABLE MATERIAL	CU YD	945	945	---
20400800	FURNISHED EXCAVATION	CU YD	250	250	---
20800150	TRENCH BACKFILL	CU YD	55	55	---
21101615	TOPSOIL FURNISH AND PLACE, 4"	SQ YD	1,670	1,670	---
X21300 10	EXPLORATION TRENCH, SPECIAL	FOOT	50	50	---
25000210	SEEDING, CLASS 2A	ACRE	0.3	0.3	---
25000310	SEEDING, CLASS 4	ACRE	0.1	0.1	---
25000400	NITROGEN FERTILIZER NUTRIENT	POUND	31	31	---
25000500	PHOSPHORUS FERTILIZER NUTRIENT	POUND	31	31	---
25000600	POTASSIUM FERTILIZER NUTRIENT	POUND	31	31	---
25100630	EROSION CONTROL BLANKET	SQ YD	1,670	1,670	---
28000250	TEMPORARY EROSION CONTROL SEEDING	POUND	35	35	---
28000305	TEMPORARY DITCH CHECKS	FOOT	32	32	---
28000400	PERIMETER EROSION BARRIER	FOOT	655	655	---
28000510	INLET FILTERS	EACH	1	1	---
28100105	STONE RIPRAP, CLASS A3	SQ YD	16	16	---
28100705	STONE DUMPED RIPRAP, CLASS A3	SQ YD	45	---	45
28200200	FILTER FABRIC	SQ YD	20	20	---
31101200	SUB-BASE GRANULAR MATERIAL, TYPE B 4"	SQ YD	725	725	---
35501316	HOT-MIX ASPHALT BASE COURSE, 8"	SQ YD	725	725	---
40201000	AGGERGATE FOR TEMPORARY ACCESS	TON	25	25	---
40600100	BITUMINOUS MATERIALS (PRIME COAT)	GALLON	45	45	---
40603080	HOT-MIX ASPHALT BINDER COURSE, IL-19.0, N50	TON	85	85	---
40603310	HOT-MIX ASPHALT SURFACE COURSE, MIX "C", N50	TON	85	85	---
42400200	PORTLAND CEMENT CONCRETE SIDEWALK 5 INCH	SQ FT	510	510	---
44000100	PAVEMENT REMOVAL	SQ YD	610	610	---
44000200	DRIVEWAY PAVEMENT REMOVAL	SQ YD	85	85	---
44000500	COMBINATION CURB AND GUTTER REMOVAL	FOOT	28	28	---
44000600	SIDEWALK REMOVAL	SQ FT	470	470	---
48101200	AGGREGATE SHOULDERS, TYPE B	TON	40	40	---
50100100	REMOVAL OF EXISTING STRUCTURES	EACH	1	---	1
50104400	CONCRETE HEADWALL REMOVAL	EACH	1	1	---
50901750	PARAPET RAILING	FOOT	71	---	71
51500100	NAME PLATES	EACH	1	---	1
54001004	BOX CULVERT END SECTIONS, CULVERT NO. 1	EACH	2	---	2
54002020	EXPANSION BOLTS 3/4 INCH	EACH	60	---	60
54021005	PRECAST CONCRETE BOX CULVERT 10'X5' (M273)	FOOT	160	---	160
550A0410	STORM SEWERS, CLASS A, TYPE 2 24"	FOOT	78	78	---
55101200	STORM SEWER REMOVAL 24"	FOOT	60	60	---
60221100	MANHOLES, TYPE A, 5'-DIAMETER, TYPE 1 FRAME, CLOSED LID	EACH	1	1	---
60603800	COMBINATION CURB AND GUTTER, TYPE B-6.12	FOOT	328	328	---
67100100	MOBILIZATION	L SUM	1	1	---
70102550	TRAFFIC CONTROL AND PROTECTION FOR TEMPORARY DETOUR	EACH	1	1	---
* 78000200	THERMOPLASTIC PAVEMENT MARKING - LINE 4"	FOOT	420	420	---
* 78000400	THERMOPLASTIC PAVEMENT MARKING - LINE 6"	FOOT	10	10	---
Z0030850	TEMPORARY INFORMATION SIGNING	SQ FT	200	200	---
Z0004530	HOT-MIX ASPHALT DRIVEWAY PAVEMENT, 8"	SQ YD	85	85	---
Z0013798	CONSTRUCTION LAYOUT	L SUM	1	1	---

* SPECIALTY ITEM

COMPANY NAME: SEC Group, Inc.
PROJECT CONTACT: Robert G. Davis
CLIENT: Village of Harvard
DATE PLOTTED: 10/6/2010 11:01:53 AM
FILE NAME: 080594-Socq.dgn
PLOT DRIVER: pdf.plt
PEN TABLE: STANDARD-TRANS.TBL



USER NAME = JGuerr	DESIGNED - JPG	REVISED - 10/06/10
FILE NAME = 080594-Socq.dgn	DRAWN - WJH	REVISED -
PLOT SCALE = N.T.S.	CHECKED - RGD	REVISED -
PLOT DATE = 10/6/2010	DATE - 10/6/10	REVISED -

STATE OF ILLINOIS
DEPARTMENT OF TRANSPORTATION

AYER STREET OVER MOKELER CREEK
SUMMARY OF QUANTITIES

SCALE: N.T.S. SHEET NO. OF SHEETS STA. TO STA.

F.A.U. RTE.	SECTION	COUNTY	TOTAL SHEETS	SHEET NO.
0005	06-00057-00-BR	McHENRY	22	3
FED. ROAD DIST. NO. 1 ILLINOIS FED. AID PROJECT			CONTRACT NO. 63508	

EROSION CONTROL NOTES

- THE CONTRACTOR WILL BE REQUIRED TO IMPLEMENT AND MAINTAIN EROSION CONTROL MEASURES IMMEDIATELY AFTER STRIPPING OF EXISTING VEGETATION.
- THE QUANTITIES SHOWN FOR TEMPORARY DITCH CHECKS ARE MEASURED PER FOOT, HAY OR STRAW BALES ARE NOT TO BE USED.
- STOCKPILES OF SOIL AND OTHER BUILDING MATERIALS TO REMAIN IN PLACE MORE THAN SEVEN (7) DAYS SHALL BE FURNISHED WITH EROSION AND SEDIMENT CONTROL MEASURES (I.E. PERIMETER SILT FENCE). STOCKPILES TO REMAIN IN PLACE FOR 14 DAYS OR MORE SHALL RECEIVE TEMPORARY SEEDING.
- THE CONTRACTOR SHALL TAKE ALL PRECAUTIONS TO PREVENT POLLUTION OF STORM WATER AND SHALL FOLLOW IEPA & IDOT CONSTRUCTION MEMORANDUM NO. 95-60.
- STABILIZATION MEASURES SHALL BE INITIATED WITHIN 7 DAYS OF CONSTRUCTION ACTIVITY TEMPORARILY OR PERMANENTLY CEASING IN AREAS WHERE IT WILL NOT OCCUR FOR A PERIOD OF 14 OR MORE CALENDAR DAYS.
- THE CONTRACTOR SHALL APPLY TEMPORARY EROSION CONTROL SEEDING TO ALL ERODIBLE BARE EARTH AREAS WITHIN THE CONTRACT LIMITS EACH WEEK, REGARDLESS OF WEATHER CONDITIONS OR PROGRESS OF THE WORK, UNLESS OTHERWISE DIRECTED BY THE ENGINEER. ERODIBLE EMBANKMENT AND EXCAVATION AREAS WHERE WORK IS IN PROGRESS SHALL BE INCLUDED ON THE AREAS TO BE SEED. SEE BDE SPECIAL PROVISION FOR TEMPORARY EROSION CONTROL.
- THE CONTRACTOR WILL BE RESPONSIBLE FOR CONDUCTING REGULAR SITE INSPECTIONS TO VERIFY THAT THE BEST MANAGEMENT PRACTICES (BMP'S) ARE FUNCTIONING PROPERLY AND DETERMINE IF ADDITIONAL PRACTICES ARE NEEDED TO MAINTAIN PERMIT COMPLIANCE. MCHENRY WILL MONITOR THE PROJECT FOR PERMIT COMPLIANCE.
- THE MCHENRY SOIL AND WATER CONSERVATION DISTRICT MUST BE NOTIFIED ONE WEEK PRIOR TO THE PRE-CONSTRUCTION CONFERENCE, ONE WEEK PRIOR TO THE COMMENCEMENT OF LAND DISTURBING ACTIVITIES, AND ONE WEEK PRIOR TO FINAL INSPECTION.
- LOW GROUND-PRESSURE EQUIPMENT WILL BE USED FOR ALL WORK WITHIN WETLANDS.
- THE SOIL EROSION AND SEDIMENT CONTROL PRACTICES WILL BE INSPECTED WEEKLY AND AFTER 1/2 INCH OF RAIN OR MORE BY THE INDIVIDUAL ON SITE IN CHARGE OF SOIL EROSION AND SEDIMENT CONTROL DURING THE CONSTRUCTION OF THE PROJECT. THE ENGINEER WILL BE RESPONSIBLE FOR THE EROSION AND SEDIMENT CONTROL INSPECTIONS.
- EROSION CONTROL BLANKET SHALL BE INSTALLED TO ALL DISTURBED AREAS WITH SLOPES EQUAL TO OR GREATER THAN 5H:1V AND IN CRITICAL AREAS (I.E. DETENTION BASIN PERIMETERS, STREAMBANKS, BERMS, ETC.) IMMEDIATELY UPON FINAL GRADING.
- SILT FENCE SHALL BE INSTALLED FOLLOWING THE COMPLETION AND STABILIZATION OF THE STORMWATER FACILITIES AND WILL REMAIN IN PLACE UNTIL THE CONTRIBUTING AREA IS STABILIZED.
- ALL ADJACENT STREETS AND DRIVEWAYS MUST BE KEPT CLEAR OF DEBRIS. INSPECTED DAILY AND CLEANED WHEN NECESSARY OR DIRECTED BY THE ENGINEER.
- ALL SOIL EROSION AND SEDIMENT CONTROL PRACTICES ARE REFERENCED FROM THE ILLINOIS URBAN MANUAL.
- ALL MATERIALS USED FOR TEMPORARY CONSTRUCTION ACTIVITIES WILL BE REMOVED TO UPLAND AREAS IMMEDIATELY FOLLOWING COMPLETION OF THE CONSTRUCTION ACTIVITY.
- A STAMPED AND SIGNED COPY OF THE APPROVED SOIL EROSION AND SEDIMENT CONTROL PLAN SHALL BE MAINTAINED ON THE SITE AT ALL TIMES AND BE PRESENTED WHEN REQUESTED BY MCHENRY SWCD, U.S. ARMY CORP OF ENGINEERS OR ANY OTHER AUTHORIZED AGENCY.
- SEEDING MIXTURE SHALL BE CLASS TYPE 2A & 4 AS DETAILED IN SECTION 250 OF THE STANDARD SPECIFICATIONS. PLANTING TIMES ARE LIMITED TO EARLY SPRING TO JUNE 1 AND AUGUST 1 TO SEPTEMBER 1.
- THE CONTRACTOR WILL BE REQUIRED TO HAVE A DESIGNATED CONCRETE WASH OUT AREA DURING ALL CONCRETE POURS.
- THE MCHENRY COUNTY SOIL AND WATER CONSERVATION DISTRICT AND THE ARMY CORPS OF ENGINEERS MUST BE IN AGREEMENT WITH METHOD OF DIVERSION/ISOLATION PRIOR TO THE COMMENCEMENT OF CONSTRUCTION. ONCE WORK IN THIS AREA BEGINS, PRIORITY SHALL BE GIVEN TO THE COMPLETION OF THE WORK AND FINAL STABILIZATION OF ALL DISTURBED AREAS.
- IF BYPASS PUMPING IS NECESSARY, THE OUTLET SHALL BE PLACED ON A NON-ERODIBLE, ENERGY DISSIPATING SURFACE PRIOR TO REJOINING THE STREAM FLOW.
- WHEN DEWATERING THE CONSTRUCTION AREA, ALL WATER MUST BE FILTERED PRIOR TO REJOINING THE STREAM FLOW. DEWATERING METHODS SHALL BE CHOSEN BASED ON SITE CONDITIONS, CONSTRAINTS AND SEDIMENT LOADS.
- THE SIDE SLOPES MUST BE RESEED AND STABILIZED WITH AN APPROPRIATE EROSION CONTROL BLANKET PRIOR TO ACCEPTING FLOWS.
- ALL EROSION CONTROL MEASURES SHALL CONFORM WITH THE CITY OF HARVARD DETAILS.
- A STABILIZED MAT OF AGGREGATE UNDERLAIN WITH FILTER FABRIC CLOTH (OR OTHER APPROPRIATE MEASURES) SHALL BE LOCATED AT ANY POINT WHERE TRAFFIC WILL BE ENTERING OR LEAVING A CONSTRUCTION -SITE OF A MAJOR DEVELOPMENT TO OR FROM A PUBLIC RIGHT-OF-WAY, STREET, ALLEY, OR PARKING AREA. ANY SEDIMENT OR SOIL REACHING AN IMPROVED PUBLIC RIGHT-OF-WAY, STREET, ALLEY, OR PARKING AREA SHALL BE REMOVED BY SCRAPING OR STREET CLEANING AS ACCUMULATIONS WARRANT AND TRANSPORTED TO A CONTROLLED SEDIMENT DISPOSAL AREA. THIS WORK SHALL BE INCIDENTAL TO THE CONTRACT.
- SOIL STOCKPILES SHALL NOT BE LOCATED WITHIN THE FLOODPLAIN OR WATERS OF THE UNITED STATES OR ISOLATED WATERS OF MCHENRY COUNTY.
- THE CONTRACTOR SHALL PROVIDE ADEQUATE RECEPTACLES FOR THE DEPOSITION OF ALL CONSTRUCTION MATERIAL DEBRIS GENERATED DURING THE DEVELOPMENT PROCESS. THE CONTRACTOR SHALL NOT CAUSE OR PERMIT THE DUMPING, DEPOSITING, DROPPING, THROWING, DISCARDING, OR LEAVING OF CONSTRUCTION MATERIAL DEBRIS UPON OR INTO ANY DEVELOPMENT SITE, CHANNEL, WATERS OF THE U. S. OR ISOLATED WATERS OF MCHENRY COUNTY. THE CONTRACTOR SHALL MAINTAIN THE DEVELOPMENT SITE FREE OF CONSTRUCTION DEBRIS.

LEGEND

- PERIMETER EROSION BARRIER
- EXISTING R.O.W.
- DIRECTION OF FLOW
- EROSION CONTROL BLANKET, TEMPORARY EROSION CONTROL SEEDING, TOP SOIL 4", SEEDING CLASS 2A
- EROSION CONTROL BLANKET, TEMPORARY EROSION CONTROL SEEDING, TOP SOIL 4", SEEDING CLASS 4
- TEMPORARY DITCH CHECK
- PERMANENT WETLAND IMPACT AREA
- TEMPORARY FENCE

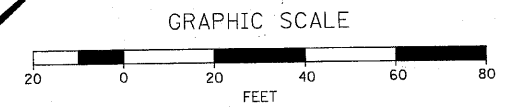
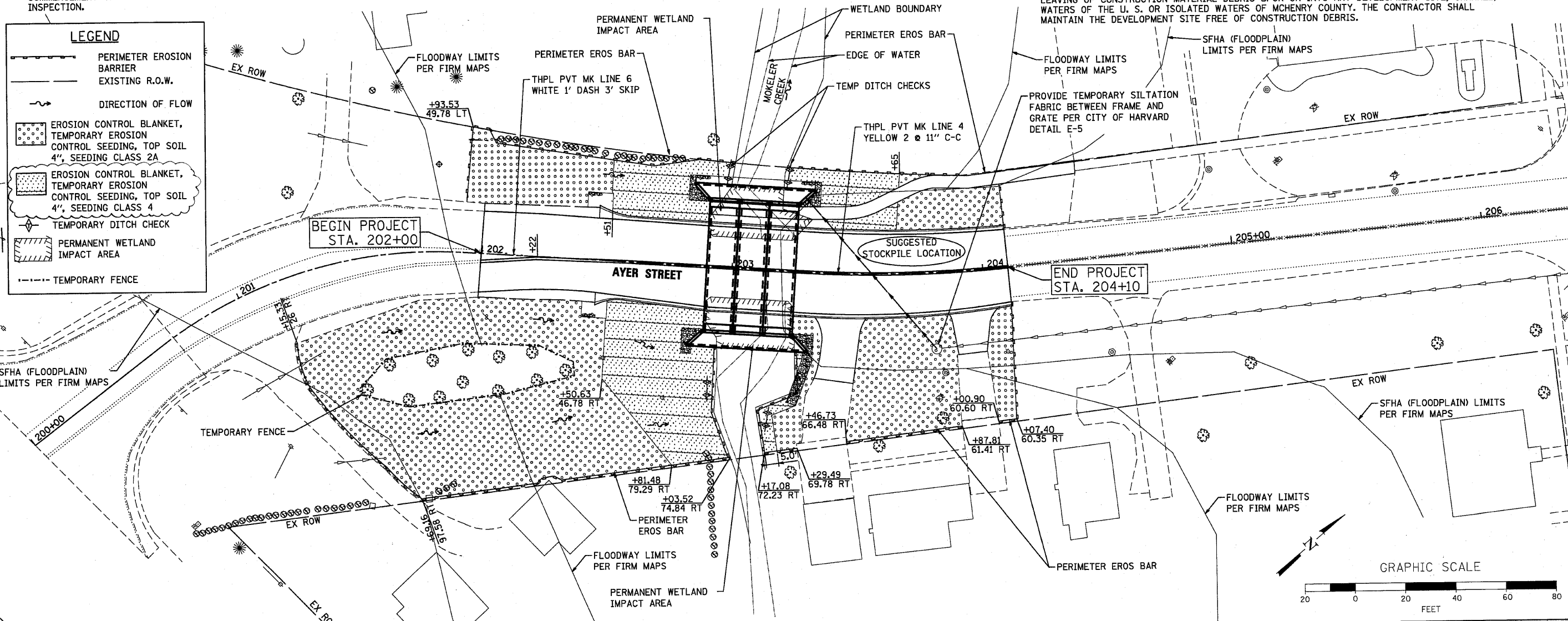

COMPANY NAME: SEC Group, Inc.
PROJECT CONTACT: Robert G. Davies
CLIENT: Village of Harvard
DATE PLOTTED: 10/6/2010 10:26:24 AM
FILE NAME: 080594-plan-pm-erose-resto.rvt
PLOT DRIVER: pdrc11
PEN TABLE: STANDARD-TRANS.TBL

<p>SEC Group, Inc. 14111 Green Company 620 N. First Street Harvard, IL 60031-1002 L 815.365.1778 E 815.365.1781 www.secgroup.com</p>	USER NAME = JGuerri	DESIGNED - JPH	REVISED - 10/06/10
	FILE NAME = 080594-plan-pm-erose-resto	DRAWN - WJH	REVISED -
	PLOT SCALE = 1"=20'	CHECKED - RGD	REVISED -
	PLOT DATE = 10/6/2010	DATE = 10/6/10	REVISED -

STATE OF ILLINOIS
DEPARTMENT OF TRANSPORTATION

AYER STREET OVER MOKELER CREEK
PAVEMENT MARKING, EROSION CONTROL, AND RESTORATION PLAN

SCALE: 1"=20' SHEET NO. OF SHEETS STA. TO STA.

F.A.J. RTE.	SECTION	COUNTY	TOTAL SHEETS	SHEET NO.
0005	06-00057-00-BR	MCHENRY	22	11
FED. ROAD DIST. NO. 1 [ILLINOIS] FED. AID PROJECT				
CONTRACT NO. 63508				