

NOTES:

1. THE CITY OF WEST CHICAGO WILL PROVIDE AND ERECT FIVE WORK ZONE SPEED LIMIT (25 MPH) SIGN ASSEMBLIES.
2. SEE DISTRICT 1 DETAILS AND IDOT STATEWIDE STANDARDS FOR ADDITIONAL INFORMATION ON SIGN PLACEMENT AND SPACING.

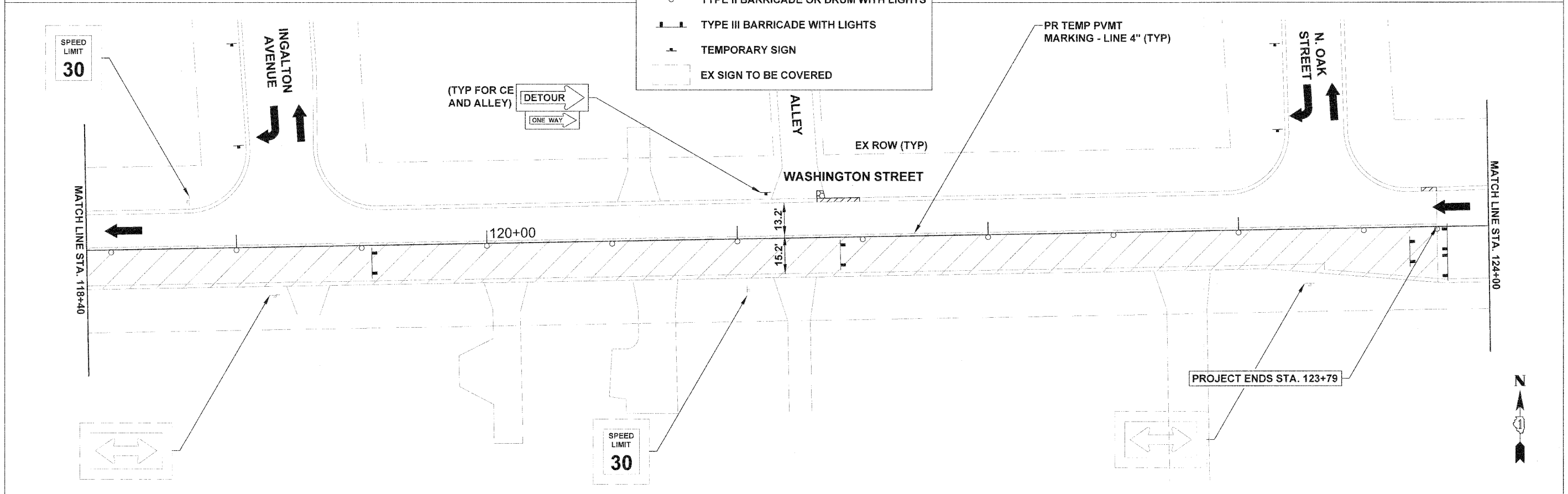
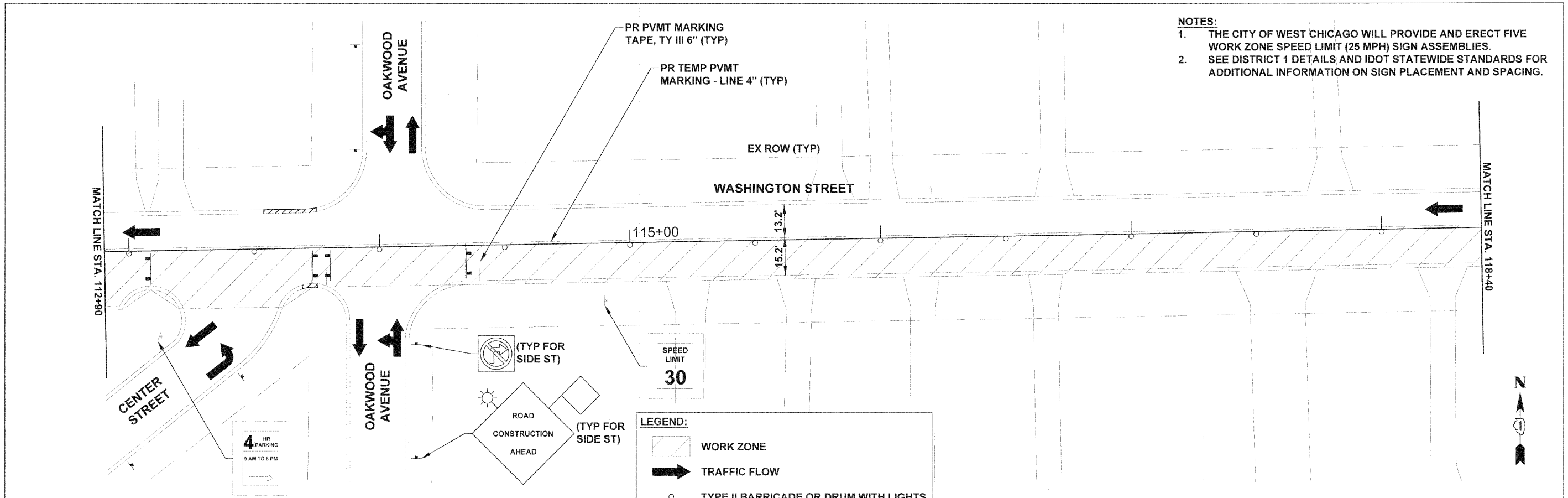

FILE NAME = 24-48_MOT Detour and Plan Sheets_Washington PLOT DATE = 8/2/10	thomas engineering group, llc 238 south kenilworth avenue suite 100 oak park, il 60392 phone: 708-533-1700	DESIGNED - BLP	REVISED -	STATE OF ILLINOIS DEPARTMENT OF TRANSPORTATION	WASHINGTON STREET - IL RTE 38 TO IL RTE 59 MAINTENANCE OF TRAFFIC PLAN SHEET - STAGE 1	FAU R/E	SECTION	COUNTY	TOTAL SHEETS	SHEET NO.		
		DRAWN - BLP	REVISED -			1397	09-00076-00-RP	DUPAGE	61	36		
CHECKED - KCV	REVISED -	SCALE: 1" = 20'				STA. 112+50 TO STA. 124+00		CONTRACT NO. 63513				
DATE - 08/02/10	REVISED -	FED. ROAD DIST. NO. 1				ILLINOIS		FED. AID PROJECT M-8003(707)				