

NOTES:

1. THE CITY OF WEST CHICAGO WILL PROVIDE AND ERECT FIVE WORK ZONE SPEED LIMIT (25 MPH) SIGN ASSEMBLIES.
2. SEE DISTRICT 1 DETAILS AND IDOT STATEWIDE STANDARDS FOR ADDITIONAL INFORMATION ON SIGN PLACEMENT AND SPACING.

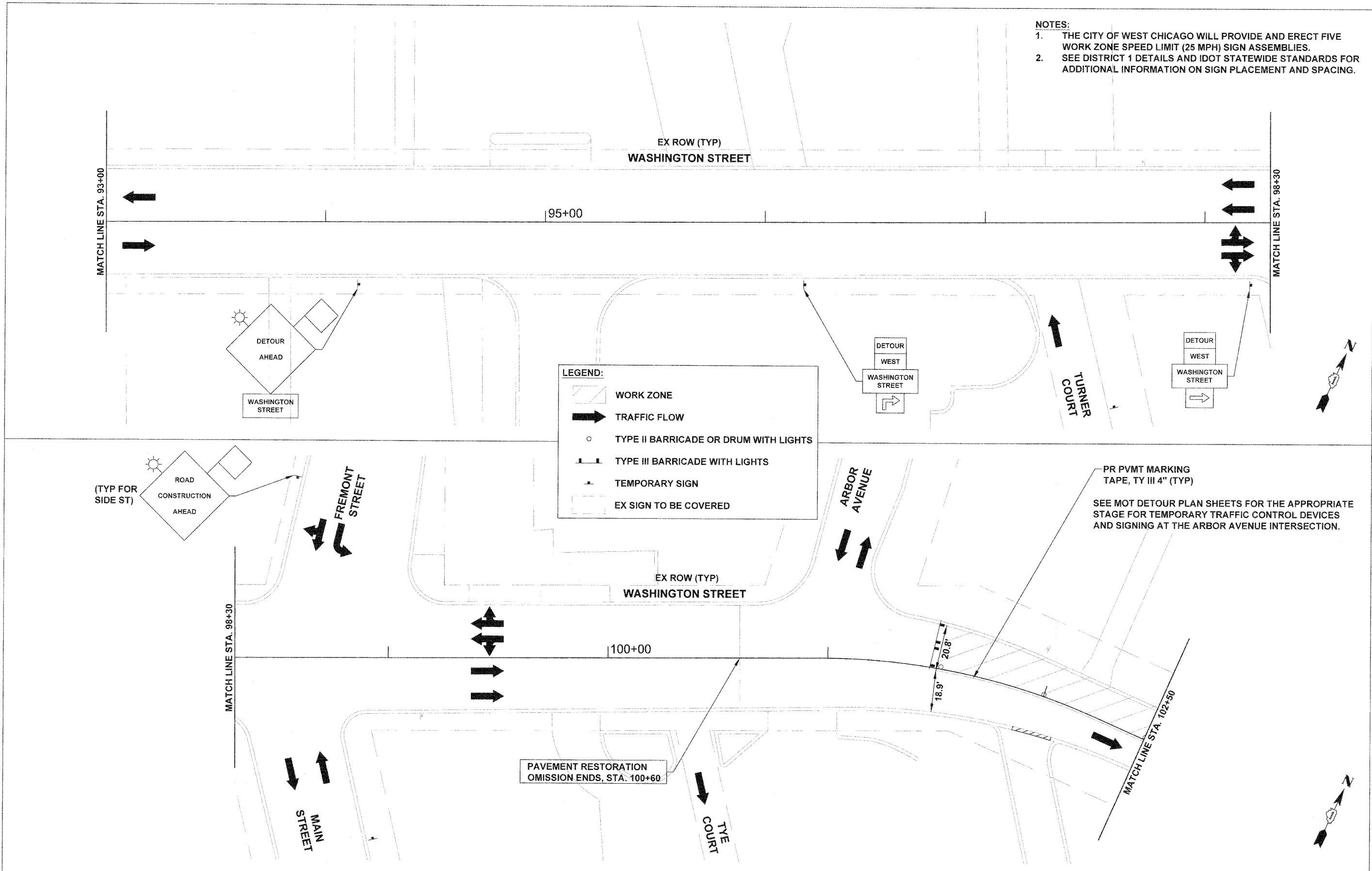

FILE NAME = 24-49_MOT Detour and Plan Sheets_Washington
 PLOT DATE = 8/2/10

thomas
 engineering group
 thomas engineering group, llc
 238 south kenilworth avenue
 suite 100
 oak park, il 60302
 phone: 708-533-1700

| | | | |
|------------|----------|-----------|--|
| DESIGNED - | BLP | REVISED - | |
| DRAWN - | BLP | REVISED - | |
| CHECKED - | KCV | REVISED - | |
| DATE - | 08/02/10 | REVISED - | |

STATE OF ILLINOIS
 DEPARTMENT OF TRANSPORTATION

WASHINGTON STREET - IL RTE 38 TO IL RTE 59
 MAINTENANCE OF TRAFFIC PLAN SHEET - STAGE 2
 SCALE: 1" = 20'
 STA. 93+00 TO STA. 102+50

| | | | | |
|-----------------------------------------------------------------|----------------|--------|--------------|-----------|
| F.A.U. RTE. | SECTION | COUNTY | TOTAL SHEETS | SHEET NO. |
| 1397 | 08-00076-00-RP | DUPAGE | 61 | 46 |
| CONTRACT NO. 63513 | | | | |
| FED. ROAD DIST. NO. 1 ILLINOIS FED. AID PROJECT M-9003(707) | | | | |