

PROPOSED CONCRETE PAVEMENT FULL DEPTH REPAIR  
TYPICAL ROADWAY PLAN (PAID AS CLASS B PATCH)

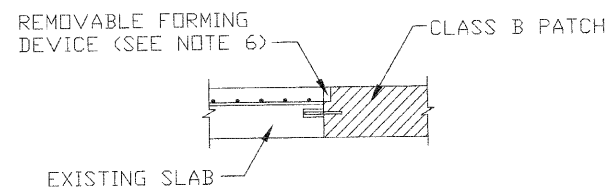

DETAIL A  
TYPICAL PREPARED TRANSVERSE JOINT

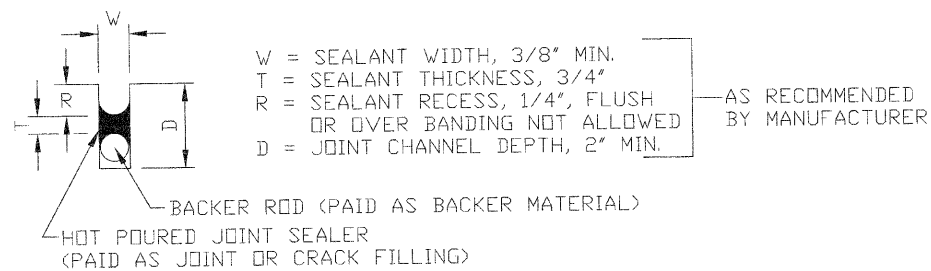

DETAIL B  
TYPICAL SEALANT RESERVOIR

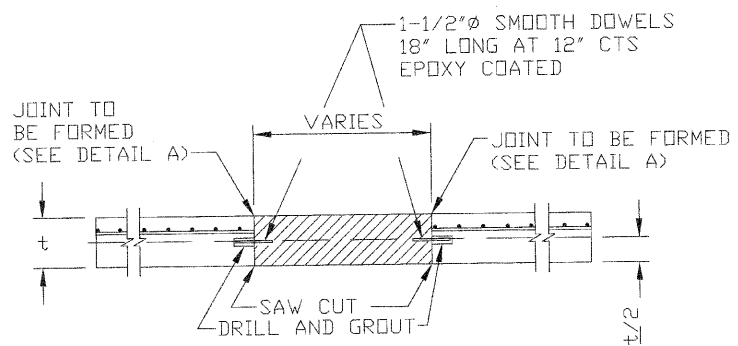

SECTION A-A  
REPAIR THROUGH TRANSVERSE JOINTS OR CRACKS

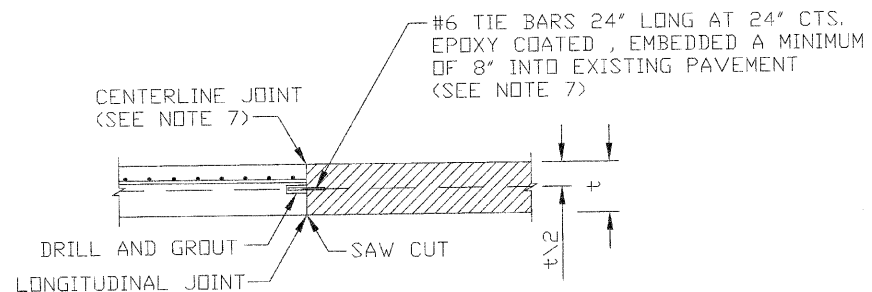

SECTION B-B  
LONGITUDINAL CONSTRUCTION JOINT  
(TIE BAR GROUTED IN PLACE)

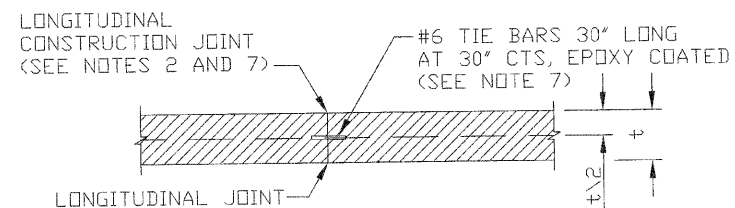

SECTION C-C  
REPAIR THROUGH LONGITUDINAL JOINT

GENERAL NOTES:

- REPAIRS TERMINATING AT TRANSVERSE EXPANSION JOINTS SHALL BE EXTENDED TWO FEET (MINIMUM) ACROSS THE JOINT. WHEN A REPAIR EXTENDS ACROSS AN EXISTING JOINT THE MINIMUM DIMENSION ON EITHER SIDE OF THE JOINT SHALL BE TWO FEET.
- WHENEVER THE REPAIR IS CONSTRUCTED IN TWO OR MORE SEGMENTS BECAUSE OF MAINTENANCE OF TRAFFIC STAGING REQUIREMENTS, EACH SEGMENT SHALL BE CONSIDERED A SEPARATE PATCH.
- DRILLED AND GROUTED DOWEL BARS SHALL BE EMBEDDED 1/2 THEIR LENGTH INTO THE EXISTING CONCRETE USING AN EPOXY GROUT AS SPECIFIED.
- ALL TRANSVERSE CONTRACTION AND LONGITUDINAL JOINTS IN THE REPAIR AREA SHALL BE SAWED AND SEALED PER IDOT STANDARD 420001 (SEE SPECIAL PROVISIONS).
- FOR FULL DEPTH REPAIRS, P.C.C. PAVEMENT SHALL BE SAW CUT FULL DEPTH (SEE SPECIAL PROVISIONS).
- REMOVABLE FORMING DEVICE (TEMPORARY JOINT FILLER) SHALL BE INSTALLED IN ACCORDANCE WITH THE SPECIAL PROVISIONS TO PROVIDE A SEALANT RESERVOIR AS SHOWN IN DETAIL B AT ALL TRANSVERSE JOINTS BETWEEN NEW AND EXISTING PAVEMENT.
- WHEN PATH LENGTH OR EDGE OF REPAIR LENGTH IS 20' OR LESS, TIE BARS CAN BE OMITTED. IF TIE BARS ARE OMITTED, THEN FIBERBOARD BOND BREAKER OR EQUIVALENT SHALL BE USED. WHEN PATCH LENGTH IS MORE THAN 20', TIE BARS SHALL BE USED.
- TYPICAL ROADWAY PLAN FOR FULL DEPTH REPAIR IS APPLICABLE TO ALL PAVEMENTS, LANE WIDTHS AND NUMBER OF EXISTING LANES.

LEGEND

- EXISTING WELDED WIRE FABRIC
- EXISTING PAVEMENT
- PROPOSED CONCRETE PAVEMENT REPAIR - FULL DEPTH
- t = CONCRETE PAVEMENT THICKNESS

FILE NAME = 50-52\_Construction Details\_Washington  
PLOT DATE = 8/2/10

**thomas** engineering group, llc  
238 south kenilworth avenue  
suite 100  
oak park, il 60302  
phone: 708-633-1700

DESIGNED - KCV  
DRAWN - KCV  
CHECKED - DMM  
DATE - 08/02/10

REVISED -  
REVISED -  
REVISED -  
REVISED -

STATE OF ILLINOIS  
DEPARTMENT OF TRANSPORTATION

WASHINGTON STREET - IL RTE 38 TO IL RTE 59  
CONSTRUCTION DETAILS

SCALE: N.T.S.

F.A.U. RTE. 1387	SECTION 09-00076-00-RP	COUNTY DUPAGE	TOTAL SHEETS 61	SHEET NO. 52
CONTRACT NO. 63513				
FED. ROAD DIST. NO. 1   ILLINOIS   FED. AID PROJECT M-9003(707)				