

GENERAL NOTES

1. Reinforcement bars shall conform to the requirements of ASTM A 706 Gr 60. See Special Provisions.
2. Reinforcement bars designated (E) shall be epoxy coated.
3. Layout of the slope protection system may be varied to suit ground conditions in the field as directed by the engineer.
4. The embankment configuration shown shall be the minimum that must be placed and compacted prior to construction of the abutments.
5. The Contractor shall take extreme caution during all phases of construction to prevent the deposition of any material into the N. Branch of the Kishwaukee River. Demolition and construction activities within the floodplain shall be limited to the grading limits shown on the grading plans.
6. The contractor is advised that the existing structure contains member that are in deteriorated condition with reduced load carrying capacity. It is the contractor's responsibility to account for the condition of the existing structure when developing construction procedure for removal.
7. The Contractor shall obtain a construction permit from the Illinois Department of Natural Resources (IDNR), Office of Water Resources for any temporary construction activity placed in the water except cofferdams. This shall include the placement of material for run-arounds, causeways, etc. Any permit application by the Contractor shall refer to the IDNR 3704 Floodway Construction permit number allowing permanent construction as shown in the contract plans.
8. The Illinois Department of Transportation is not the owner of record for this bridge. Those seeking historic, as-built or other existing documents and plans must contact the owner of record to make arrangements for access to this information.

**McHENRY COUNTY
DIVISION OF TRANSPORTATION**

INDEX OF SHEETS

- S-1 General Plan and Elevation
- S-2 General Notes, Bill of Materials and Index of Sheets
- S-3 Top of Slab Elevations No. 1
- S-4 Top of Slab Elevations No. 2
- S-5 Top of West Approach Slab Elevations
- S-6 Top of East Approach Slab Elevations
- S-7 Superstructure Plan and Cross Section
- S-8 Superstructure Details
- S-9 Bridge Approach Slab Details 1
- S-10 Bridge Approach Slab Details 2
- S-11 Steel Railing Details
- S-12 Framing Plan
- S-13 48" PPC I-Beam Details 1
- S-14 48" PPC I-Beam Details 2
- S-15 West Abutment
- S-16 East Abutment
- S-17 Metal Shell Pile Details
- S-18 Bar Splicer Assembly and Mechanical Splicer Details
- S-19 Soil Borings 1
- S-20 Soil Borings 2
- S-21 Soil Borings 3

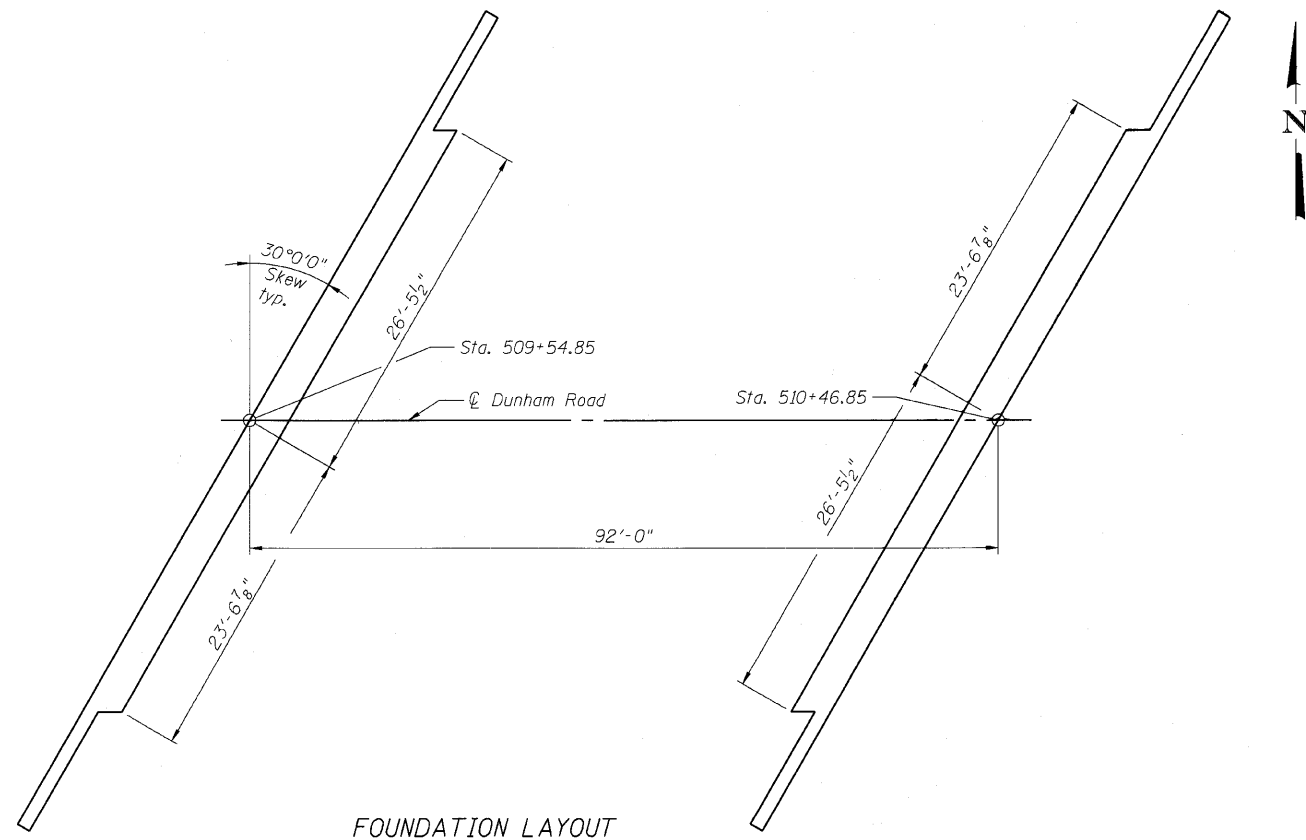

FOUNDATION LAYOUT

TOTAL BILL OF MATERIAL

DESCRIPTION	UNIT	ESTIMATED QUANTITY		
		SUPER	SUB	TOTAL
* Porous Granular Embankment, Special	Cu. Yd.		160	160
Stone Riprap, Class A4	Sq. Yd.		857	857
Filter Fabric	Sq. Yd.		857	857
Removal of Existing Structures	Each	0.5	0.5	1
Structure Excavation	Cu. Yd.		216	216
Concrete Structures	Cu. Yd.		73.3	73.3
Concrete Superstructure	Cu. Yd.	276.8		276.8
Bridge Deck Grooving	Sq. Yd.	642		642
Protective Coat	Sq. Yd.	743		743
Furnishing and Erecting Precast Prestressed Concrete I-Beams, 48"	Foot	631.5		631.5
Reinforcement Bars, Epoxy Coated	Pound	60,600	6,680	67,280
Bar Splicers	Each	88		88
* Steel Railing (Special)	Foot	231		231
Furnishing Metal Shell Piles 14" x 0.250"	Foot		1,079	1,079
Driving Piles	Foot		1,079	1,079
Test Pile Metal Shells	Each		2	2
Name Plates	Each	1		1
Geocomposite Wall Drain	Sq. Yd.		114	114
* Pipe Underdrains for Structures 4"	Foot		178	178

* Indicates Special Provision

**GENERAL NOTES, BILL OF MATERIAL
AND INDEX OF SHEETS
STRUCTURE NO. 056-3179**

DESIGNED - AMK
CHECKED - EKM
DRAWN - SAT
CHECKED - EKM



Ciorba Group, Inc.
CONSULTING ENGINEERS
5507 North Cumberland Avenue, Suite 402 Chicago, Illinois 60656
Tel. 773.775.4009 Fax 773.775.4014 Email chicago@ciorba.com

SHEET NO. S-2	F.A.S. RTE.	SECTION	COUNTY	TOTAL SHEETS	SHEET NO.
S-21 SHEETS	1233	06-00321-00-BR	McHENRY	48	20
			CONTRACT NO. 63516		
ILLINOIS FED. AID PROJECT					

8/2/2010
 rcdanley
 m:\proj\3381\3381_01_kish\design\structural\ced\3381_01_02 Notes and quantities.dgn