

| | | | | |
|---------------------|------------|--------------|--------------|-----------|
| F.A.P. RTE. | SECTION | COUNTY | TOTAL SHEETS | SHEET NO. |
| 301 | (1-1HB-1)D | WINNEBAGO | 55 | 1 |
| FED. ROAD DIST. NO. | ILLINOIS | CONTRACT NO. | 64E11 | |

STATE OF ILLINOIS
DEPARTMENT OF TRANSPORTATION
DIVISION OF HIGHWAYS

**PROPOSED
HIGHWAY PLANS**

WELDON ROAD OVER F.A.P. RTE. 301 (US 20)
SECTION (1-1HB-1)D
STRUCTURE REPAIR
WINNEBAGO COUNTY
PROJECT ACBHF-0301 (068)
C-92-142-10

D-92-060-08



INDEX OF SHEETS
SEE NEXT SHEET

IDOT HIGHWAY STANDARDS
SEE NEXT SHEET

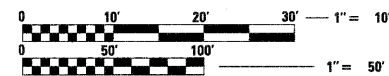

FULL SIZE PLANS HAVE BEEN PREPARED USING STANDARD ENGINEERING SCALES. REDUCED SIZED PLANS WILL NOT CONFORM TO STANDARD SCALES. IN MAKING MEASUREMENTS ON REDUCED PLANS, THE ABOVE SCALES MAY BE USED.

REPAIR EXISTING STRUCTURE
CARRYING WELDON ROAD OVER US 20
EXISTING S.N. 101-0120
STA. 399 + 98.12

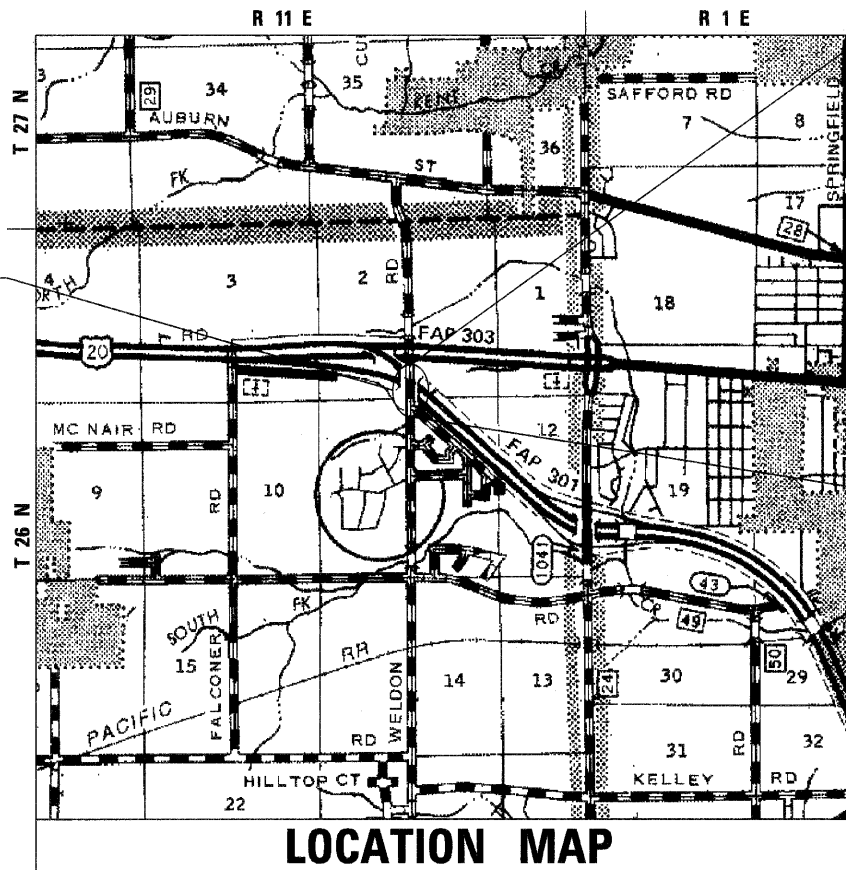

PROJECT ENDS
STA. 405 + 00.00

PROJECT BEGINS
STA. 395 + 88.00

ie CONSULTANTS, INC.
6420 SOUTH SIXTH STREET
SPRINGFIELD, ILLINOIS 62712
TEL. (217) 529-8027
FAX (217) 529-4543
WWW.IE-CONSULTANTS.COM

CALL **J.U.L.I.E.** (JOINT UTILITY LOCATION INFORMATION FOR EXCAVATORS)
48 Hours (2 working days) Before You Dig.
TOLL FREE: 1 (800) 892-0123 OR 811

PROJECT ENGINEER: AHMAD EL-AHMAD (815) 284-5944
PROJECT MANAGER: MASOOD AHMAD
WINNEBAGO TOWNSHIP, SECTION 2
CONTRACT NO. 64E11
WINNEBAGO COUNTY, SECTION: (1-1HB-1)D

APPROXIMATE SCALE: 0 1 2 MILES
GROSS LENGTH OF IMPROVEMENT = 912.80 FEET (0.173 MILES)
NET LENGTH OF IMPROVEMENT = 646.08 FEET (0.122 MILES)
CLASSIFICATION = LOCAL ROADS (RURAL)
CURRENT ADT: 1,575 (2014) PROJECTED ADT: 2,125 (2034)

STATE OF ILLINOIS
DEPARTMENT OF TRANSPORTATION
DIVISION OF HIGHWAYS

SUBMITTED 816 20 10
Mengya E. Ryan
DEPUTY DIRECTOR OF HIGHWAYS, REGION TWO ENGINEER

October 1 2010
Scott E. Stitt, P.E./a
acting ENGINEER OF DESIGN AND ENVIRONMENT

October 1 2010
Christine M. Reed/a
DIRECTOR OF HIGHWAYS, CHIEF ENGINEER

**PRINTED BY THE AUTHORITY
OF THE STATE OF ILLINOIS**



DAVID R. BOOHER ILLINOIS P.E. 062-043769
EXPIRES 11/30/2011

8-5-2010
DATE