

SECTION

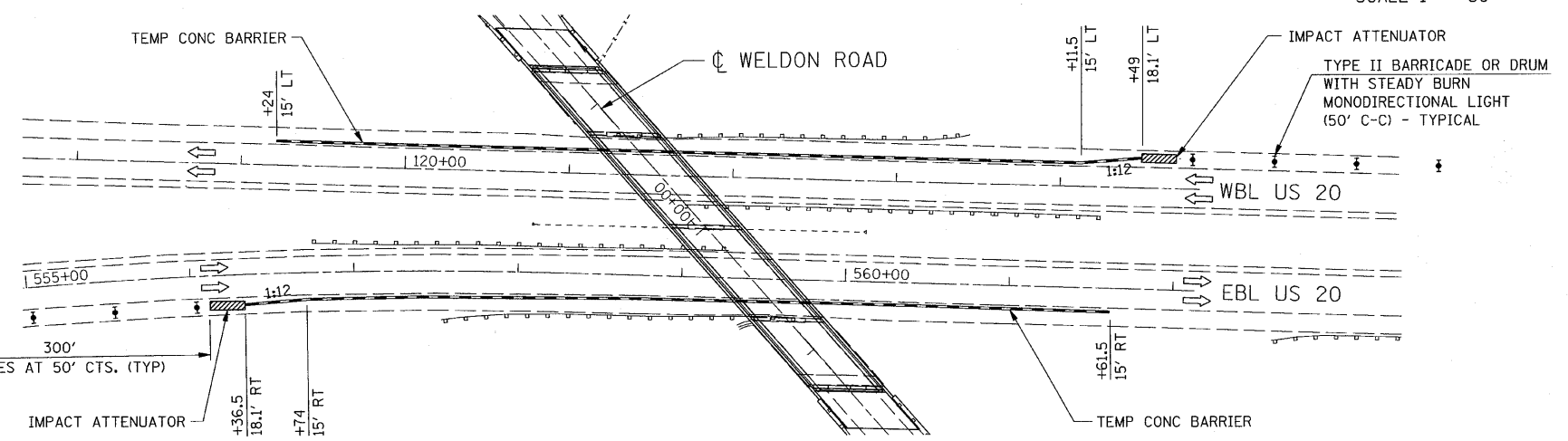
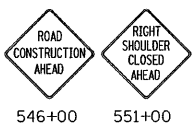

PLAN

STAGE 1

- NOTES:**
1. TRAFFIC CONTROL AND PROTECTION STAGES 1 & 2 SHALL BE ACCORDING TO STANDARD 701101 AND THESE PLAN DETAILS. SIGNING AND DEVICES FOR STAGES 1 & 2 WILL NOT BE PAID FOR SEPARATELY, BUT SHALL BE CONSIDERED AS INCLUDED IN THE COST OF THE CONTRACT.
 2. IF STAGE 1 WORK REQUIRES THE CONTRACTOR TO REMOVE EXISTING GUARDRAIL FOR ADDITIONAL WORKING SPACE, THE COST TO REMOVE AND RE-ERECT ALL GUARDRAIL ITEMS SHALL BE INCLUDED IN THE COST OF TEMPORARY CONCRETE BARRIER.
 3. USE TRAFFIC CONTROL AND PROTECTION STANDARD 701402 FOR PAINTING OPERATIONS.

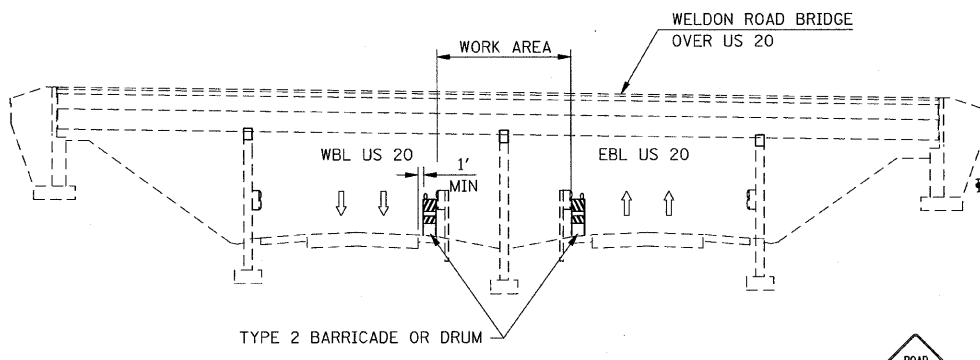

SECTION

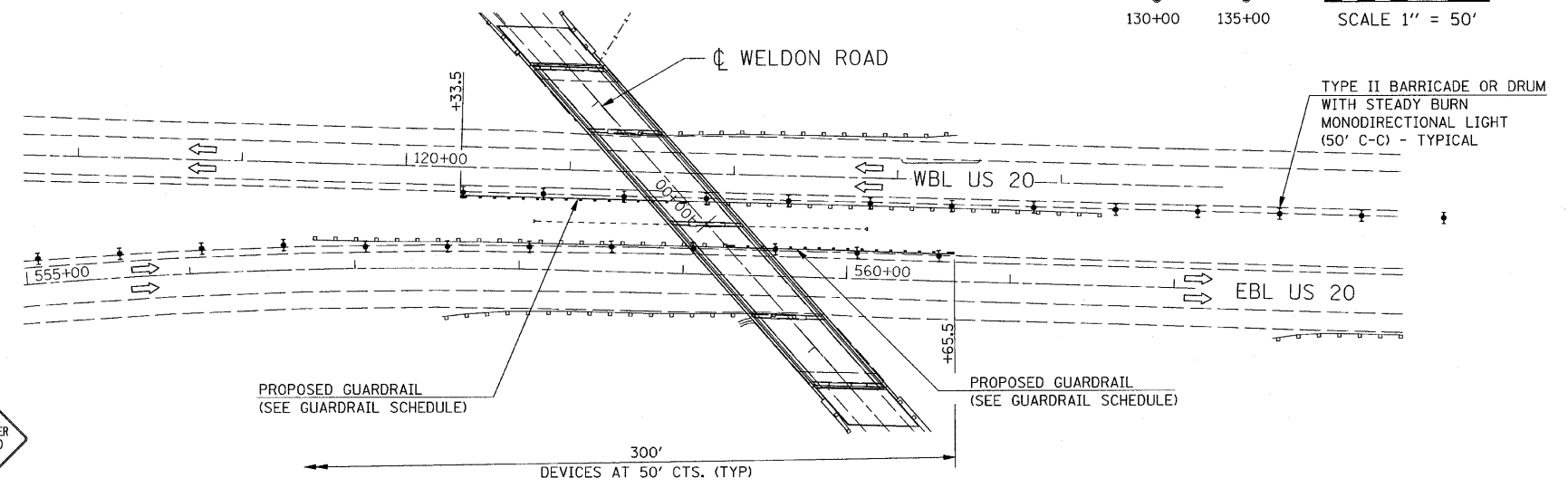
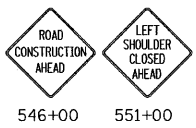

PLAN

STAGE 2

FILE NAME =	USER NAME = JE Consultants	DESIGNED -	REVISED -
G:\S09010-3\CADD Sheets\0264E11-aht-Stage01.dgn		DRAWN -	REVISED -
PLOT SCALE = 50.0000' / IN.		CHECKED -	REVISED -
PLOT DATE = 8/5/2010		DATE -	REVISED -

**STATE OF ILLINOIS
DEPARTMENT OF TRANSPORTATION**

TRAFFIC CONTROL AND PROTECTION

SCALE:	SHEET NO.	OF	SHEETS	STA.	TO STA.
--------	-----------	----	--------	------	---------

F.A.P. RTE.	SECTION	COUNTY	TOTAL SHEETS	SHEET NO.
301	3HBR	WINNEBAGO	55	13
CONTRACT NO. 64B87				
FED. ROAD DIST. NO. ILLINOIS FED. AID PROJECT				