

STATE OF ILLINOIS
DEPARTMENT OF TRANSPORTATION

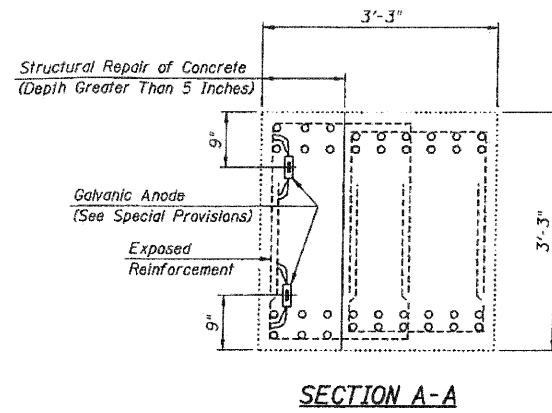

SECTION A-A

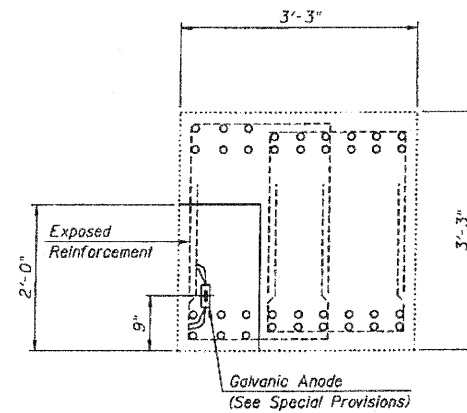

SECTION B-B

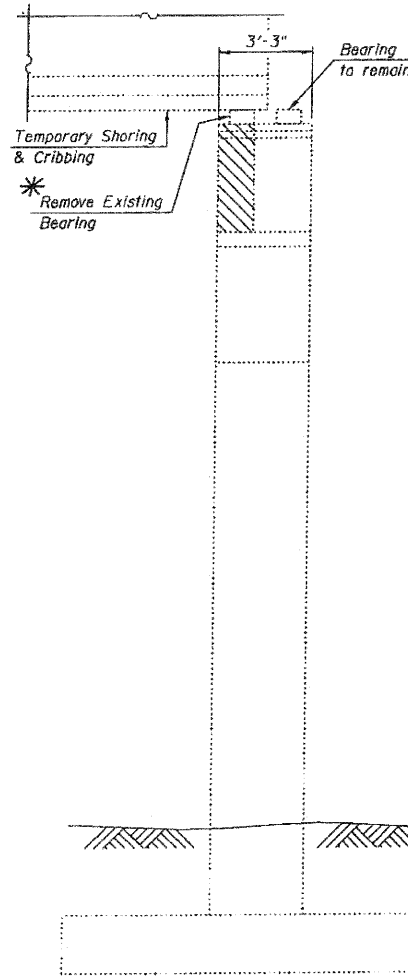

END VIEW
WEST FACE
(Looking East)

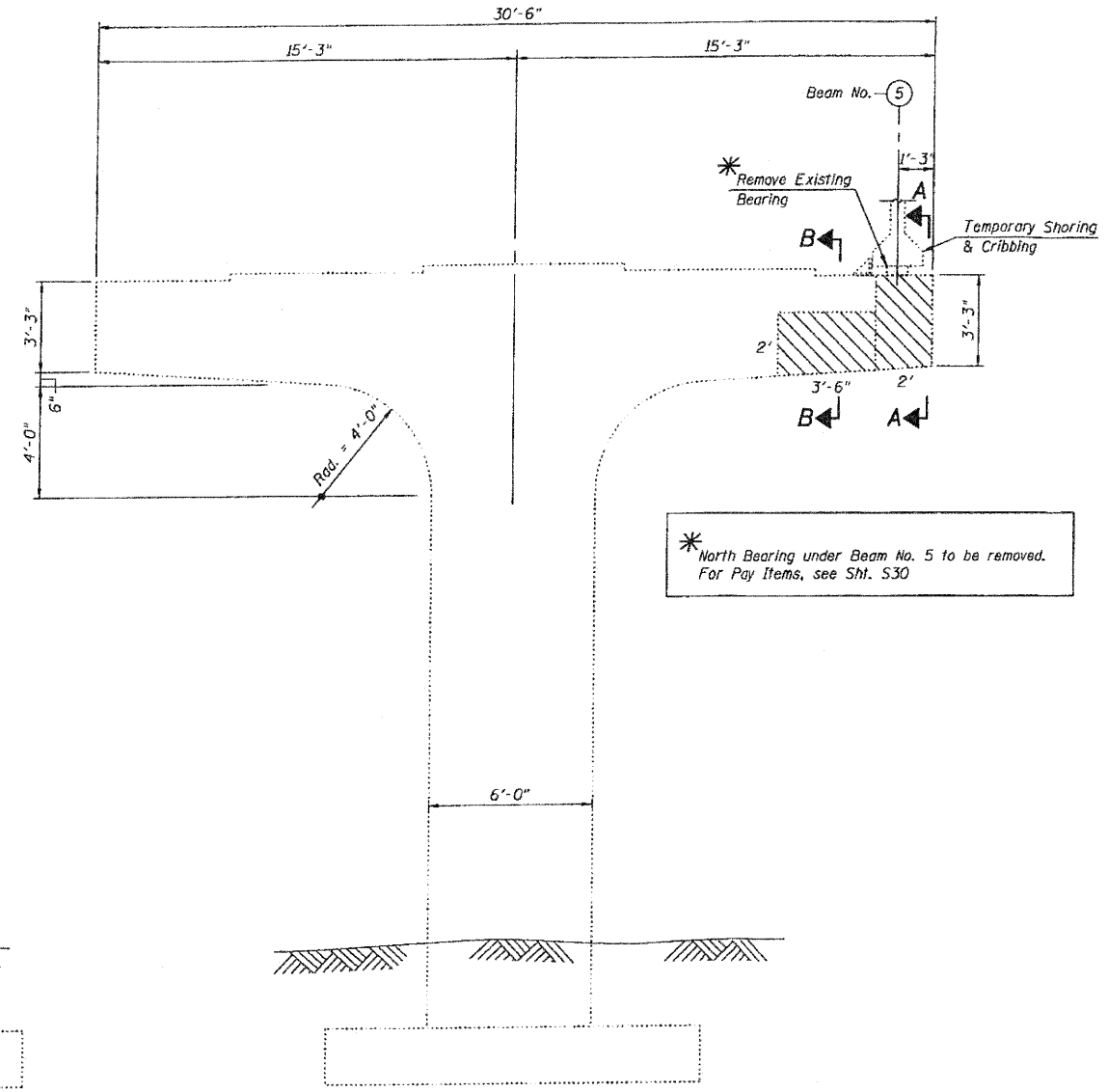

ELEVATION
NORTH FACE
(Looking South)

PIER #7

LEGEND:
 Structural Repair of Concrete (Depth Greater Than 5 Inches)

BILL OF MATERIAL

ITEM	UNIT	QUANTITY
Temporary Shoring and Cribbing	Each	1
Galvanic Anode	Each	3
Structural Repair of Concrete (Depth Greater Than 5 Inches)	Sq Ft	14

PIER #7 REPAIRS
 IL. RTE. 251 OVER IL. RTE. 38
 C&NW R.R. AND B.N. R.R.
 F.A.P. RTE. 740 (IL. RTE. 251)
 SECTION (108HVB)M
 OGLE COUNTY
 STA. 856+44.00
 STRUCTURE NO. 071-0066

DESIGNED -	2010
CHECKED -	EXAMINED
DRAWN -	ENGINEER OF BRIDGE DESIGN
CHECKED -	PASSED
	ENGINEER OF BRIDGES AND STRUCTURES

CHRISTIAN-ROGE & ASSOCIATES, INC.
 ENGINEERS-PLANNERS-SURVEYORS
 211 WEST WACKER DRIVE
 CHICAGO, ILLINOIS 60606
 PHONE: (312)372-2823 FAX: (312)372-5274

SHEET NO. S35	F.A.P. RTE. 740	SECTION (108HVB)M	COUNTY OGLE	TOTAL SHEETS 55	SHEET NO. 42
S43 SHEETS	CONTRACT NO. 64G24		ILLINOIS FED. AID PROJECT		