

DATE: 08/10
 BY: CHAMIN
 CHECKED: CHAMIN
 NO.:

DATE: 08/10
 BY: CHAMIN
 CHECKED: CHAMIN
 NO.:

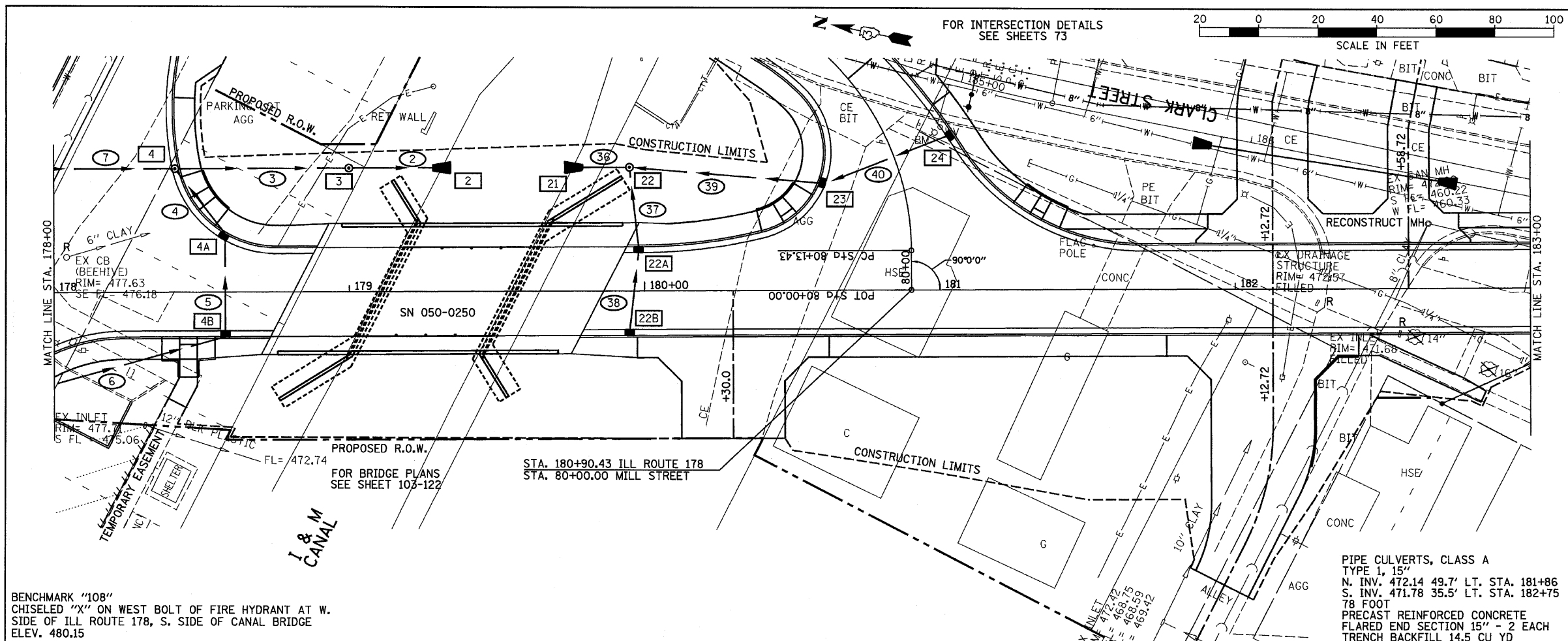

STRUCTURE NO.	2	3	4
STA	179+34.4	179+00.0	178+40.3
OFFSET	42.0 LT	42.0 LT	41.6 LT
STRUCTURE TYPE	PRCFES	MH-TA 5	MH-TA 5
F&G TYPE	--	1(C)	3
RIM ELEVATION	--	476.70	477.86
EAST INVERT	--	--	--
WEST INVERT	--	--	472.11
NORTH INVERT	--	466.85	467.14
SOUTH INVERT	465.60	466.85	467.14
PIPE NUMBER	2	3	4
SIZE	33"	33"	12"
LENGTH	34'	58'	28'
CLASS	A	A	A
TYPE	2	2	2
% SLOPE	3.68	0.50	8.25
TRENCH BACKFILL	--	20.6	17.7

STRUCTURE NO.	4A	4B	21
STA	178+58.0	178+58.0	179+73.2
OFFSET	17.5 LT	13.0 RT	42.0 LT
STRUCTURE TYPE	I-B*	I-B*	PRCFES
F&G TYPE	3	3	--
RIM ELEVATION	478.59	478.68	--
EAST INVERT	474.42	474.78	--
WEST INVERT	474.42	--	--
NORTH INVERT	--	474.78	465.60
SOUTH INVERT	--	--	--
PIPE NUMBER	5	6	7
SIZE	12"	12"	33"
LENGTH	35'	83'	55'
CLASS	A	A	A(RG)
TYPE	1	1	2
% SLOPE	1.03	0.94	0.45
TRENCH BACKFILL	5.3	10.8	87.3

STRUCTURE NO.	22	22A	22B
STA	179+95.0	179+98.0	179+95.0
OFFSET	42.0 LT	13.0 LT	13.0 RT
STRUCTURE TYPE	MH-TA 4	I-B*	I-A
F&G TYPE	1(C)	3	3
RIM ELEVATION	472.00	479.08	479.08
EAST INVERT	--	475.58	475.86
WEST INVERT	467.50	475.58	--
NORTH INVERT	465.82	--	--
SOUTH INVERT	467.50	--	--
PIPE NUMBER	36	37	38
SIZE	12"	12"	12"
LENGTH	22'	26'	28'
CLASS	A	A	A
TYPE	1	1	1
% SLOPE	1.00	31.08	1.00
TRENCH BACKFILL	--	3.0	2.4

STRUCTURE NO.	23	24	-
STA	80+45.7	80+45.7	--
OFFSET	24.9 LT	19.2 RT	--
STRUCTURE TYPE	I-B*	I-A	--
F&G TYPE	3	3	--
RIM ELEVATION	478.76	478.73	--
EAST INVERT	--	--	--
WEST INVERT	--	--	--
NORTH INVERT	475.11	475.47	--
SOUTH INVERT	475.11	475.47	--
PIPE NUMBER	39	40	-
SIZE	12"	12"	--
LENGTH	65'	36'	--
CLASS	A	A	--
TYPE	1	1	--
% SLOPE	11.71	1.00	--
TRENCH BACKFILL	3.2	3.5	--

BENCHMARK "108"
 CHISELED "X" ON WEST BOLT OF FIRE HYDRANT AT W.
 SIDE OF ILL ROUTE 178, S. SIDE OF CANAL BRIDGE
 ELEV. 480.15

PIPE CULVERTS, CLASS A
 TYPE 1, 15"
 N. INV. 472.14 49.7' LT. STA. 181+86
 S. INV. 471.78 35.5' LT. STA. 182+75
 78 FOOT
 PRECAST REINFORCED CONCRETE
 FLARED END SECTION 15" - 2 EACH
 TRENCH BACKFILL 14.5 CU YD

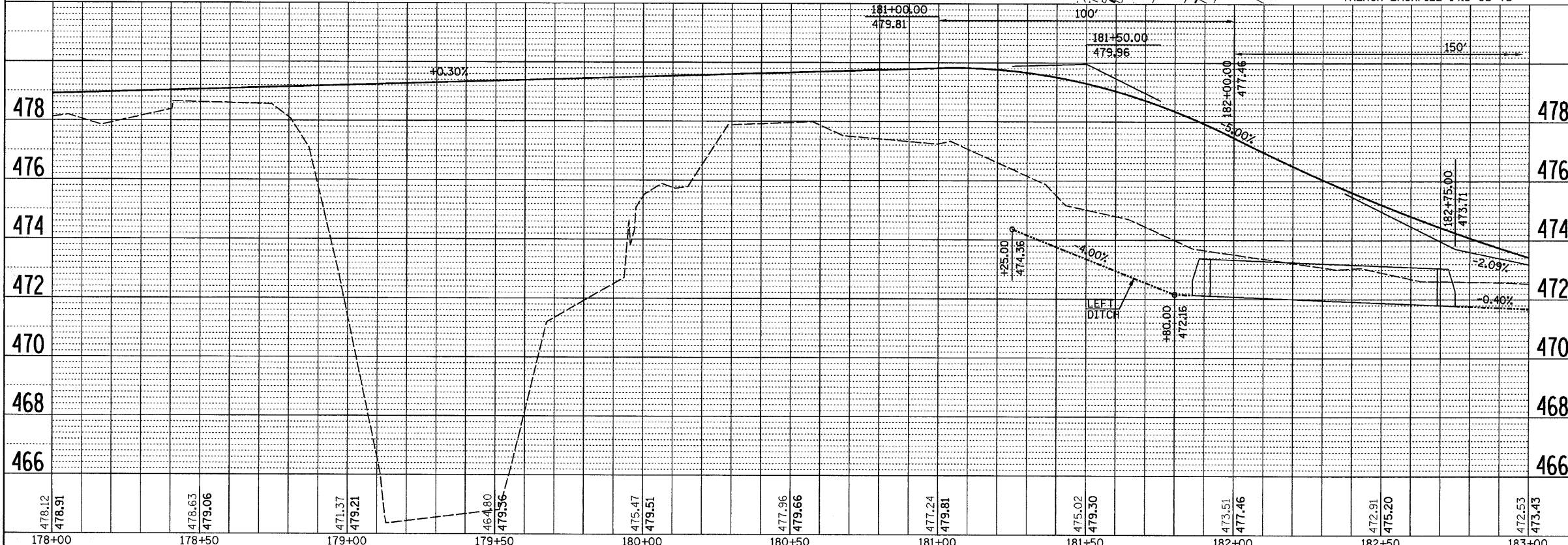

478.12	478.91	478.63	479.06	471.37	479.21	464.80	479.56	475.47	479.51	477.96	479.66	477.24	479.81	475.02	479.30	473.51	477.46	472.91	475.20	472.53	473.43
178+00	178+50	179+00	179+50	180+00	180+50	181+00	181+50	182+00	182+50	183+00											

FILE NAME =
 D366547-SHT-PLNPRF178-183.DGN

USER NAME = ---
 DESIGNED - JKC
 DRAWN - LAG
 CHECKED - JKC
 PLOT DATE = 08/10

REVISIONS:
 REVISIONS - ---
 REVISIONS - ---
 REVISIONS - ---

STATE OF ILLINOIS
 DEPARTMENT OF TRANSPORTATION

PLAN AND PROFILE - IL RTE 178 (RELOCATED)

SCALE: 1"=20'
 SHEET NO. ___ OF ___ SHEETS
 STA. 178+00 TO STA. 183+00

F.A.S. RTE.	SECTION	COUNTY	TOTAL SHEETS	SHEET NO.
1279	6R,B	LASALLE	190	24
CONTRACT NO. 66547				
FED. ROAD DIST. NO. - ILLINOIS FED. AID PROJECT				

*FLAT SLAB TOP REQUIRED