

OUTLET FOR COMBINATION  
CONCRETE CURB & GUTTER B-6.24  
(STD 606006)  
CLASS SI CONCRETE (OUTLET)  
3.9 CU YD

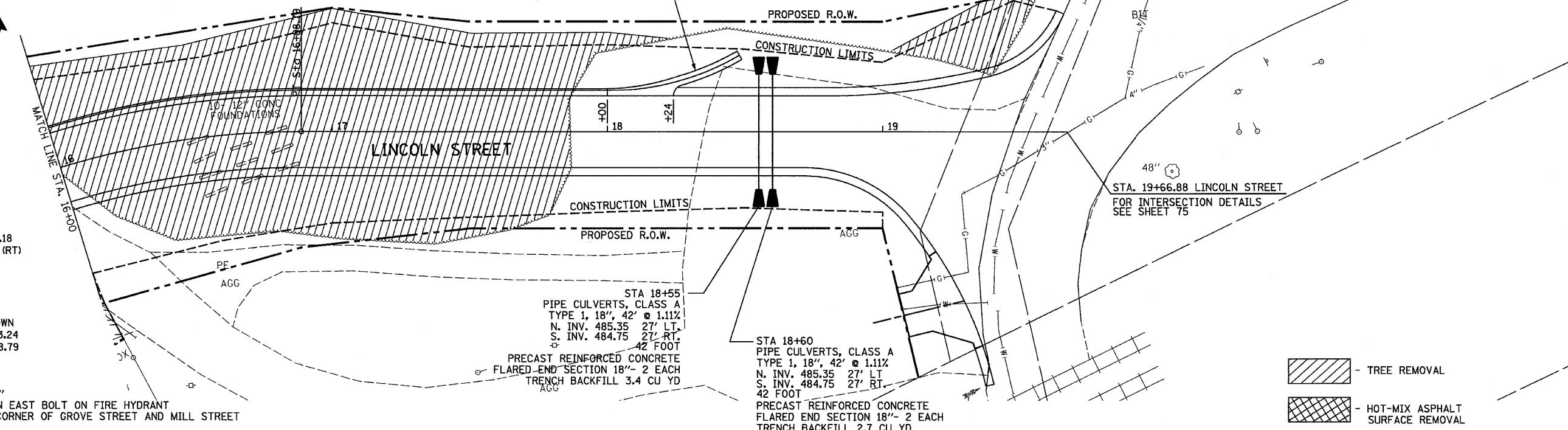

PROP. CURVE  
PI STA. = 16+08.18  
 $\Delta = 31^\circ 37' 04''$  (RT)  
D = 19° 05' 55"  
R = 300.00'  
T = 84.94'  
L = 165.55'  
E = 11.79'  
e = NORMAL CROWN  
P.C. STA = 15+23.24  
P.T. STA = 16+88.79

STA 18+55  
PIPE CULVERTS, CLASS A  
TYPE 1, 18", 42' @ 1.11%  
N. INV. 485.35 27' LT.  
S. INV. 484.75 27' RT.  
42 FOOT  
PRECAST REINFORCED CONCRETE  
FLARED END SECTION 18"- 2 EACH  
TRENCH BACKFILL 3.4 CU YD

STA 18+60  
PIPE CULVERTS, CLASS A  
TYPE 1, 18", 42' @ 1.11%  
N. INV. 485.35 27' LT.  
S. INV. 484.75 27' RT.  
42 FOOT  
PRECAST REINFORCED CONCRETE  
FLARED END SECTION 18"- 2 EACH  
TRENCH BACKFILL 2.7 CU YD

48"  
STA. 19+66.88 LINCOLN STREET  
FOR INTERSECTION DETAILS  
SEE SHEET 75

- TREE REMOVAL  
 - HOT-MIX ASPHALT SURFACE REMOVAL

BENCHMARK "100"  
CHISELED "X" ON EAST BOLT ON FIRE HYDRANT  
AT SOUTHWEST CORNER OF GROVE STREET AND MILL STREET  
ELEV. 482.49

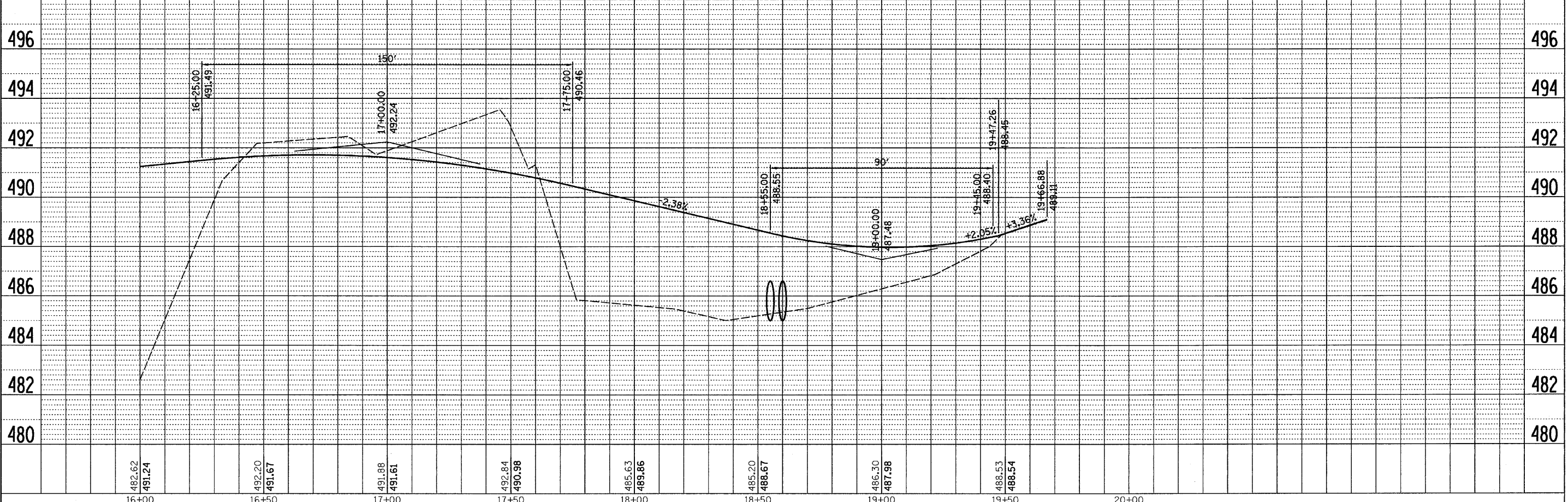

FILE NAME = D366547-SHT-PLNPRF16-22.DGN	USER NAME = ---	DESIGNED - JKC	REVISED - ---	<b>STATE OF ILLINOIS DEPARTMENT OF TRANSPORTATION</b>	<b>PLAN AND PROFILE - LINCOLN STREET</b>			F.A.S. RTE. 1279	SECTION 6R,B	COUNTY LASALLE	TOTAL SHEETS 190	SHEET NO. 28
	PLOT SCALE = 1"=20'	DRAWN - LAG	REVISED - ---		SCALE: 1"=20'	SHEET NO. ___ OF ___ SHEETS	STA. 16+00 TO STA. 19+66.88	CONTRACT NO. 66547				
	PLOT DATE = 08/10	CHECKED - JKC	REVISED - ---		FED. ROAD DIST. NO. _ [ILLINOIS] FED. AID PROJECT							
		DATE - 08/10	REVISED - ---									

DATE: 08/10  
BY: JKC  
CHECKED: LAG  
DATE: 08/10  
BY: JKC  
CHECKED: LAG  
DATE: 08/10  
BY: JKC  
CHECKED: LAG

DATE: 08/10  
BY: JKC  
CHECKED: LAG  
DATE: 08/10  
BY: JKC  
CHECKED: LAG  
DATE: 08/10  
BY: JKC  
CHECKED: LAG