

**TEMPORARY PAVEMENT WIDENING  
STA 164+61.30 TO STA 168+00**

(A) VARIES 10.55' AT STA. 164+61.3 TO 10.58' AT STA. 164+68.02  
10.58' STA. 164+68.02 TO STA. 166+95.20

CONTRACTOR SHALL STAGE HIS OPERATIONS TO PROVIDE ACCESS TO THE ENTRANCE AT ALL TIMES

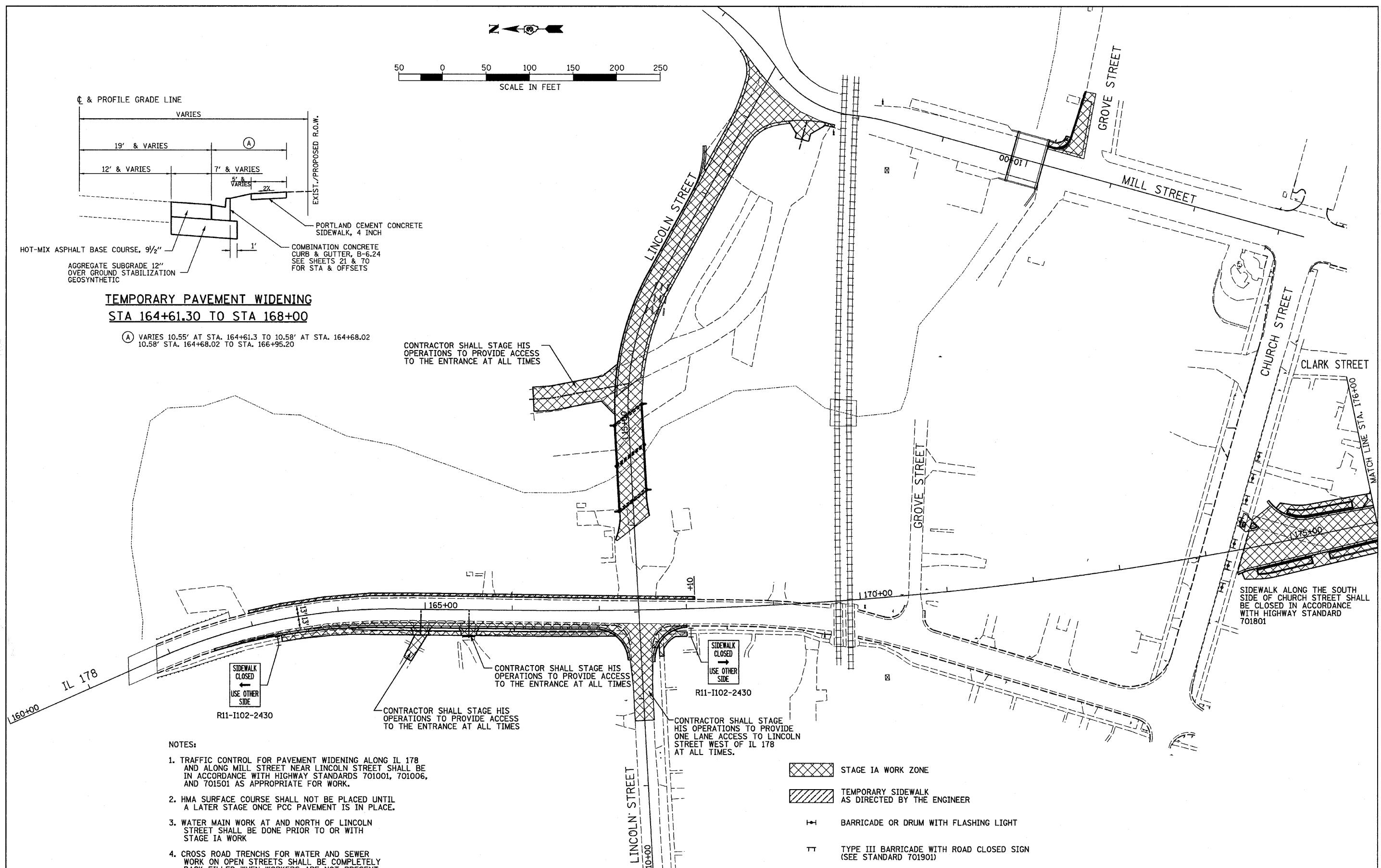

CONTRACTOR SHALL STAGE HIS OPERATIONS TO PROVIDE ACCESS TO THE ENTRANCE AT ALL TIMES

CONTRACTOR SHALL STAGE HIS OPERATIONS TO PROVIDE ONE LANE ACCESS TO LINCOLN STREET WEST OF IL 178 AT ALL TIMES.

SIDEWALK ALONG THE SOUTH SIDE OF CHURCH STREET SHALL BE CLOSED IN ACCORDANCE WITH HIGHWAY STANDARD 701801

**NOTES:**

1. TRAFFIC CONTROL FOR PAVEMENT WIDENING ALONG IL 178 AND ALONG MILL STREET NEAR LINCOLN STREET SHALL BE IN ACCORDANCE WITH HIGHWAY STANDARDS 701001, 701006, AND 701501 AS APPROPRIATE FOR WORK.
2. HMA SURFACE COURSE SHALL NOT BE PLACED UNTIL A LATER STAGE ONCE PCC PAVEMENT IS IN PLACE.
3. WATER MAIN WORK AT AND NORTH OF LINCOLN STREET SHALL BE DONE PRIOR TO OR WITH STAGE IA WORK
4. CROSS ROAD TRENCHES FOR WATER AND SEWER WORK ON OPEN STREETS SHALL BE COMPLETELY BACK FILLED WHEN WORKERS ARE NOT PRESENT.

- STAGE IA WORK ZONE
- TEMPORARY SIDEWALK AS DIRECTED BY THE ENGINEER
- BARRICADE OR DRUM WITH FLASHING LIGHT
- TYPE III BARRICADE WITH ROAD CLOSED SIGN (SEE STANDARD 701901)

FILE NAME = D366547-SHT-STAGEIA.DGN	USER NAME = ---	DESIGNED - JKC	REVISED - ---
		DRAWN - LAG	REVISED - ---
		CHECKED - JKC	REVISED - ---
		DATE - 08/10	REVISED - ---

DESIGNED - JKC	REVISED - ---
DRAWN - LAG	REVISED - ---
CHECKED - JKC	REVISED - ---
DATE - 08/10	REVISED - ---

**STATE OF ILLINOIS  
DEPARTMENT OF TRANSPORTATION**

**IL RTE 178 (RELOCATED)  
STAGE IA CONSTRUCTION AND TRAFFIC CONTROL PLANS**

SCALE: 1"=50' SHEET NO. \_\_\_ OF \_\_\_ SHEETS STA. 160+00 TO STA. 176+00

F.A.S. RTE. 1279	SECTION 6R,B	COUNTY LASALLE	TOTAL SHEETS 190	SHEET NO. 36
FED. ROAD DIST. NO. ILLINOIS			FED. AID PROJECT	
CONTRACT NO. 66547				