

ROAD
CONSTRUCTION
AHEAD

W20-1103(O)-48
LT STA. 196+00

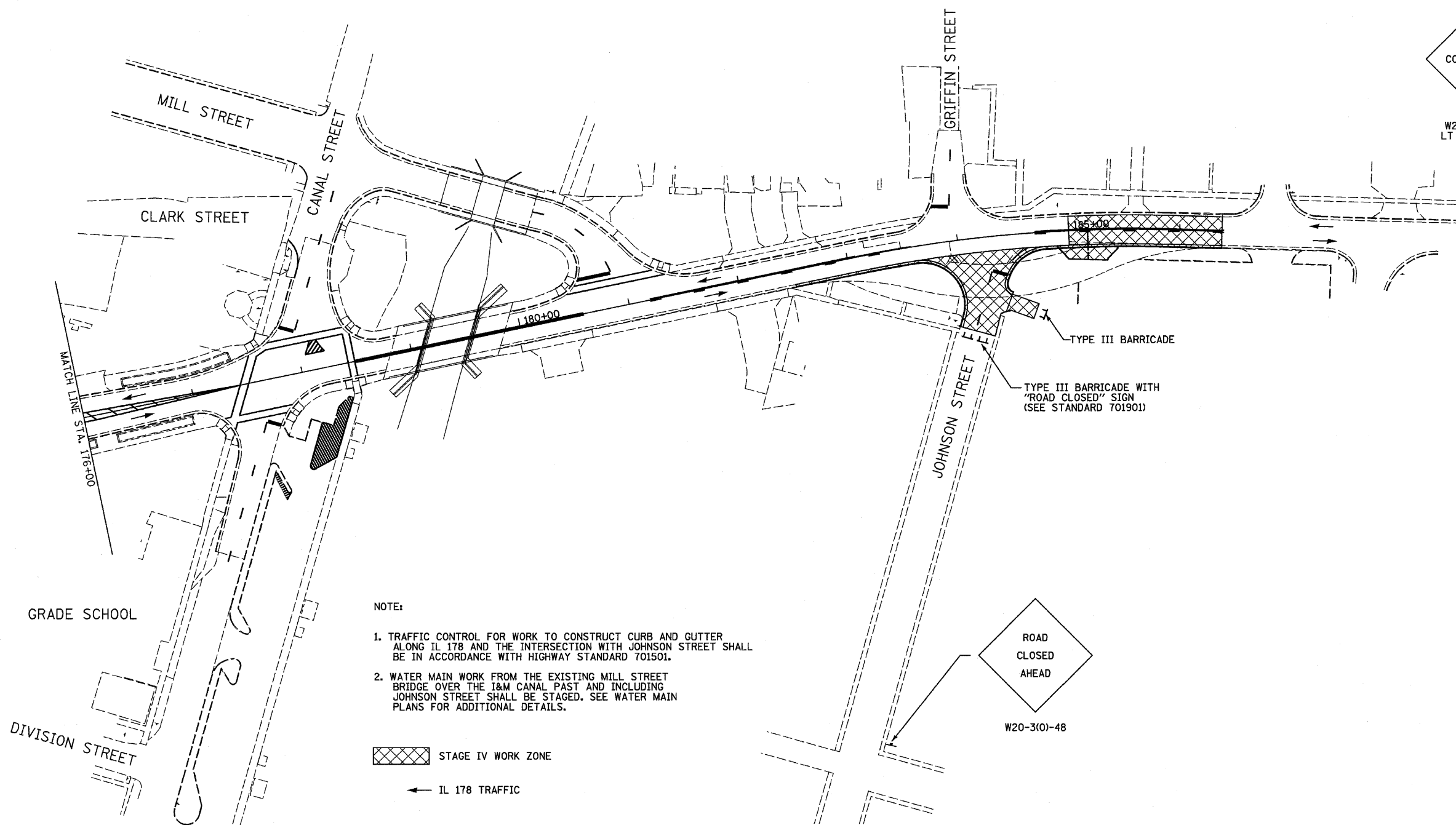

NOTE:

1. TRAFFIC CONTROL FOR WORK TO CONSTRUCT CURB AND GUTTER ALONG IL 178 AND THE INTERSECTION WITH JOHNSON STREET SHALL BE IN ACCORDANCE WITH HIGHWAY STANDARD 701501.
2. WATER MAIN WORK FROM THE EXISTING MILL STREET BRIDGE OVER THE I&M CANAL PAST AND INCLUDING JOHNSON STREET SHALL BE STAGED. SEE WATER MAIN PLANS FOR ADDITIONAL DETAILS.

STAGE IV WORK ZONE

IL 178 TRAFFIC

ROAD
CLOSED
AHEAD

W20-3(O)-48

FILE NAME = D366547-SHT-STAGE4.DGN	USER NAME = ---	DESIGNED - JKC	REVISED - ---	STATE OF ILLINOIS DEPARTMENT OF TRANSPORTATION	IL RTE 178 (RELOCATED) STAGE IV CONSTRUCTION AND TRAFFIC CONTROL PLANS			F.A.S. RTE. 1279	SECTION 6R,B	COUNTY LASALLE	TOTAL SHEETS 190	SHEET NO. 45
	PLOT SCALE = 1"=50'	DRAWN - LAG	REVISED - ---		SCALE: 1"=50'	SHEET NO. ___ OF ___ SHEETS	STA. 176+00 TO STA. 186+38.02	FED. ROAD DIST. NO. - (ILLINOIS) FED. AID PROJECT				
PLOT DATE = 08/10	CHECKED - JKC	DATE - 08/10	REVISED - ---					CONTRACT NO. 66547				