

STATE OF ILLINOIS
DEPARTMENT OF TRANSPORTATION

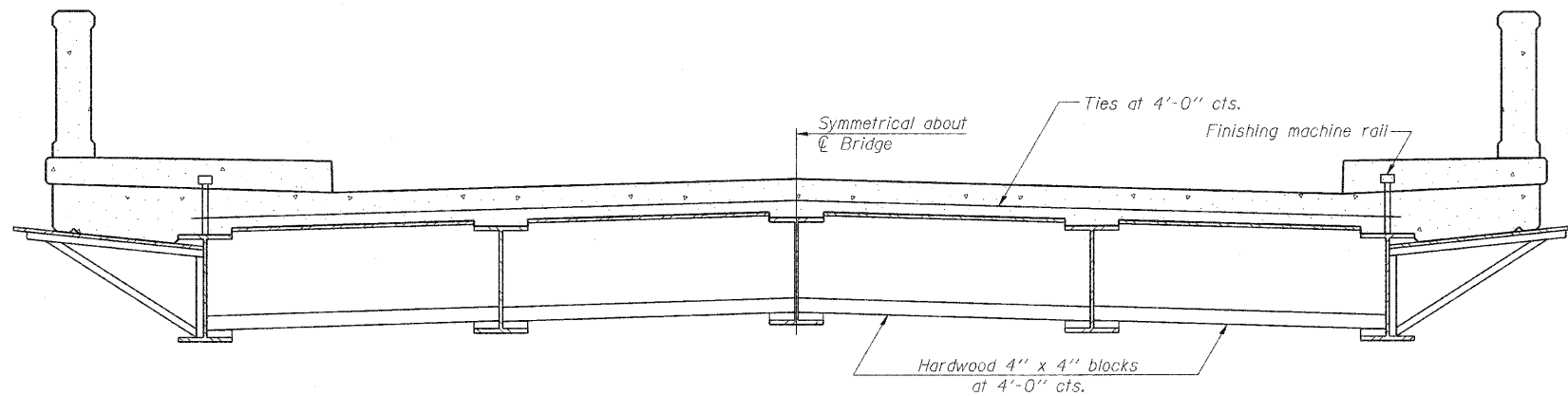

FORM BRACES FOR
STANDARD CONSTRUCTION

Notes:

When cantilever forming brackets are used, the work shall be done according to Article 503.06(b) of the Standard Specifications, except as modified below and in the details shown on this sheet.

The finishing machine rails shall be placed on the top flange of the exterior beams.

The beams or girders, supporting cantilever forming brackets, shall be tied together at 4 foot intervals.

For Standard construction, or Stage Construction the Hardwood bracing materials shall be placed as shown between webs of beams in each bay.

CANTILEVER FORMING BRACKETS FOR
SUPERSTRUCTURES WITH W27 BEAMS AND SMALLER
STRUCTURE NO. 050-0250

DESIGNED	CMF
CHECKED	TMM
DRAWN	RNH
CHECKED	TMM

 **McDonough-Whitlow, P.C.**
Consulting Engineers & Land Surveyors
138 East Wood Street
Hillsboro, IL 62049
Phone: 217.532.9233
Fax: 217.532.6300
PROFESSIONAL DESIGN No. 184-002754

SHEET NO. 17 20 SHEETS	F.A.S. RTE.	SECTION	COUNTY	TOTAL SHEETS	SHEET NO.
	1279	6R, B	LASALLE	190	119
			CONTRACT NO.	66547	
FED. ROAD DIST. NO. _ ILLINOIS FED. AID PROJECT					