

DATE	
BY	
REVIEWED	
DESIGNED	
DRAWN	
CHECKED	
DATE	

DATE	
BY	
REVIEWED	
DESIGNED	
DRAWN	
CHECKED	
DATE	

T 29 N, R 4 E, 3rd PM
SECTION 8

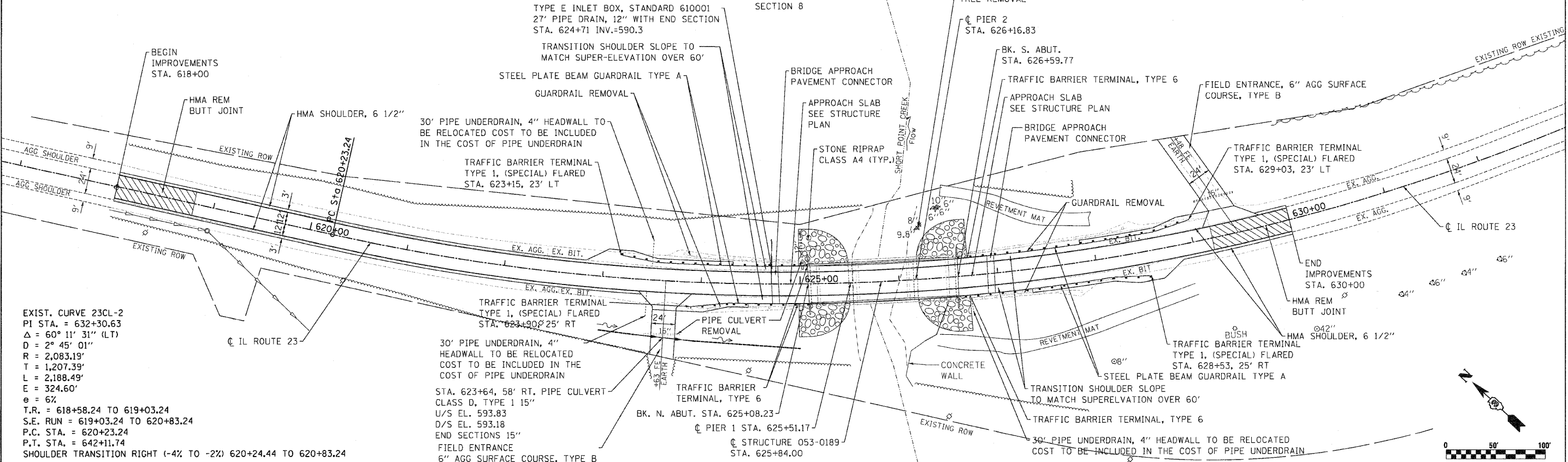

EXIST. CURVE 23CL-2
PI STA. = 632+30.63
Δ = 60° 11' 31" (LT)
D = 2° 45' 01"
R = 2,083.19'
T = 1,207.39'
L = 2,188.49'
E = 324.60'
e = 6%
T.R. = 618+58.24 TO 619+03.24
S.E. RUN = 619+03.24 TO 620+83.24
P.C. STA. = 620+23.24
P.T. STA. = 642+11.74
SHOULDER TRANSITION RIGHT (-4% TO -2%) 620+24.44 TO 620+83.24

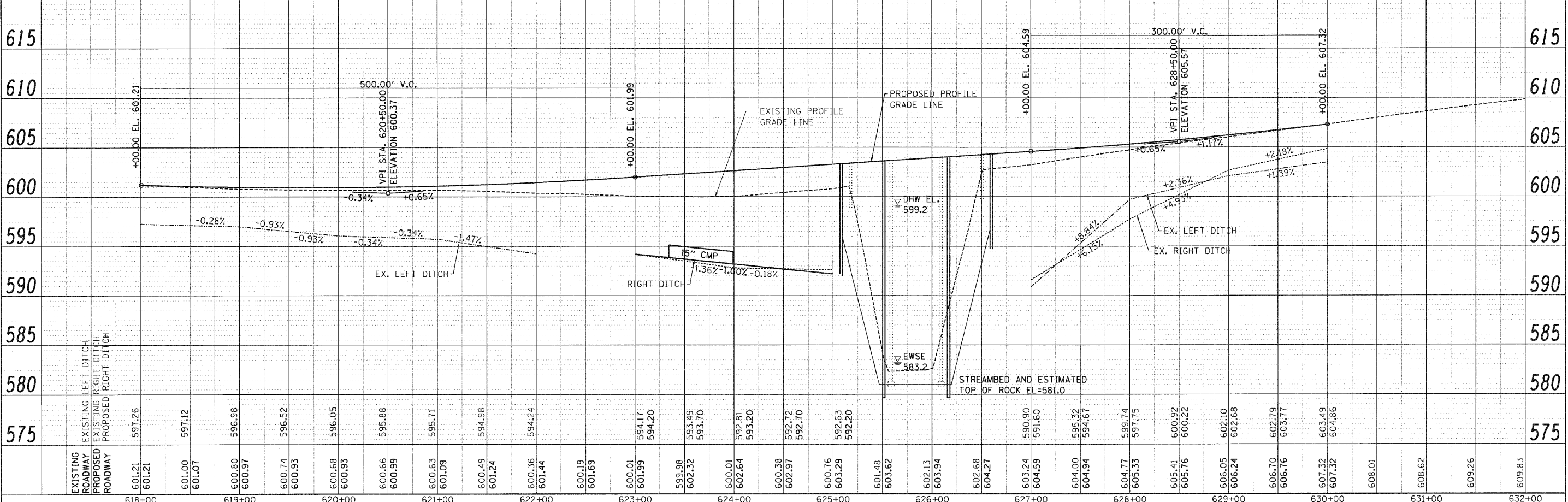
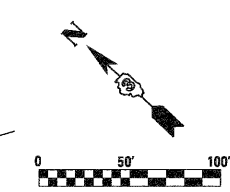

FILE NAME =	USER NAME = IDOTCAD	DESIGNED -	SPF	REVISED -	
W:\2299-03 - IL Route 23 Roadway\DCN\CAD	Sheets\036822-sht-plnpr-f.dgn	DRAWN -	AJP	REVISED -	
	PLOT SCALE = 50.0000' / in.	CHECKED -	JMS	REVISED -	
	PLOT DATE = 8/2/2010	DATE -	08/05/10	REVISED -	

STATE OF ILLINOIS
DEPARTMENT OF TRANSPORTATION

PLAN AND PROFILE

SCALE: 1"=50' SHEET NO. 01 OF 01 SHEETS STA. 618+00 TO STA. 630+00

F.A.P. RTE.	SECTION	COUNTY	TOTAL SHEETS	SHEET NO.
68	(102) BR-1	LIVINGSTON	58	7
CONTRACT NO. 66822				
ILLINOIS FED. AID PROJECT				