

NOTES:
 SEE STANDARD 701321 FOR DETAILS NOT SHOWN.

DOUBLE UP THE ADVANCED WARNING SIGNS ON EACH SIDE OF THE ROAD FOR BOTH APPROACHES. MOUNT THE "ROAD CONSTRUCTION AHEAD" SIGNS ON TYPE III BARRICADES WITH TWO FLASHING MONO-DIRECTIONAL LIGHTS FOR EACH SIGN.

ADD ONE FLASHING MONO-DIRECTIONAL LIGHT TO ALL OF THE REMAINING ADVANCE WARNING SIGNS.

THE COST FOR THE ADDITIONAL SIGNS AND LIGHTS WILL BE INCLUDED IN THE COST OF "TRAFFIC CONTROL AND PROTECTION STANDARD 701321".

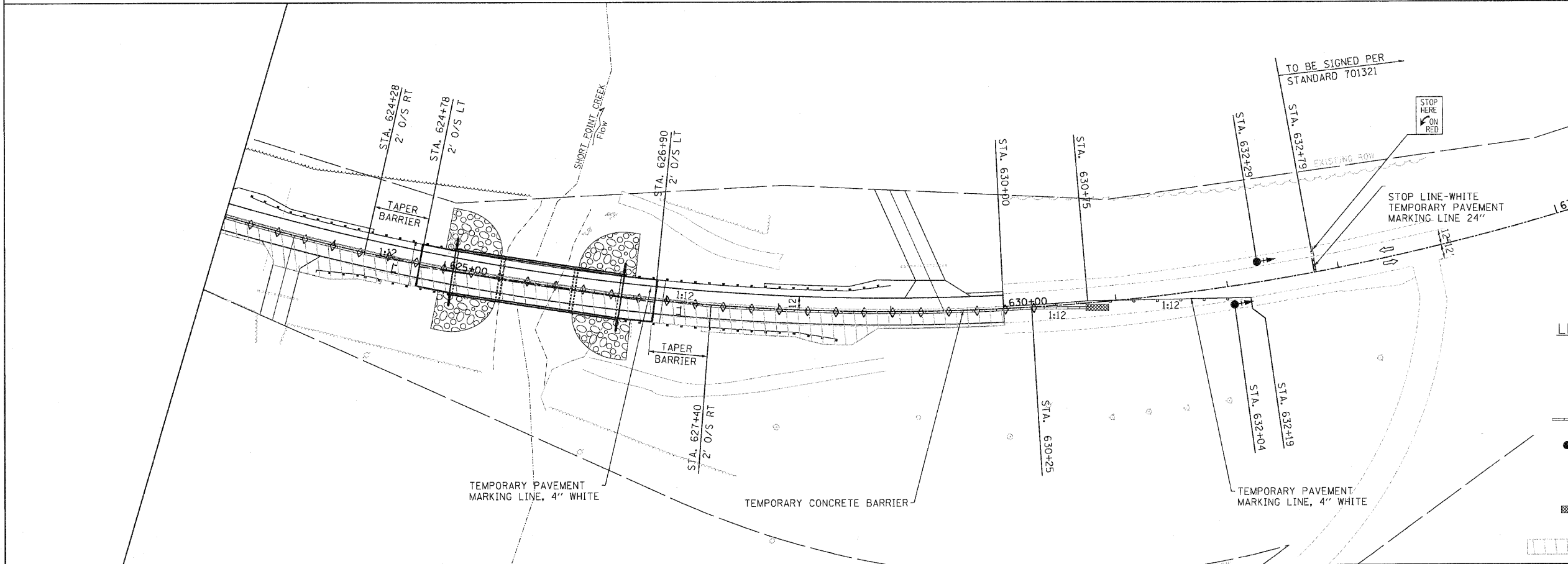
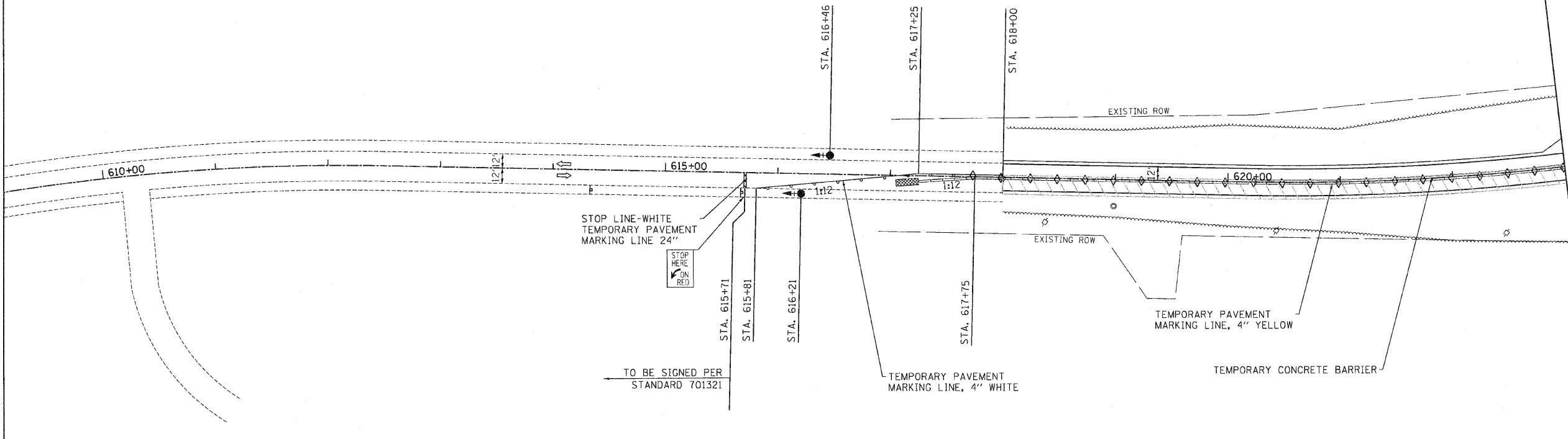

- LEGEND**
- ◇ CRYSTAL BIDIRECTIONAL BARRIER
 - ◊ WALL/GUARDRAIL MARKER
 - ▲ MICROWAVE DETECTOR
 - ⊕ SIGN
 - ▬ TEMPORARY CONCRETE BARRIER
 - TEMPORARY TRAFFIC SIGNAL WITH BACKPLATE
 - ⊥ TYPE III BARRICADES
 - ▨ DOUBLE VERTICAL PANEL
 - ▩ IMPACT ATTENUATOR
 - DRUM WITH STEADY BURNING LIGHT
 - ▭ WORK AREA

FILE NAME =	USER NAME = #USER#	DESIGNED - SPF	REVISED -
#FILE#		DRAWN - AJP	REVISED -
	PLOT SCALE = #SCALE#	CHECKED - JMS	REVISED -
	PLOT DATE = #DATE#	DATE - 08/05/10	REVISED -

**STATE OF ILLINOIS
 DEPARTMENT OF TRANSPORTATION**

**STAGES OF CONSTRUCTION AND TRAFFIC CONTROL
 STAGE 2 CONSTRUCTION**

SCALE: 1"=50' SHEET NO. 03 OF 03 SHEETS STA. TO STA.

F.A.P. RTE.	SECTION	COUNTY	TOTAL SHEETS	SHEET NO.
68	(102) BR-1	LIVINGSTON	58	10
			CONTRACT NO. 66822	
ILLINOIS FED. AID PROJECT				