

T 29 N, R 4 E, 3rd PM
SECTION 8

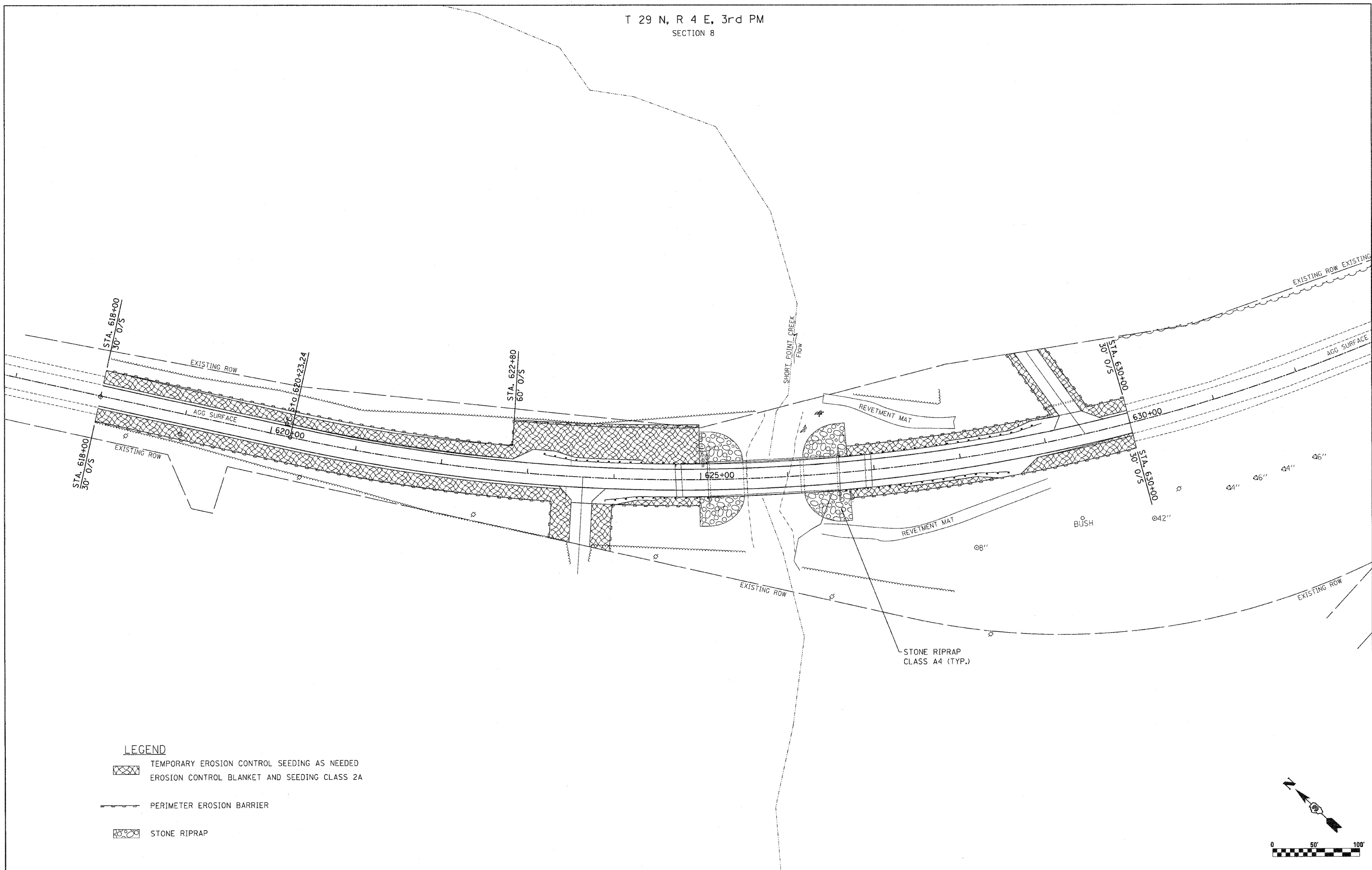

LEGEND

- TEMPORARY EROSION CONTROL SEEDING AS NEEDED
- EROSION CONTROL BLANKET AND SEEDING CLASS 2A
- PERIMETER EROSION BARRIER
- STONE RIPRAP

FILE NAME - W:\2299-03 - IL Route 23 Roadway\DDN\CA	USER NAME = IDOTCAD	DESIGNED - SPF	REVISED -
DD Sheets\0368822-shr-eros.dgn		DRAWN - AJP	REVISED -
PLOT SCALE = 50,0000' / in.		CHECKED - JMS	REVISED -
PLOT DATE = 8/2/2010		DATE - 08/05/10	REVISED -

**STATE OF ILLINOIS
DEPARTMENT OF TRANSPORTATION**

**EROSION AND SEDIMENT
CONTROL DETAILS**

SCALE: 1"=50' SHEET NO. 01 OF 01 SHEETS STA. TO STA.

F.A.P. RTE. 68	SECTION (102) BR-1	COUNTY LIVINGSTON	TOTAL SHEETS 58	SHEET NO. 11
CONTRACT NO. 66822				
ILLINOIS FED. AID PROJECT				