

DATE	
BY	
SURVEYED	
ALIGNED	
CHECKED	
NOTE BOOK	
NO.	
PLAN	

DATE	
BY	
SURVEYED	
GRADES	
CHECKED	
NOTE BOOK	
NO.	
PROFILE	

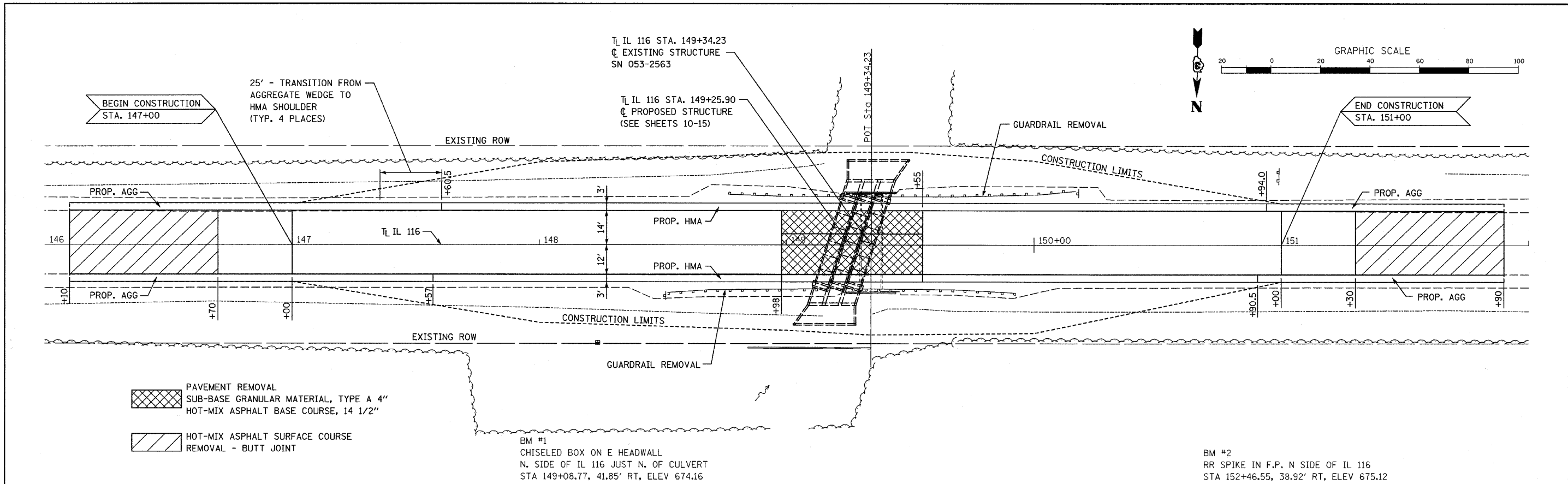

PAVEMENT REMOVAL
 SUB-BASE GRANULAR MATERIAL, TYPE A 4"
 HOT-MIX ASPHALT BASE COURSE, 14 1/2"
 HOT-MIX ASPHALT SURFACE COURSE
 REMOVAL - BUTT JOINT

BM #1
 CHISELED BOX ON E HEADWALL
 N. SIDE OF IL 116 JUST N. OF CULVERT
 STA 149+08.77, 41.85' RT, ELEV 674.16

BM #2
 RR SPIKE IN F.P. N SIDE OF IL 116
 STA 152+46.55, 38.92' RT, ELEV 675.12

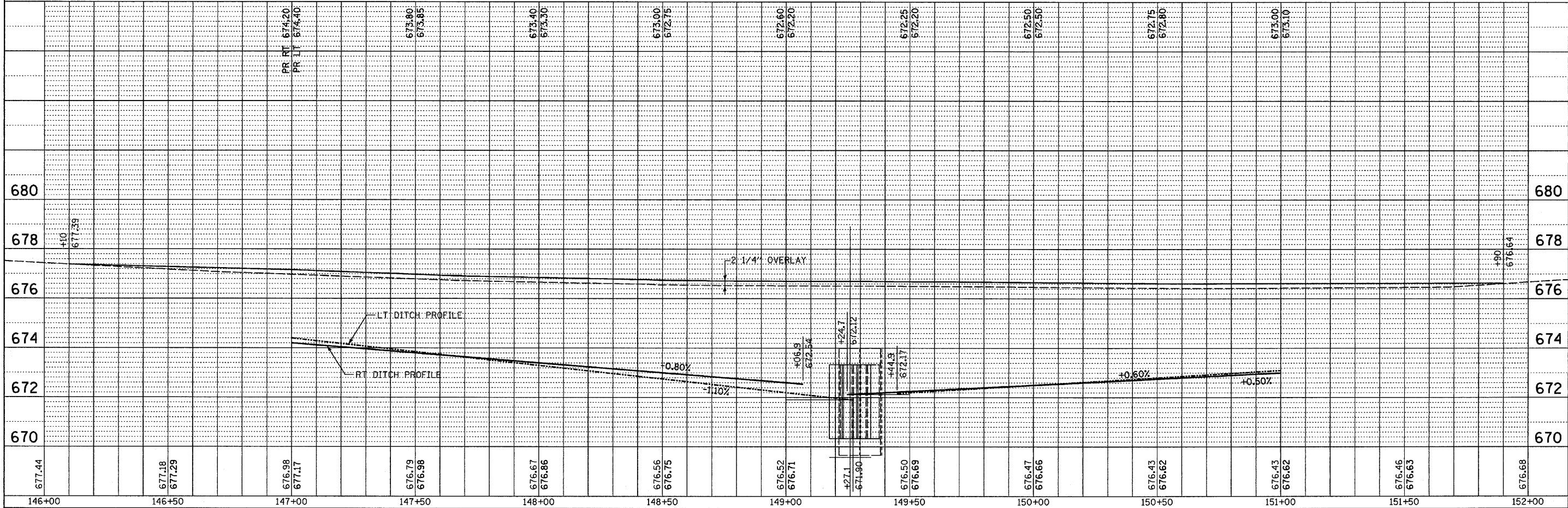

FILE NAME = 0366879-SHT-PLNPRF.DGN	USER NAME = ---	DESIGNED - JKC	REVISED - ---	STATE OF ILLINOIS DEPARTMENT OF TRANSPORTATION	PLAN & PROFILE SCALE: 1"=20' SHEET NO. OF SHEETS STA. 146+00 TO STA. 152+00	F.A.P. RTE. = 681	SECTION = (115)I	COUNTY = LIVINGSTON	TOTAL SHEETS = 20	SHEET NO. = 7
	PLOT SCALE = 1"=20'	DRAWN - NV	REVISED - ---			CONTRACT NO. 66870				
	PLOT DATE = 01/18	CHECKED - JKC	REVISED - ---			ILLINOIS FED. AID PROJECT				
		DATE = 01/10	REVISED - ---							