

STATE OF ILLINOIS
DEPARTMENT OF TRANSPORTATION

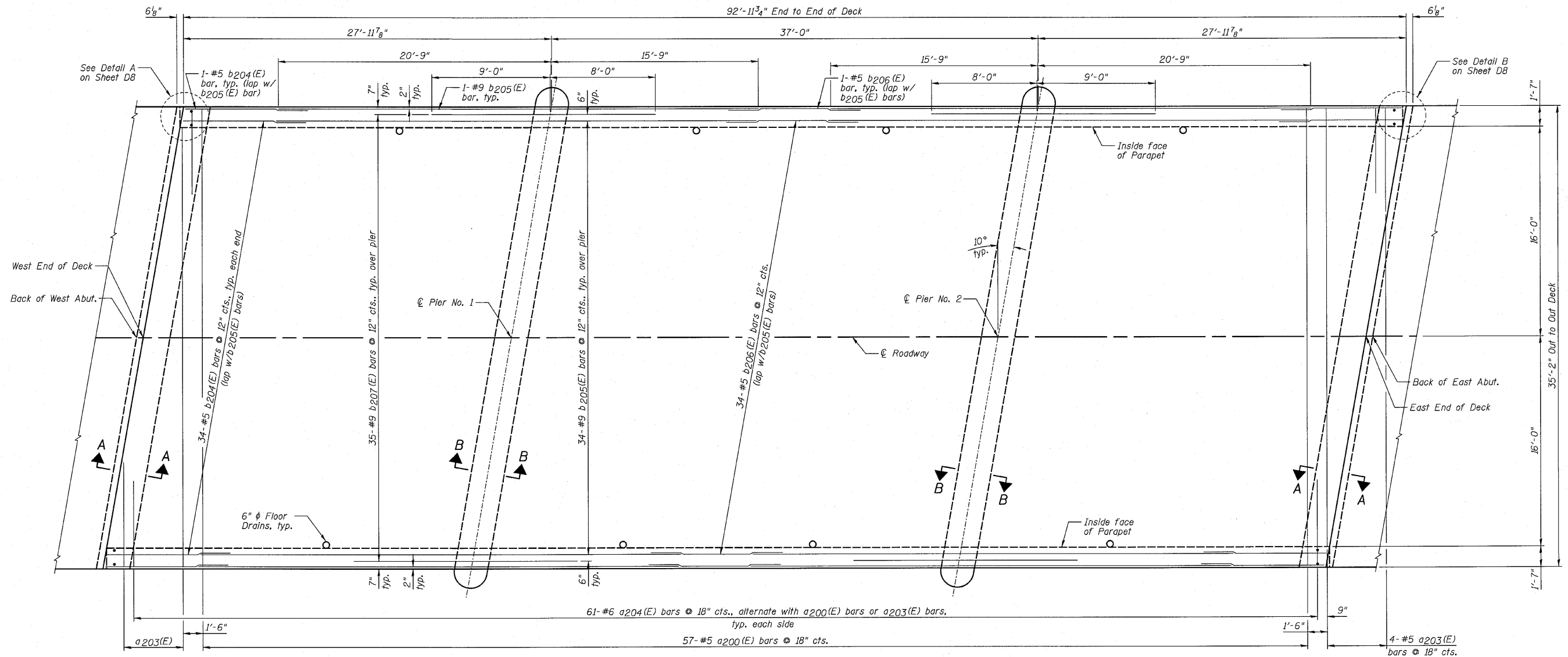

TOP OF SLAB PLAN



BAR LAP
#5 - 2'-3"

NOTES:

- 1.) See Sheet D8 for Superstructure Details and Bill of Material.
- 2.) See Sheet D7 for Sections A-A and B-B.
- 3.) See Sheet D8 for Floor Drain details.
- 4.) Order a203(E) bars full length. Cut according to Bar Cutting Diagram on Sheet D8. Use remainder of bars in opposite end of deck.

DESIGNED	SDH
CHECKED	JML
DRAWN	JWK/DJM
CHECKED	MSW

DATE 08/04/10

SUPERSTRUCTURE DECK
STRUCTURE NO. 027-0100

<p>FARNSWORTH GROUP, INC. 2709 McGraw Drive Bloomington, Illinois 61704 309/663-8435, 309/663-1571 fax</p>	SHEET NO. D6 18 SHEETS	F.A.P. RTE.	SECTION	COUNTY	TOTAL SHEETS	SHEET NO.
		681	*	FORD/IROQUOIS	146	73
		CONTRACT NO. 66880				
		FED. ROAD DIST. NO.	ILLINOIS FED. AID PROJECT			

* 116 BR/[116 BR, (BR-2)BR, I & BR-3]

24-8271