

STATE OF ILLINOIS
DEPARTMENT OF TRANSPORTATION

NORTH CURB LINE/NORTH FACE OF PARAPET

Location	Station	Offset	Theoretical Grade Elevations
W. End of West Appr.	173+87.48	-16.45	660.53
A	173+97.48	-16.44	660.55
B	174+07.23	-16.02	660.57
Back of West Abut.	174+16.64	-16.01	660.59
E. End of West Appr.	174+17.23	-16.01	660.59

NORTH EDGE OF PAVEMENT

Location	Station	Offset	Theoretical Grade Elevations
W. End of West Appr.	173+84.82	-12.03	660.62
A	173+94.82	-12.03	660.64
B	174+04.82	-12.02	660.65
Back of West Abut.	174+14.24	-12.01	660.67
E. End of West Appr.	174+14.82	-12.01	660.67

☉ ROADWAY & PROFILE GRADE LINE (P.G.L.)

Location	Station	Offset	Theoretical Grade Elevations
W. End of West Appr.	173+77.61	-0.03	660.79
A	173+87.61	-0.03	660.81
B	173+97.61	-0.02	660.83
Back of West Abut.	174+07.03	-0.01	660.84
E. End of West Appr.	174+07.61	-0.01	660.85

SOUTH EDGE OF PAVEMENT

Location	Station	Offset	Theoretical Grade Elevations
W. End of West Appr.	173+70.40	11.97	660.58
A	173+80.40	11.97	660.61
B	173+90.40	11.98	660.63
Back of West Abut.	173+99.82	11.99	660.65
E. End of West Appr.	174+00.40	11.99	660.65

SOUTH CURB LINE/SOUTH FACE OF PARAPET

Location	Station	Offset	Theoretical Grade Elevations
W. End of West Appr.	173+67.75	16.39	660.48
A	173+77.75	16.38	660.51
B	173+88.00	15.98	660.54
Back of West Abut.	173+97.42	15.99	660.56
E. End of West Appr.	173+98.00	15.99	660.56

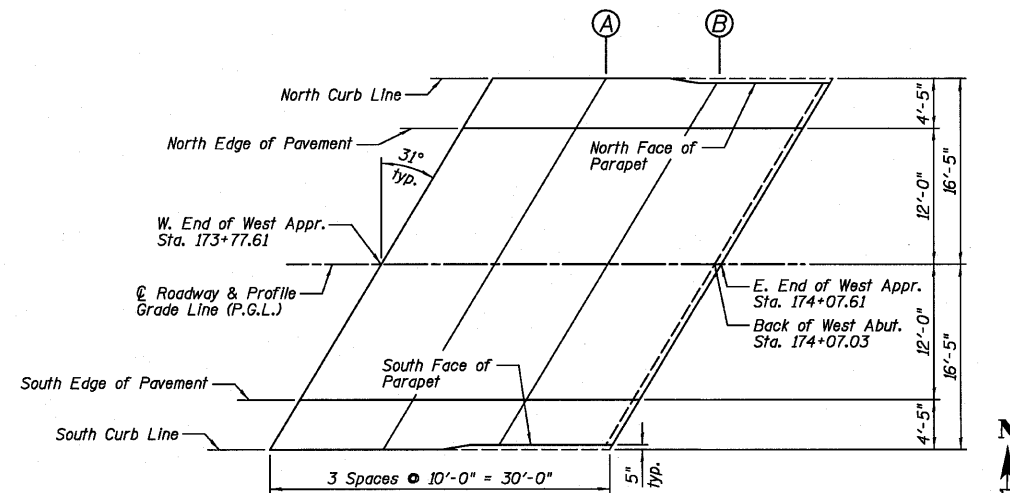

WEST APPROACH SLAB PLAN

NORTH CURB LINE/NORTH FACE OF PARAPET

Location	Station	Offset	Theoretical Grade Elevations
W. End of East Appr.	175+24.06	-16.01	660.48
Back of East Abut.	175+24.64	-16.01	660.48
A	175+34.06	-16.02	660.45
B	175+44.31	-16.44	660.41
E. End of East Appr.	175+54.31	-16.45	660.37

NORTH EDGE OF PAVEMENT

Location	Station	Offset	Theoretical Grade Elevations
W. End of East Appr.	175+21.66	-12.01	660.57
Back of East Abut.	175+22.24	-12.01	660.57
A	175+31.66	-12.02	660.54
B	175+41.66	-12.03	660.51
E. End of East Appr.	175+51.66	-12.03	660.47

☉ ROADWAY & PROFILE GRADE LINE (P.G.L.)

Location	Station	Offset	Theoretical Grade Elevations
W. End of East Appr.	175+14.45	-0.01	660.78
Back of East Abut.	175+15.03	-0.01	660.78
A	175+24.45	-0.02	660.75
B	175+34.45	-0.03	660.72
E. End of East Appr.	175+44.45	-0.03	660.69

SOUTH EDGE OF PAVEMENT

Location	Station	Offset	Theoretical Grade Elevations
W. End of East Appr.	175+07.24	11.99	660.61
Back of East Abut.	175+07.82	11.99	660.61
A	175+17.24	11.98	660.59
B	175+27.24	11.97	660.56
E. End of East Appr.	175+37.24	11.97	660.53

SOUTH CURB LINE/SOUTH FACE OF PARAPET

Location	Station	Offset	Theoretical Grade Elevations
W. End of East Appr.	175+04.83	15.99	660.53
Back of East Abut.	175+05.42	15.99	660.53
A	175+14.83	15.98	660.51
B	175+24.58	16.38	660.47
E. End of East Appr.	175+34.58	16.39	660.44

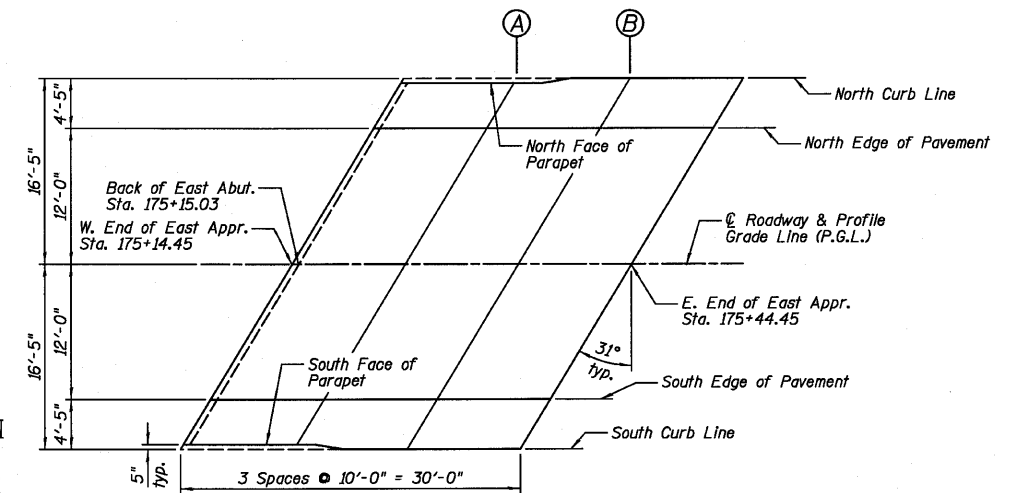

EAST APPROACH SLAB PLAN

DESIGNED	SDH
CHECKED	JML
DRAWN	JWK/DJM
CHECKED	MSW

DATE 08/04/10

NOTE:
Offset dimensions are from the Roadway ☉.
See offset sketch on Sheet E1 for additional information.

APPROACH SLAB ELEVATIONS
STRUCTURE NO. 027-0098

Farnsworth GROUP, INC. 2709 McGraw Drive Bloomington, Illinois 61704 309/683-8435, 309/683-1571 fax	SHEET NO. E4	F.A.P. RTE. 681	SECTION *	COUNTY FORD/IROQUOIS	TOTAL SHEETS 146	SHEET NO. 89
	18 SHEETS	FED. ROAD DIST. NO. ILLINOIS FED. AID PROJECT		CONTRACT NO. 66880		

* 116 BR/L116 BR, (BR-2)BR, I & BR-31

24-8271