

F.A.P. RTE.	SECTION	COUNTY	TOTAL SHEETS	SHEET NO.
704	(1)N & TS-1	McLEAN	497	70
STA. 2+300.000		TO STA. 2+450.000		
FED. ROAD DIST. NO.		ILLINOIS FED. AID PROJECT		
CONTRACT NO. 70514				

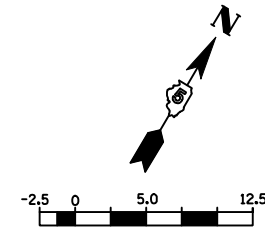

CVSB - 2
 PI STA = 2+431.834
 $\Delta = 8^\circ 20' 26''$ (RT)
 R = 1,000.670 m
 T = 72.964 m
 L = 145.670 m
 E = 2.657 m
 e = EXISTING
 T.R. = EXISTING
 S.E. RUN. = EXISTING
 P.C. STA = 2+358.871
 P.T. STA = 2+504.540

- NOTES:
1. ALL STATIONING SHOWN IS BASED UPON \bar{C} VETERANS PARKWAY (SOUTHBOUND).
 2. ALL PROPOSED COMBINATION CONCRETE CURB & GUTTER SHOWN IS TYPE B-15.45 UNLESS OTHERWISE NOTED.
 3. SEE INTERSECTION DETAILS FOR STATIONS, OFFSET, & RADII AT INTERSECTION.
 4. SAWCUT ALL EXISTING PAVEMENT AS NECESSARY TO OBTAIN CLEAN EDGE.

BY	DATE

BY	DATE

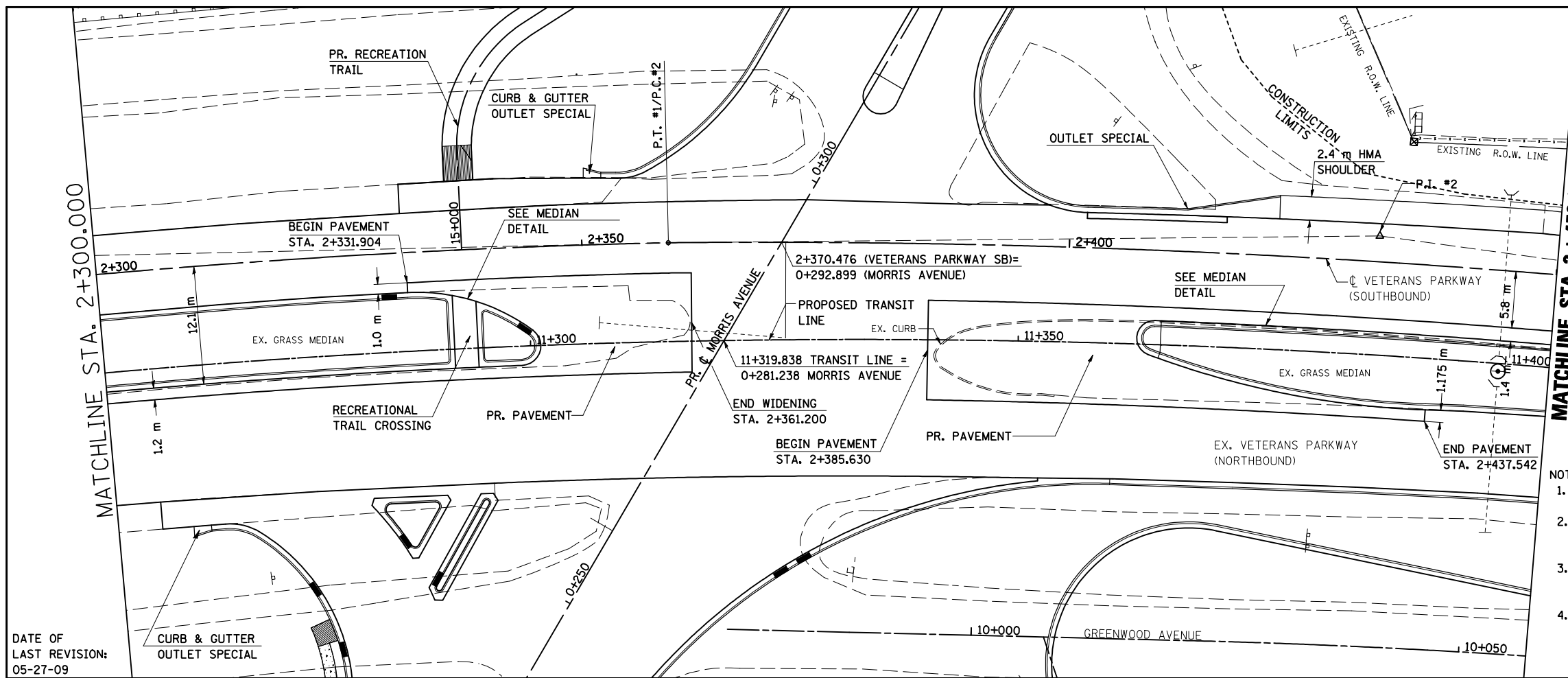

DATE OF LAST REVISION:
05-27-09

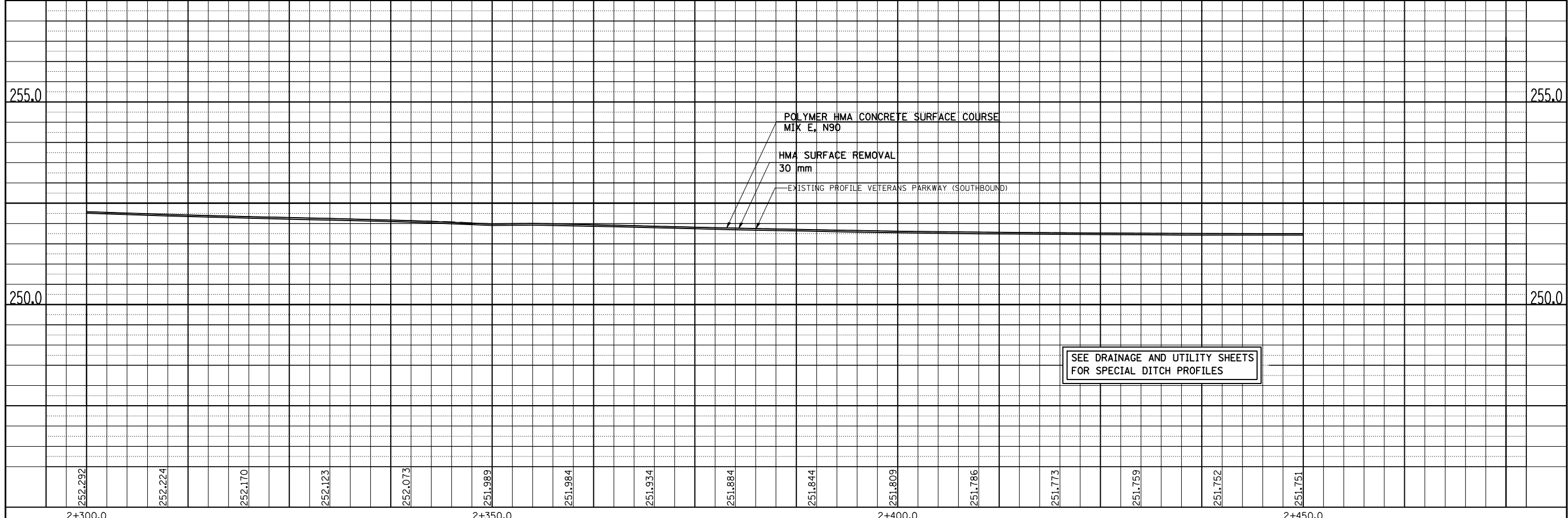

SEE DRAINAGE AND UTILITY SHEETS FOR SPECIAL DITCH PROFILES