

F.A.P. RTE.	SECTION	COUNTY	TOTAL SHEETS	SHEET NO.
704	(1)N & TS-1	McLEAN	497	76
STA. 0+200.000 TO STA. 0+350.000		ILLINOIS FED. AID PROJECT		
FED. ROAD DIST. NO.		CONTRACT NO. 70514		

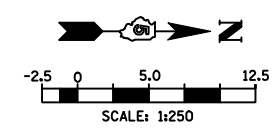

BY	DATE
FINAL SURVEYED	
SURVEY PLOTTED	
NOTE BOOK TEMPLATE	
AREAS CHECKED	
NO.	

BY	DATE
ORIGINAL SURVEYED	
SURVEY PLOTTED	
NOTE BOOK TEMPLATE	
AREAS CHECKED	
NO.	

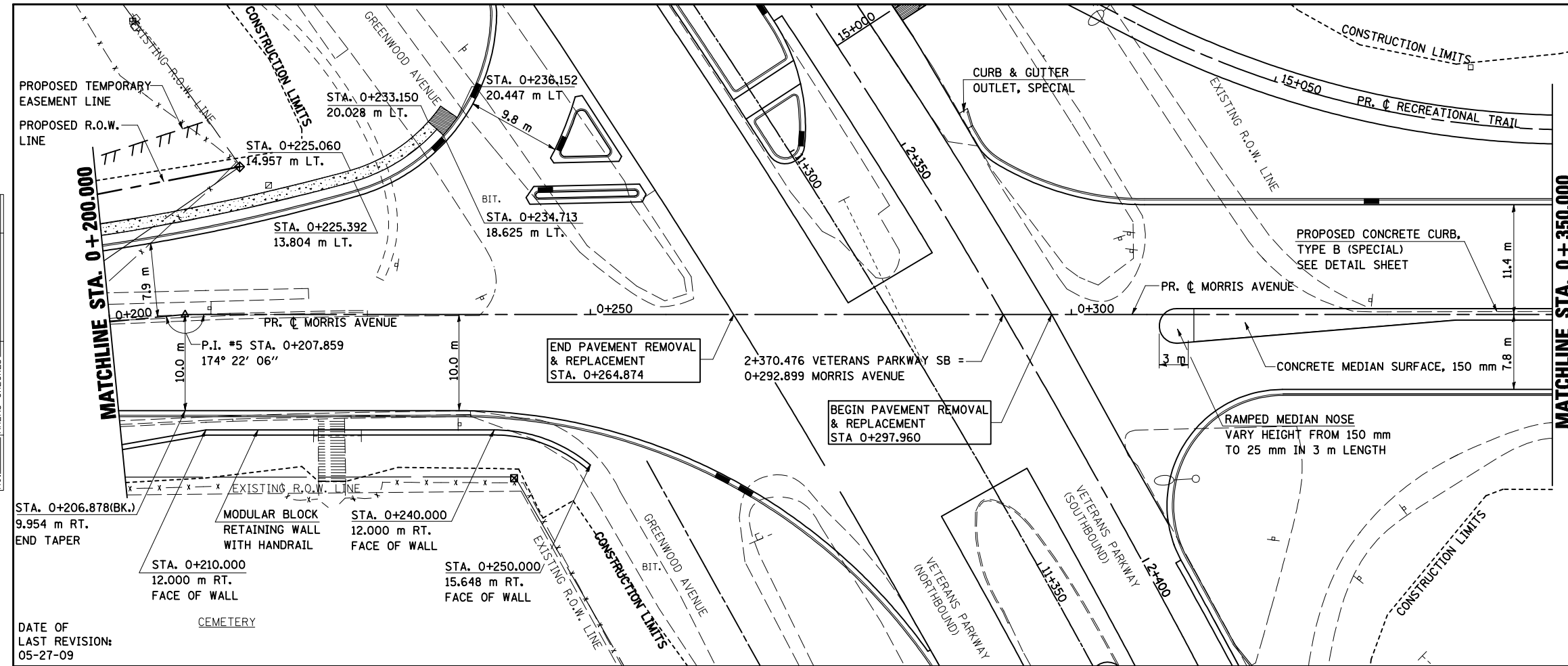

- NOTES:
1. ALL PROPOSED COMBINATION CONCRETE CURB & GUTTER SHOWN IS TYPE B-15.45 UNLESS OTHERWISE NOTED.
  2. SEE INTERSECTION DETAILS FOR STATIONS, OFFSETS, & RADII AT INTERSECTIONS.
  3. ALL PROPOSED P.C.C. SIDEWALK IS 1.2 m EXCEPT WHERE PLACED AT THE BACK OF CURB WHICH REQUIRES 1.8 m WIDTH.
  4. FOR EXISTING AND PROPOSED R.O.W. OFFSETS SEE R.O.W. PLAN SHEETS.

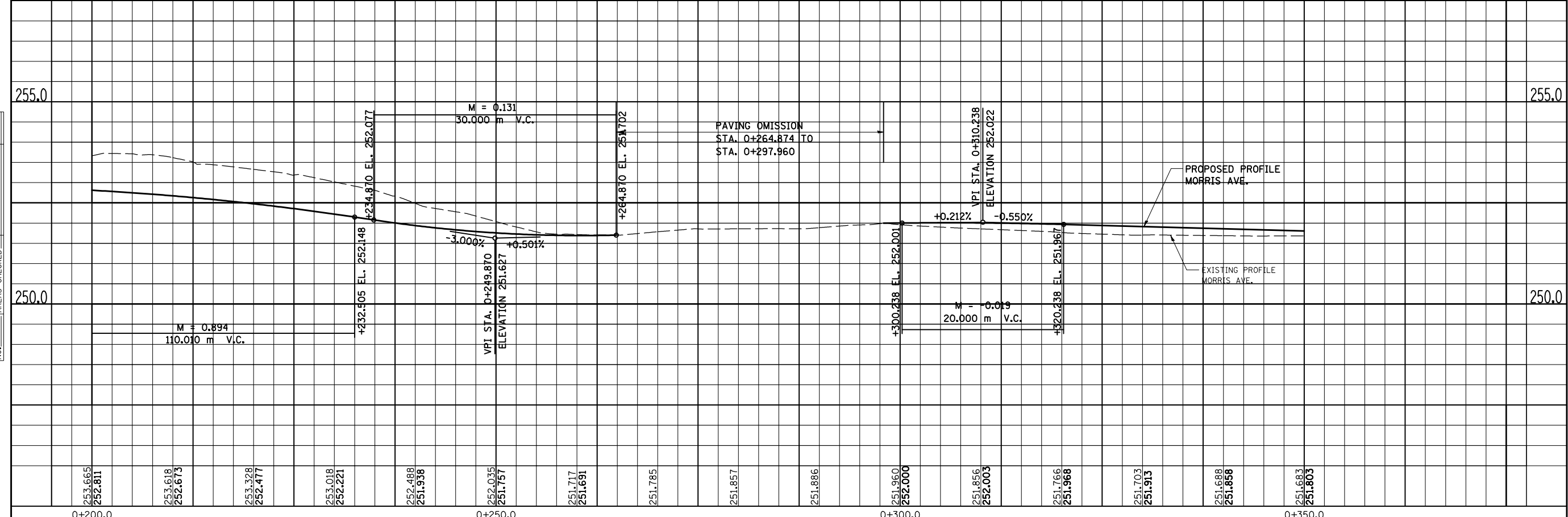

**MORRIS AVENUE, PLAN & PROFILE, STA. 0 + 200.000 TO STA. 0 + 350.000**