

F.A.P. RTE.	SECTION	COUNTY	TOTAL SHEETS	SHEET NO.
704	(1)N & TS-1	McLEAN	497	105
STA. 2+750.000		TO STA. 3+050.000		
FED. ROAD DIST. NO.	ILLINOIS FED. AID PROJECT			

CONTRACT NO. 70514

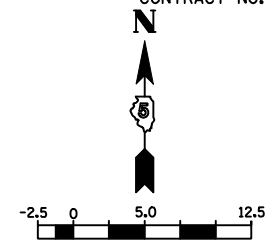

1:250
LEGEND

- DRUM, BARRICADE OR VERTICAL BARRICADE WITH STEADY BURNING MONO DIRECTIONAL LIGHT
- ⊥ SIGN
- ▨ WORK AREA
- ▩ TEMPORARY PAVEMENT
- ⇐ DIRECTION OF TRAFFIC

WORK TO BE COMPLETED IN STAGE I
CONSTRUCT VETERANS PARKWAY PAVEMENT FROM STA. 2+435.000 TO STA. 3+050.000, LEFT.

SEE STANDARD 701422-01 FOR ADDITIONAL DETAILS.

VETERANS PARKWAY WORK ZONE SPEED LIMIT: 35 MPH.

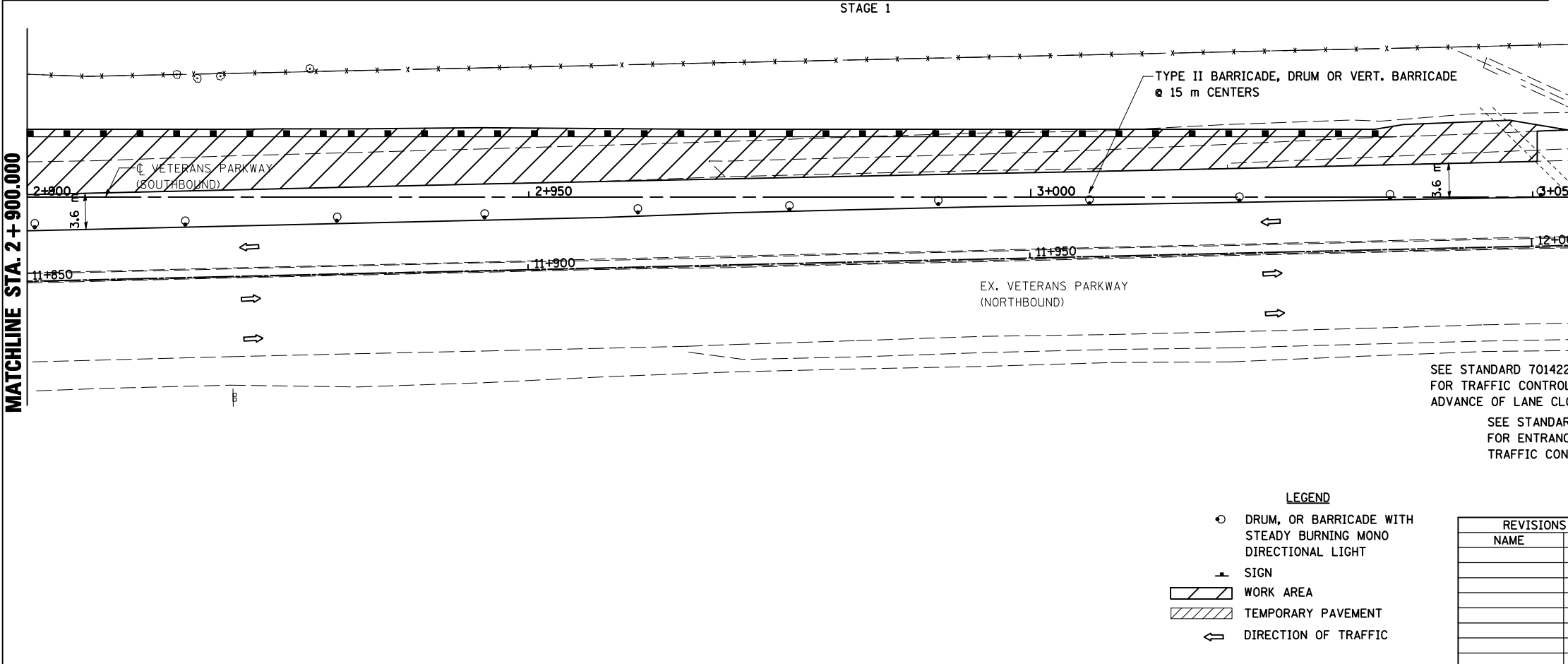
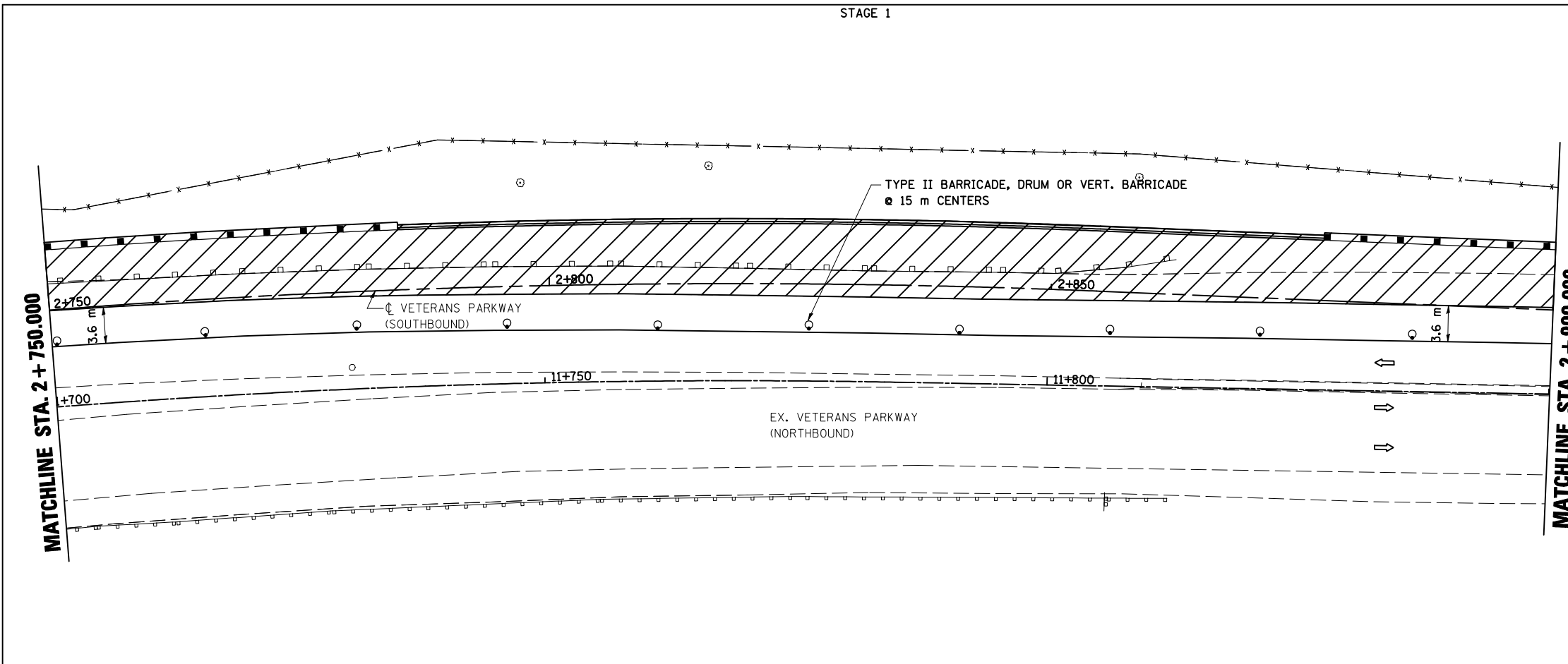

SEE STANDARD 701422-01 FOR TRAFFIC CONTROL IN ADVANCE OF LANE CLOSURE
SEE STANDARD 701411-03 FOR ENTRANCE RAMP TRAFFIC CONTROL

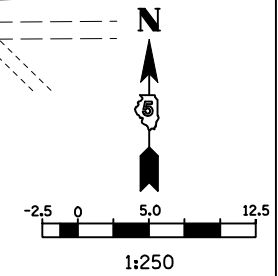

LEGEND

- DRUM, OR BARRICADE WITH STEADY BURNING MONO DIRECTIONAL LIGHT
- ⊥ SIGN
- ▨ WORK AREA
- ▩ TEMPORARY PAVEMENT
- ⇐ DIRECTION OF TRAFFIC

REVISIONS	
NAME	DATE

ILLINOIS DEPARTMENT OF TRANSPORTATION

STAGING PLANS
STAGE 1 VETERANS PARKWAY

DATE 05-27-09
DRAWN BY SAM
CHECKED BY PMH

STAGING PLANS, STAGE 1 VETERANS PARKWAY

PLOT DATE = 8/12/2009
 PLOT SCALE = 1:2500
 USER NAME = craigre