

F.A.P. RTE.	SECTION	COUNTY	TOTAL SHEETS	SHEET NO.
704	(1)N & TS-1	McLEAN	497	118
STA. 0+000.000 TO STA. 0+250.000		ILLINOIS FED. AID PROJECT		
FED. ROAD DIST. NO.		CONTRACT NO. 70514		

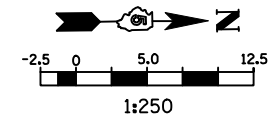

- LEGEND**
- ▲ SIGN
 - DRUM, BARRICADE OR VERTICAL BARRICADE WITH STEADY BURNING LIGHT
 - ▨ WORK AREA
 - ▩ TEMPORARY PAVEMENT
 - FLEXIBLE DELINEATORS
 - ⇨ DIRECTION OF TRAFFIC
 - ⌋ TYPE III BARRICADE WITH FLASHING LIGHTS

GENERAL STAGING NOTES
 MAINTAIN ACCESS TO ALL ADJACENT PROPERTIES THROUGHOUT THE DURATION OF THE PROJECT.

PLACE TYPE III BARRICADES IN ACCORDANCE WITH STANDARD 701901.

CLOSE SIDEWALKS AS NECESSARY IN ACCORDANCE WITH STANDARD 701801.

WORK TO BE COMPLETED IN STAGE 2
 CONSTRUCT FINAL PAVEMENT FROM STATION 0+057.000 TO STATION 0+150.000, WEST OF PROPOSED CENTERLINE. CONSTRUCT TEMPORARY PAVEMENT FROM STATION 0+024.0 TO STATION 0+120.0 AND FROM STATION 0+150.000 TO STATION 0+218.600.

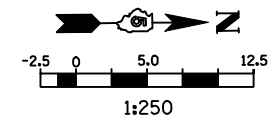

- LEGEND**
- ⌋ TYPE III BARRICADE WITH FLASHING LIGHTS
 - ▲ SIGN
 - DRUM, BARRICADE OR VERTICAL BARRICADE WITH STEADY BURNING LIGHT
 - ▨ WORK AREA
 - ▩ TEMPORARY PAVEMENT
 - FLEXIBLE DELINEATORS
 - ⇨ DIRECTION OF TRAFFIC

REVISIONS	
NAME	DATE

ILLINOIS DEPARTMENT OF TRANSPORTATION

STAGING PLANS
 STAGE 2 MORRIS AVENUE (SOUTH)

DATE 05-27-09

DRAWN BY SAM
 CHECKED BY PMH

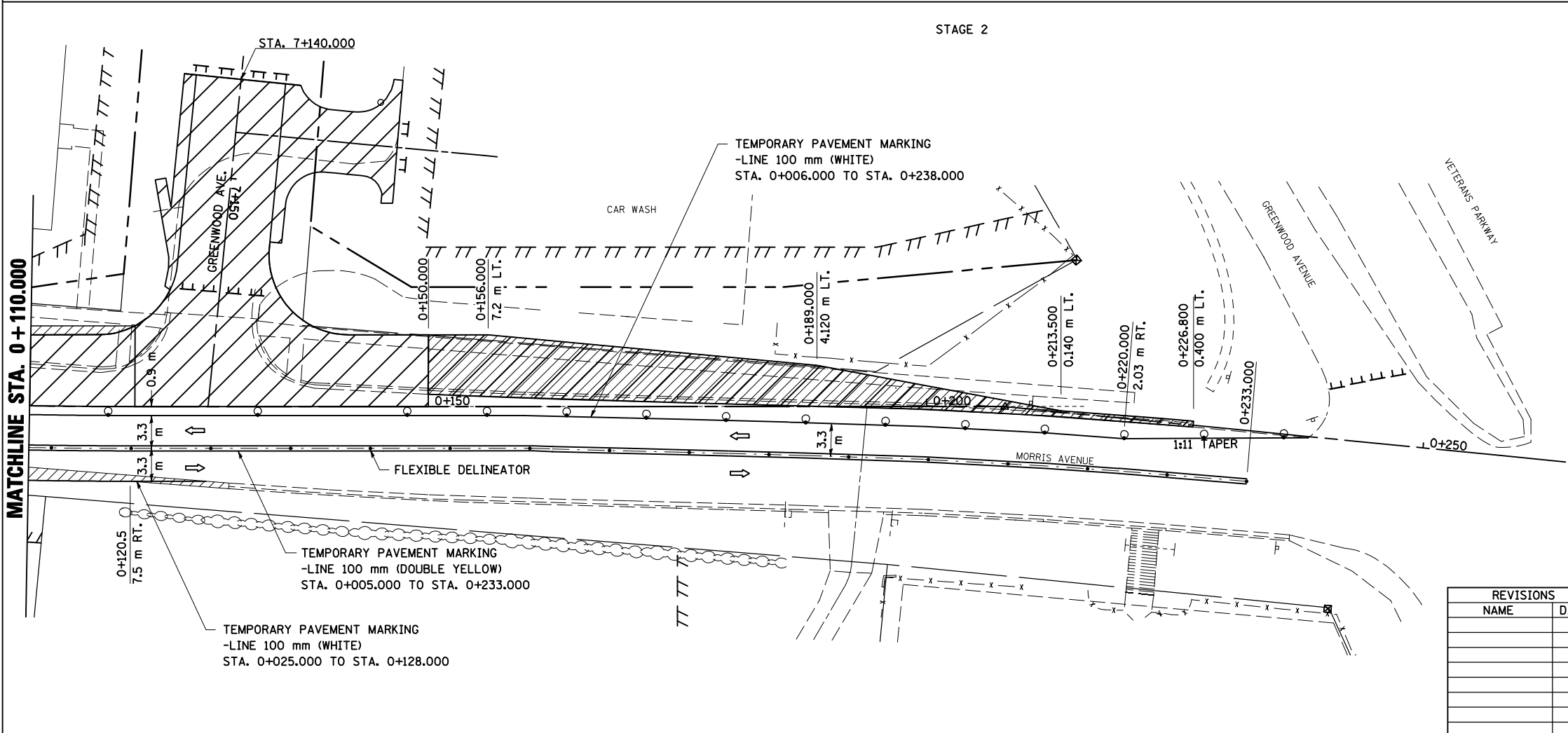
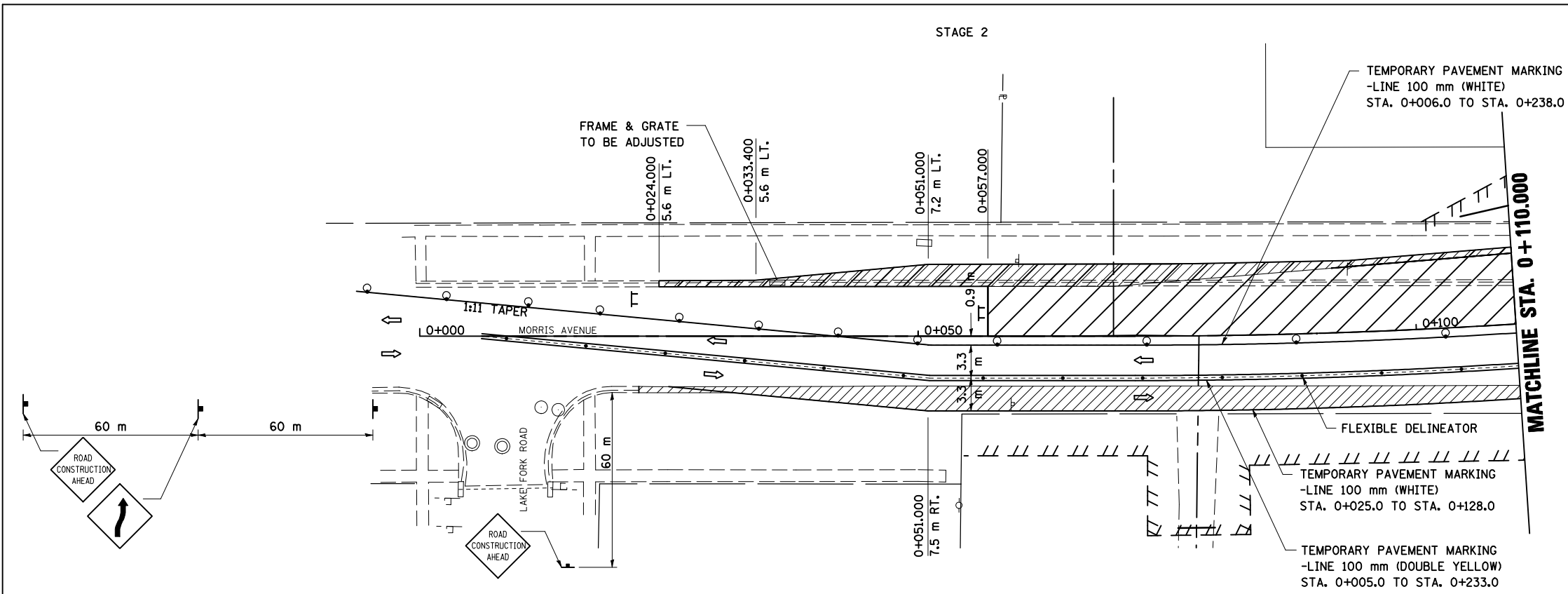

PLOT DATE = 8/12/2009
 PLOT SCALE = 1:250000 m / in
 USER NAME = creggie

STAGING PLANS, STAGE 2 MORRIS AVENUE (SOUTH)