

F.A.P. RTE.	SECTION	COUNTY	TOTAL SHEETS	SHEET NO.
704	(1)N & TS-1	McLEAN	497	120
STA. 10+300.000		TO STA. 10+600.000		
FED. ROAD DIST. NO.	ILLINOIS	FED. AID PROJECT		
			CONTRACT NO. 70514	

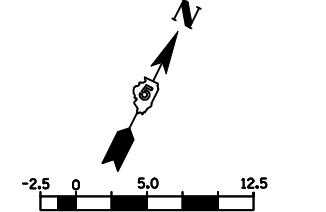

- LEGEND**
- TT TYPE III BARRICADE
  - ↑ SIGN
  - DRUM, BARRICADE OR VERTICAL BARRICADE WITH STEADY BURNING LIGHT
  - ▨ WORK AREA
  - ▩ TEMPORARY PAVEMENT
  - ⇨ DIRECTION OF TRAFFIC

**GENERAL STAGING NOTES**  
 MAINTAIN ACCESS TO ALL ADJACENT PROPERTIES THROUGHOUT THE DURATION OF THE PROJECT.  
 PLACE TYPE III BARRICADES IN ACCORDANCE WITH STANDARD 701901.  
 PROVIDE TEMPORARY MAILBOX SERVICE.

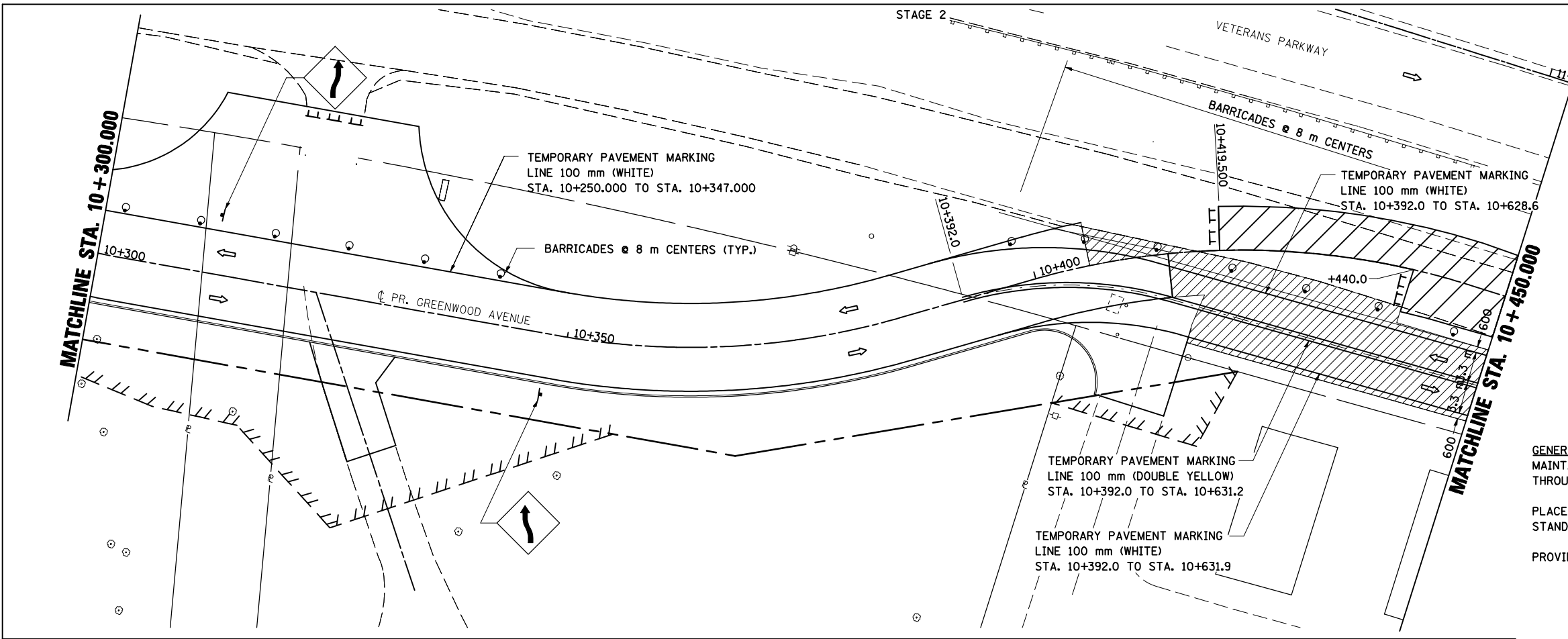
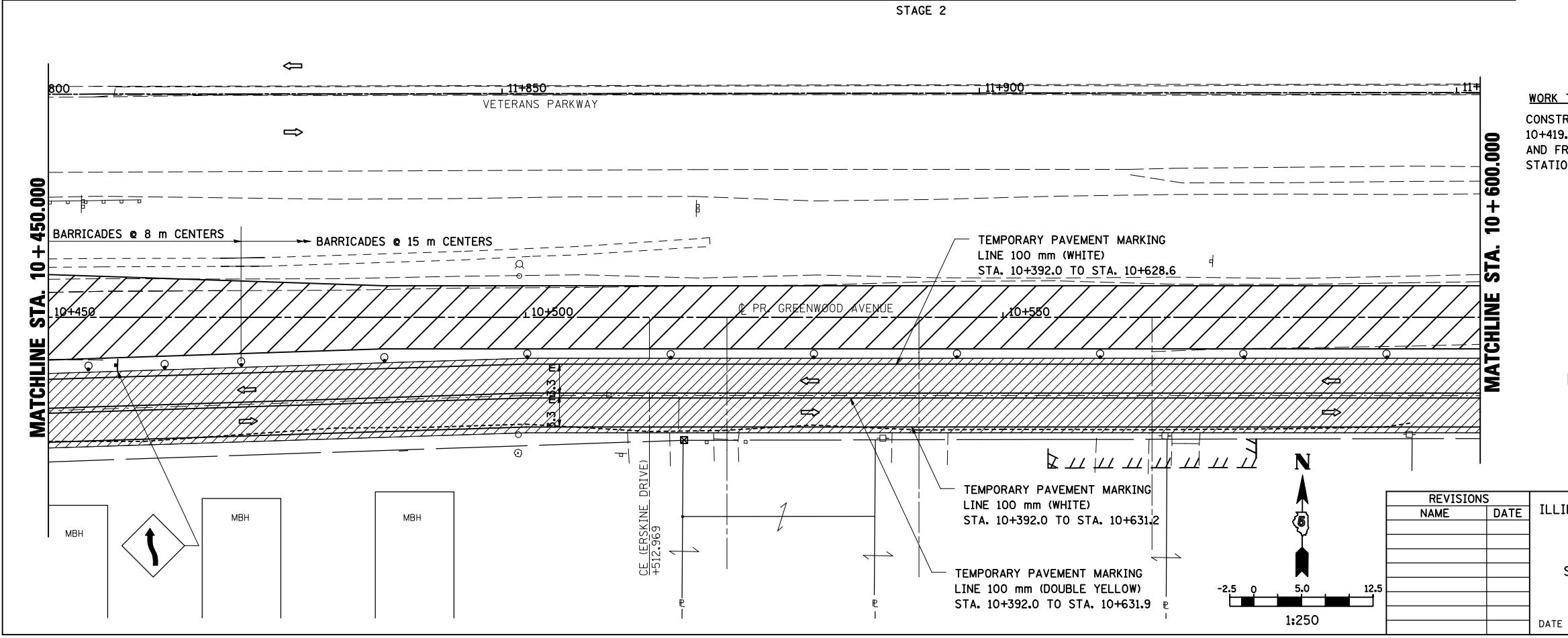

**WORK TO BE COMPLETED IN STAGE 2**  
 CONSTRUCT FINAL PAVEMENT FROM STATION 10+419.500 LEFT TO END OF CUL-DE-SAC AND FROM STATION 10+440.000 RIGHT TO STATION 10+634.000 RIGHT.

- LEGEND**
- ↑ SIGN
  - DRUM, BARRICADE OR VERTICAL BARRICADE WITH STEADY BURNING LIGHT
  - ▨ WORK AREA
  - ▩ TEMPORARY PAVEMENT
  - ⇨ DIRECTION OF TRAFFIC

REVISIONS	
NAME	DATE

ILLINOIS DEPARTMENT OF TRANSPORTATION  
**STAGING PLANS**  
 STAGE 2 GREENWOOD AVENUE (EAST)  
 DATE 05-27-09  
 DRAWN BY SAM  
 CHECKED BY PMH

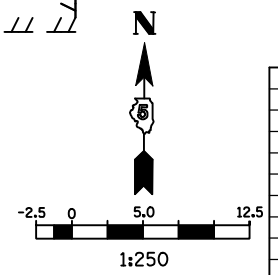

**STAGING PLANS, STAGE 2 GREENWOOD AVENUE (EAST)**

PLOT DATE = 8/12/2009  
 PLOT SCALE = 1:125000  
 USER NAME = craigie