

F.A.P. RTE.	SECTION	COUNTY	TOTAL SHEETS	SHEET NO.
704	(1)N & TS-1	MCLEAN	497	149
STA. 0+000.000		TO STA. 0+275.000		
FED. ROAD DIST. NO.	ILLINOIS	FED. AID PROJECT		
CONTRACT NO. 70514				

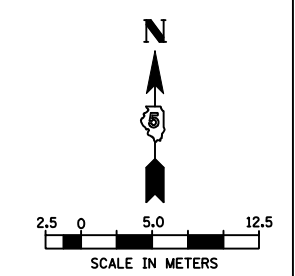
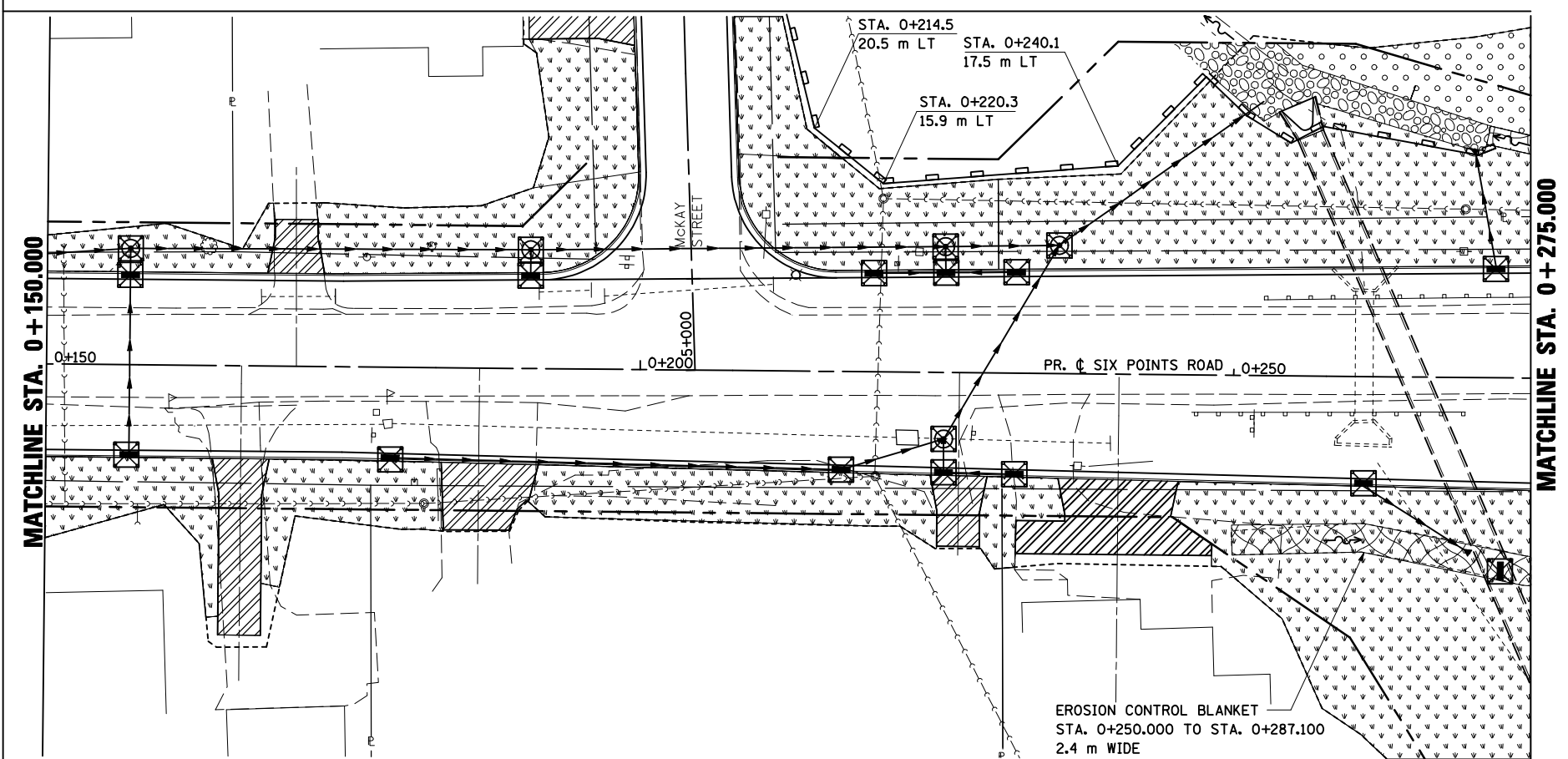
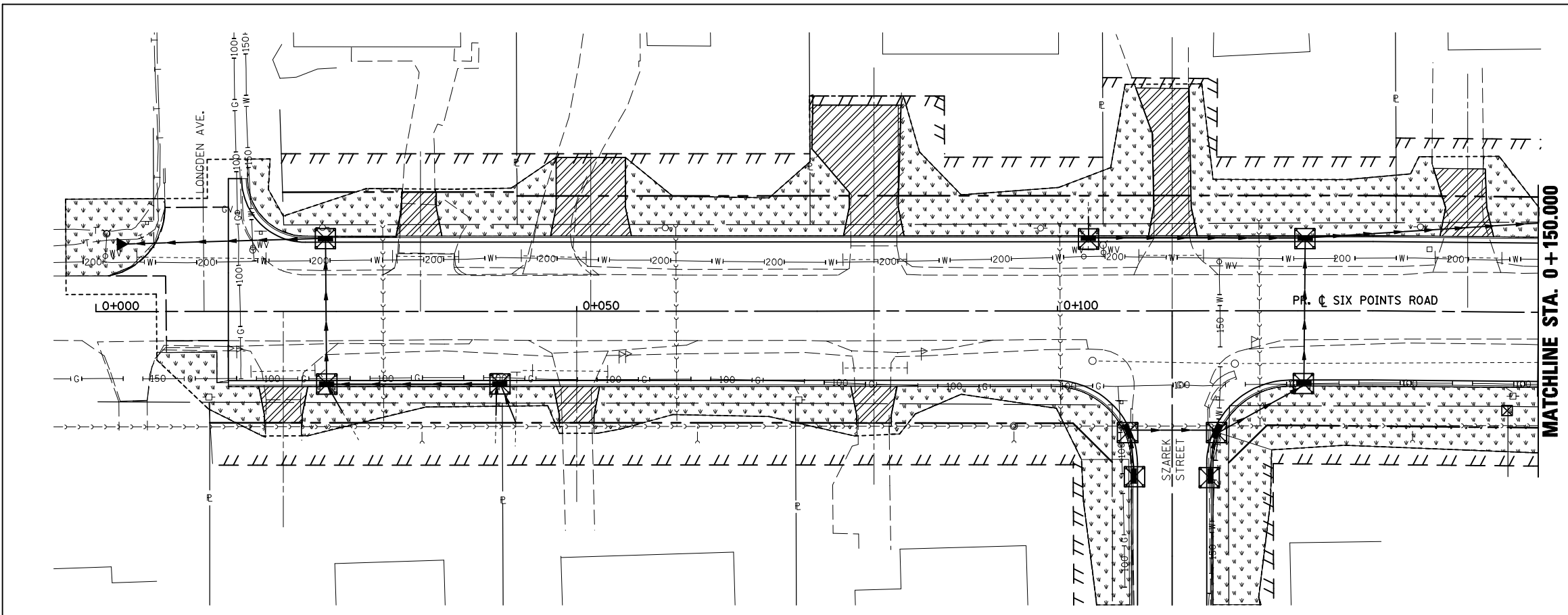
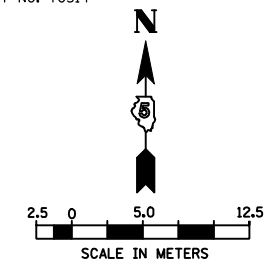

LEGEND

- PERIMETER EROSION BARRIER
- INLET AND PIPE PROTECTION
- EROSION CONTROL BLANKET
- SEEDING, CLASS 1 WITH MULCH METHOD 2

REVISIONS		ILLINOIS DEPARTMENT OF TRANSPORTATION
NAME	DATE	
		EROSION CONTROL SIX POINTS ROAD (WEST) DRAWN BY SAM CHECKED BY PMH DATE 05-27-09

PLOT DATE = 8/2/2009
 FILE NAME = c:\work\eroc\eroc\eroc.dwg
 PLOT SCALE = 1:315000 m / in.
 USER NAME = craig

SIX POINTS ROAD, EROSION CONTROL, STA. 0 + 000.000 TO STA. 0 + 275.000