

F.A.P. RTE.	SECTION	COUNTY	TOTAL SHEETS	SHEET NO.
704	(1)N & TS-1	McLEAN	497	164
STA. 2+600.000		TO STA. 2+750.000		
FED. ROAD DIST. NO.		ILLINOIS		FED. AID PROJECT

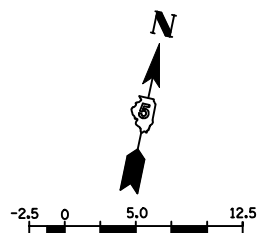

BY	DATE

FINAL SURVEY PLOTTED	NO.

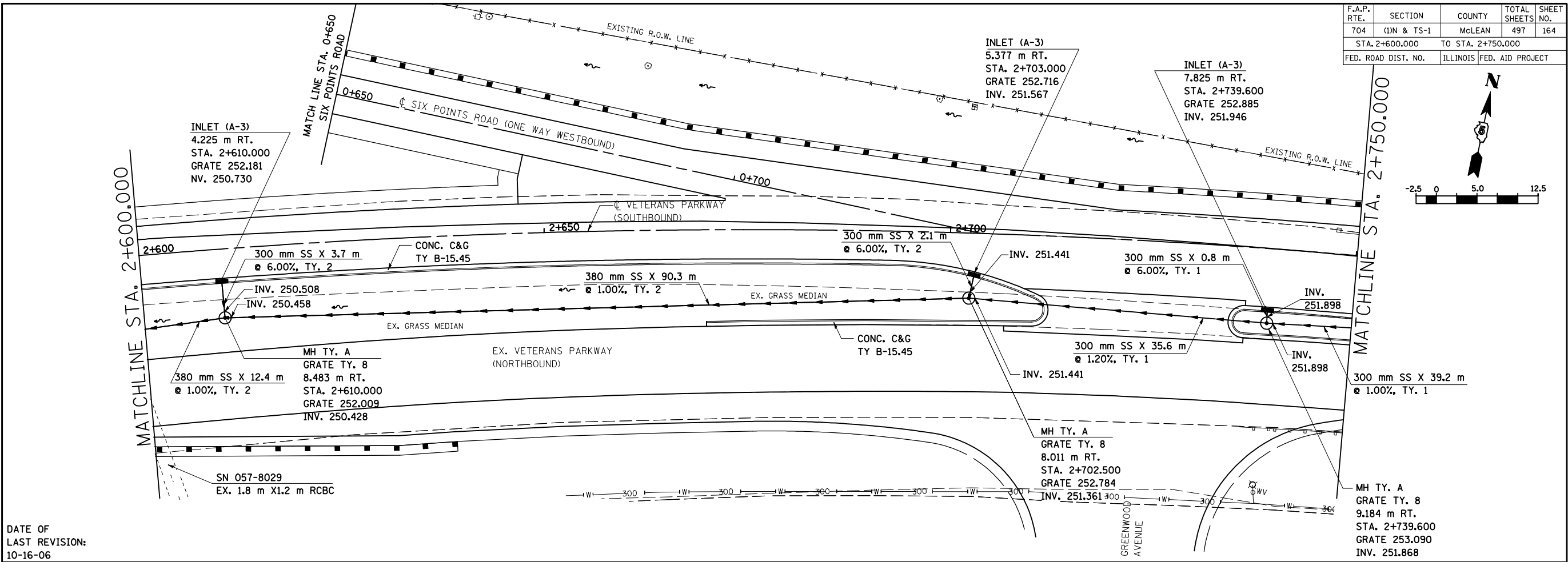

DATE OF
LAST REVISION:
10-16-06

BY	DATE

ORIGINAL SURVEY PLOTTED	NO.

