

F.A.P. RTE.	SECTION	COUNTY	TOTAL SHEETS	SHEET NO.
704	(1)N & TS-1	McLEAN	497	189
STA. 16+000.000		TO STA. 16+150.000		
FED. ROAD DIST. NO.	ILLINOIS			FED. AID PROJECT

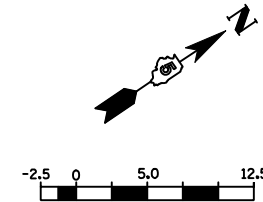

BY	DATE
FINAL SURVEYED	
SURVEY PLOTTED	
NOTE BOOK TEMPLATE	
AREAS	
CHECKED	
NO.	

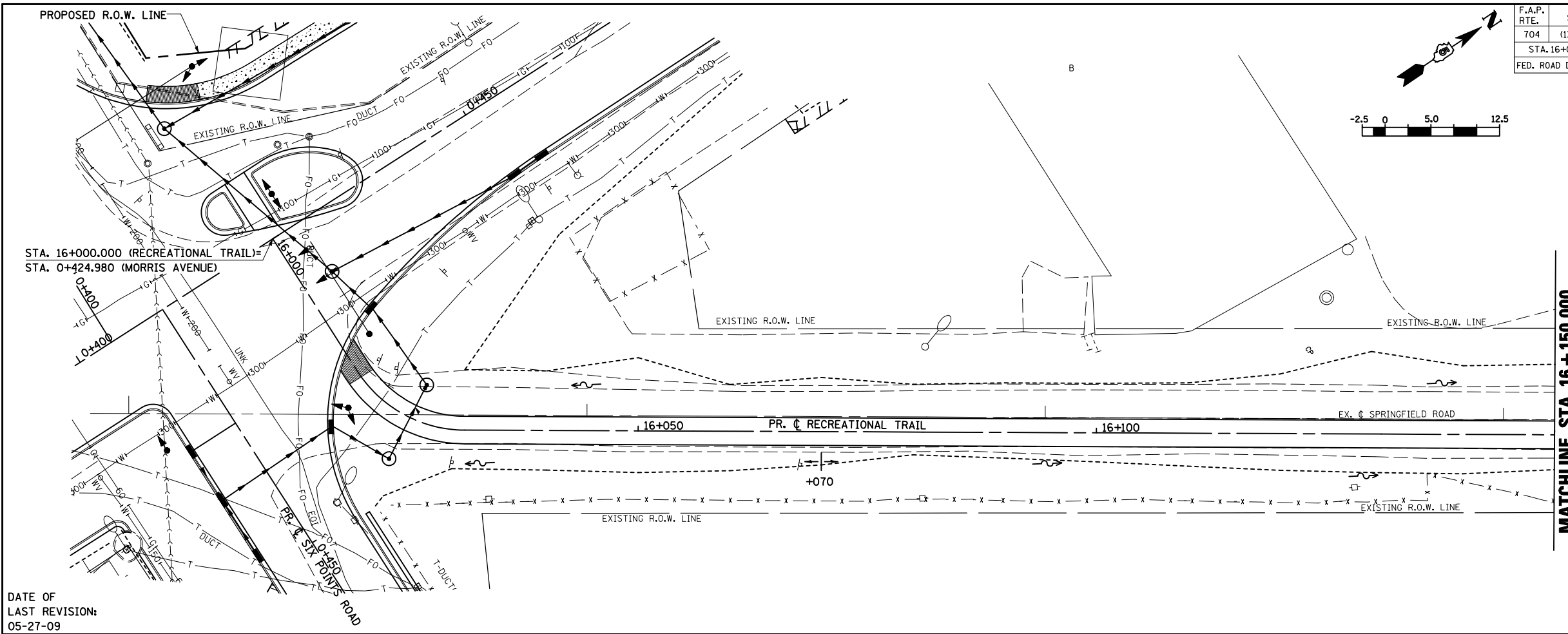

DATE OF
LAST REVISION:
05-27-09

ORIGINAL SURVEYED	
SURVEY PLOTTED	
NOTE BOOK TEMPLATE	
AREAS	
CHECKED	
NO.	

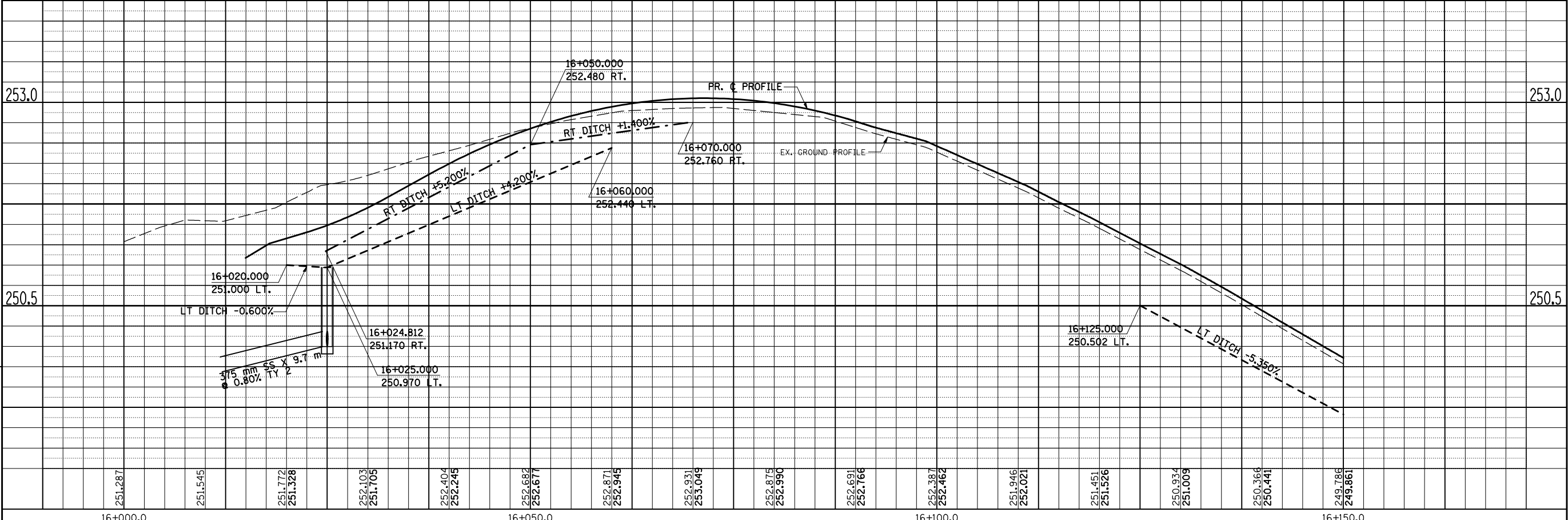

16+000.0 16+050.0 16+100.0 16+150.0