

F.A.P. RTE.	SECTION	COUNTY	TOTAL SHEETS	SHEET NO.
704	(1)N & TS-1	McLEAN	497	217
STA.		TO STA.		
FED. ROAD DIST. NO.		ILLINOIS FED. AID PROJECT		
CONTRACT NO. 70514				

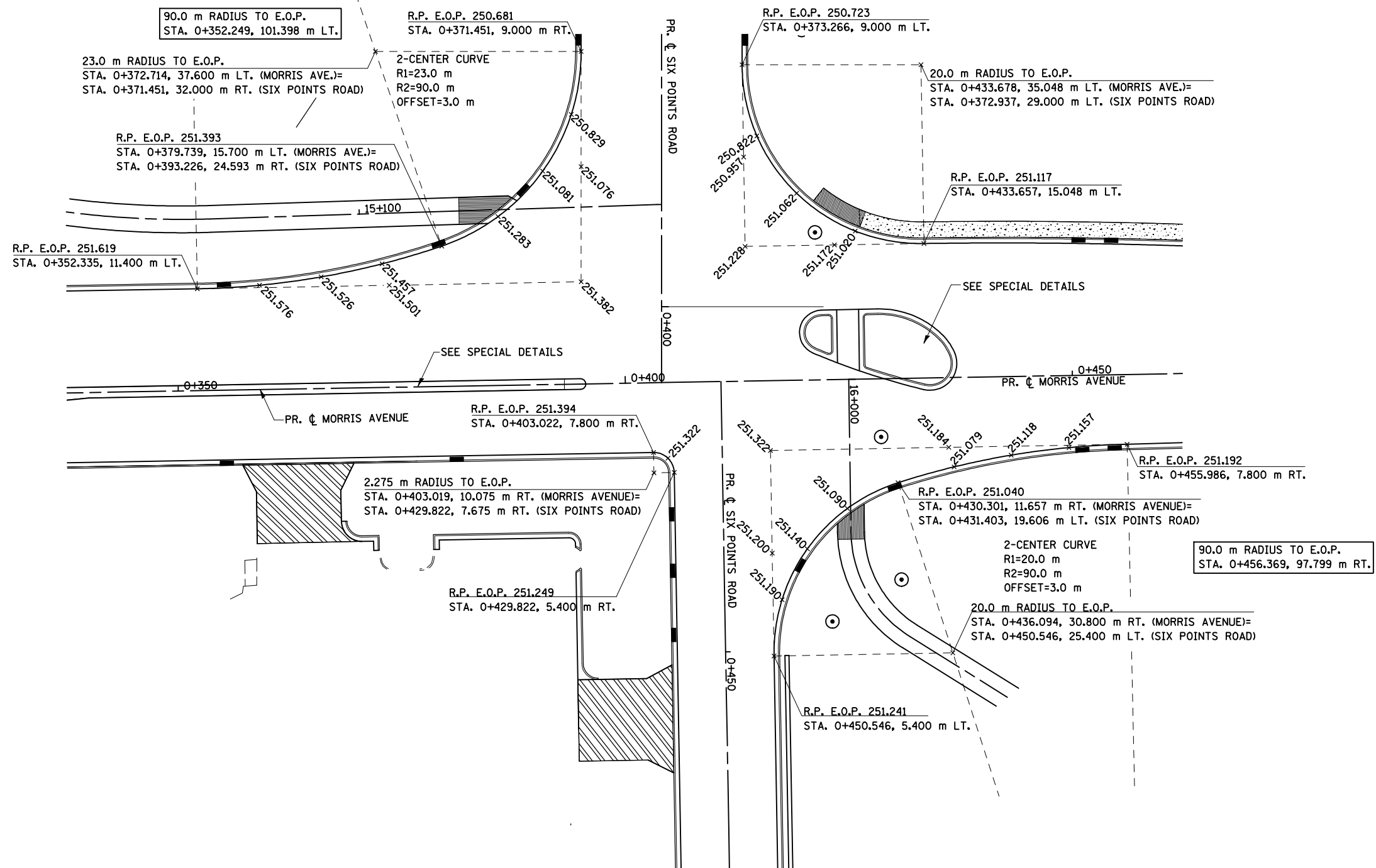
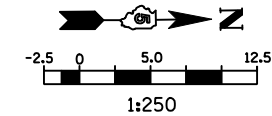

NOTES:

1. ALL PROPOSED CONCRETE CURB AND GUTTER SHOWN IS B-15.45 UNLESS NOTED OTHERWISE.
2. ELEVATIONS LISTED ALONG THE EDGE OF PAVEMENT BETWEEN THE RETURN POINTS ARE QUARTER POINTS OF THE TOTAL RADIUS LENGTH.

REVISIONS		ILLINOIS DEPARTMENT OF TRANSPORTATION
NAME	DATE	
		MORRIS AVE. AND SIX POINTS RD. INTERSECTION DETAILS
		<small>DRAWN BY SAM</small> <small>CHECKED BY PMH</small>
		<small>DATE 05-27-09</small>

MORRIS AVE. AND SIX POINTS RD. INTERSECTION DETAILS