

F.A.P. RTE.	SECTION	COUNTY	TOTAL SHEETS	SHEET NO.
704	(DN & TS-1	McLEAN	497	218
STA.		TO STA.		
FED. ROAD DIST. NO.		ILLINOIS	FED. AID PROJECT	
CONTRACT NO. 70514				

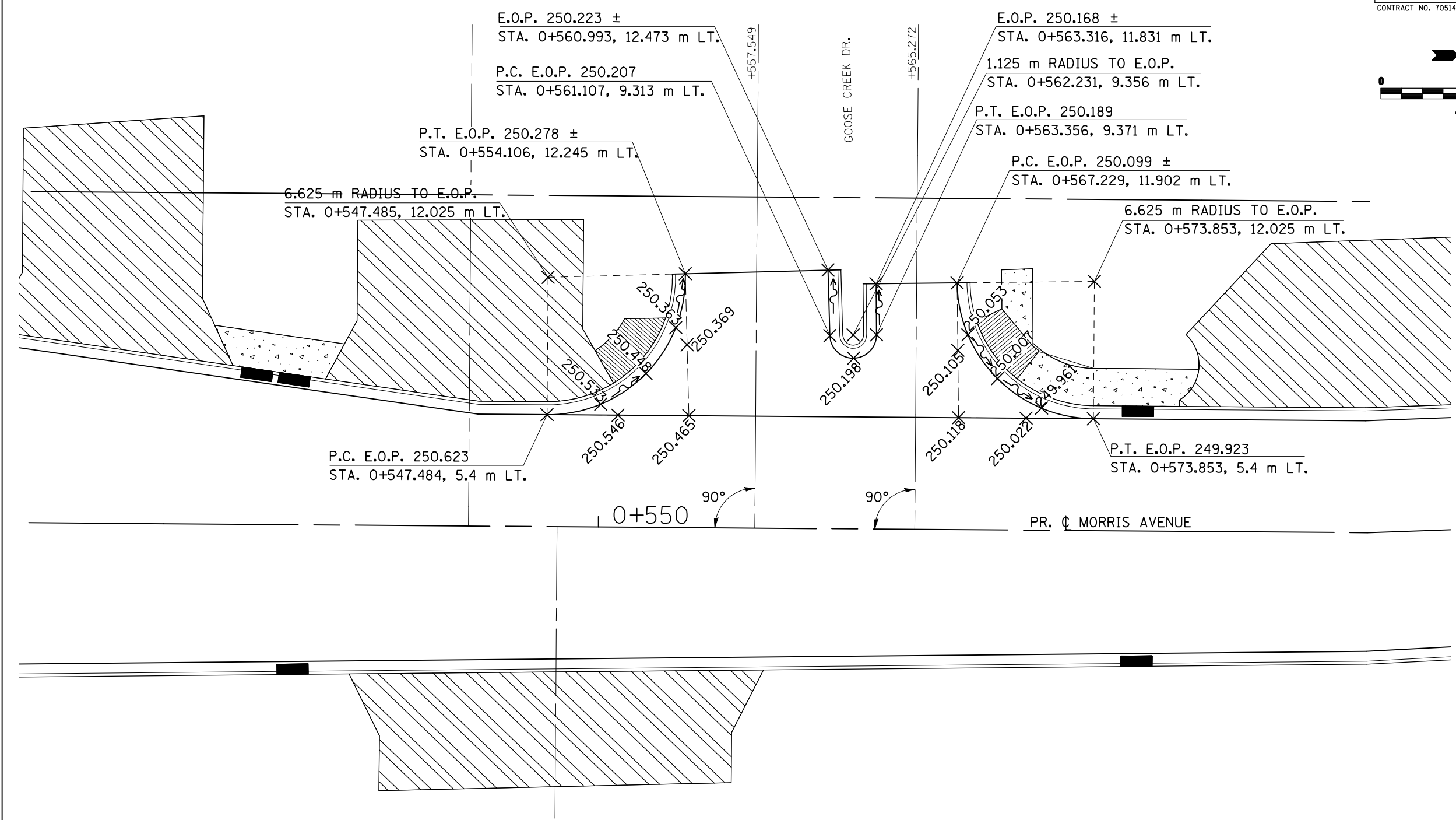
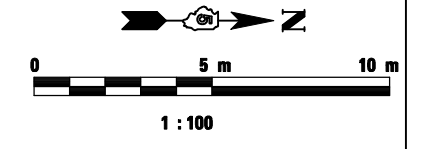

NOTES:

1. ALL PROPOSED CONCRETE CURB AND GUTTER SHOWN IS B-15.45 UNLESS NOTED OTHERWISE.
2. ELEVATIONS LISTED ALONG THE EDGE OF PAVEMENT BETWEEN THE RETURN POINTS ARE QUARTER POINTS OF THE TOTAL RADIUS LENGTH.

REVISIONS		ILLINOIS DEPARTMENT OF TRANSPORTATION
NAME	DATE	
		GOOSE CREEK DR. AND MORRIS AVE. INTERSECTION DETAILS
DATE 05-27-09		DRAWN BY SAM CHECKED BY PMH

GOOSE CREEK DR. AND MORRIS AVE. INTERSECTION DETAILS