

F.A.P. RTE. 704	SECTION (1)N&TS-1	COUNTY McLEAN	TOTAL SHEETS 497	SHEET NO. 361
STA. 0+020.000		TO STA. 0+050.000		
FED. ROAD DIST. NO.		ILLINOIS FED. AID PROJECT		
CONTRACT NO. 70514				253

BY	DATE
FINAL SURVEY NOTE BOOK NO.	SURVEYED PLOTTED AREAS CHECKED

BY	DATE
ORIGINAL SURVEY NOTE BOOK NO.	SURVEYED PLOTTED AREAS CHECKED

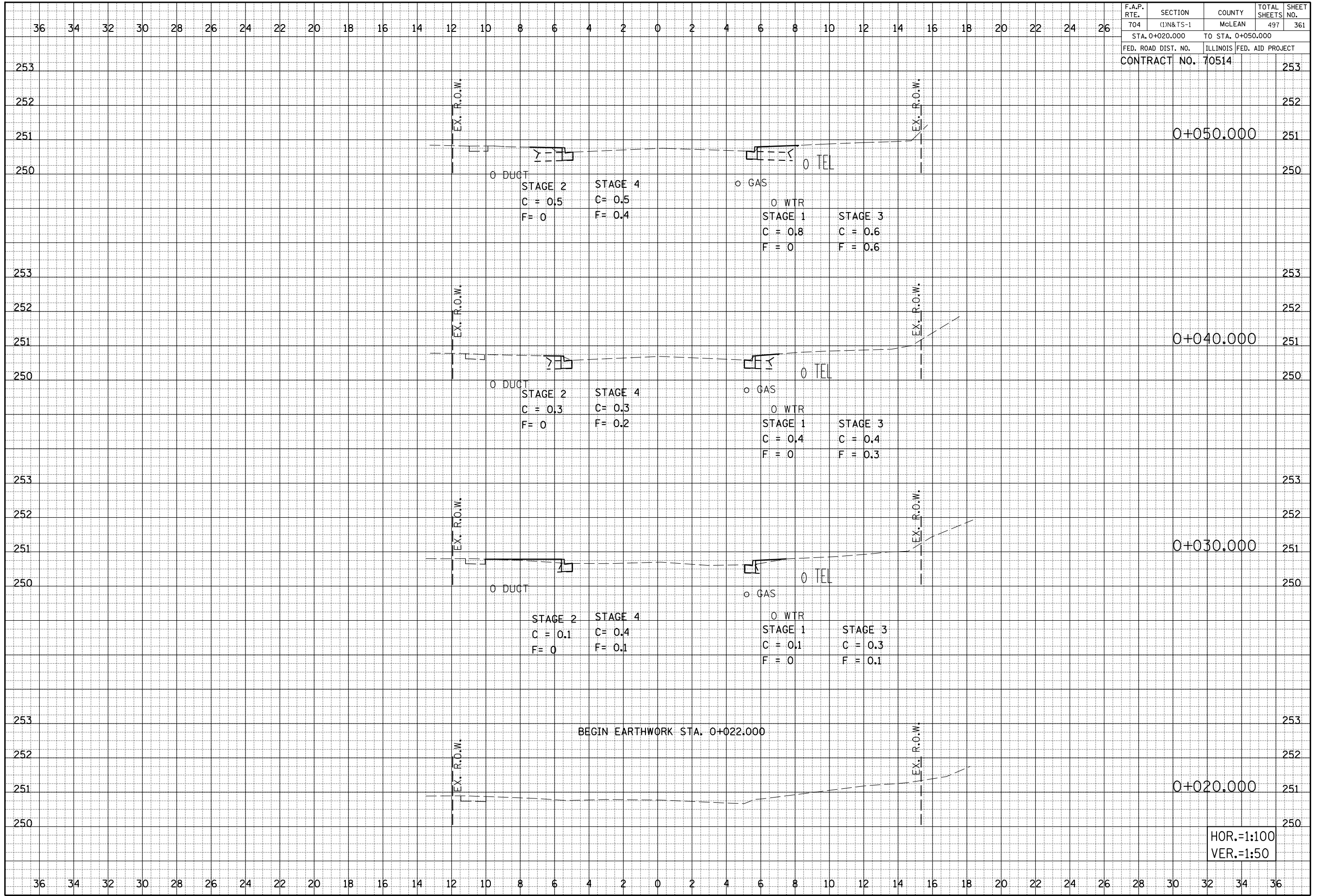

BEGIN EARTHWORK STA. 0+022.000

HOR.=1:100
VER.=1:50

MORRIS AVENUE SOUTH, CROSS SECTIONS, STA. 0+020.000 TO STA. 0+050.000