

F.A.P. RTE.	SECTION	COUNTY	TOTAL SHEETS	SHEET NO.
704	(1)N & TS-1	MCLEAN	497	366
STA. 0+160.000		TO STA. 0+180.000		
FED. ROAD DIST. NO.	ILLINOIS FED. AID PROJECT			

CONTRACT NO. 70514

BY	DATE
ORIGINAL SURVEY	SURVEYED
NOTE BOOK NO.	PLOTTED
	DATE
	AREAS
	CHECKED

BY	DATE
ORIGINAL SURVEY	SURVEYED
NOTE BOOK NO.	PLOTTED
	DATE
	AREAS
	CHECKED

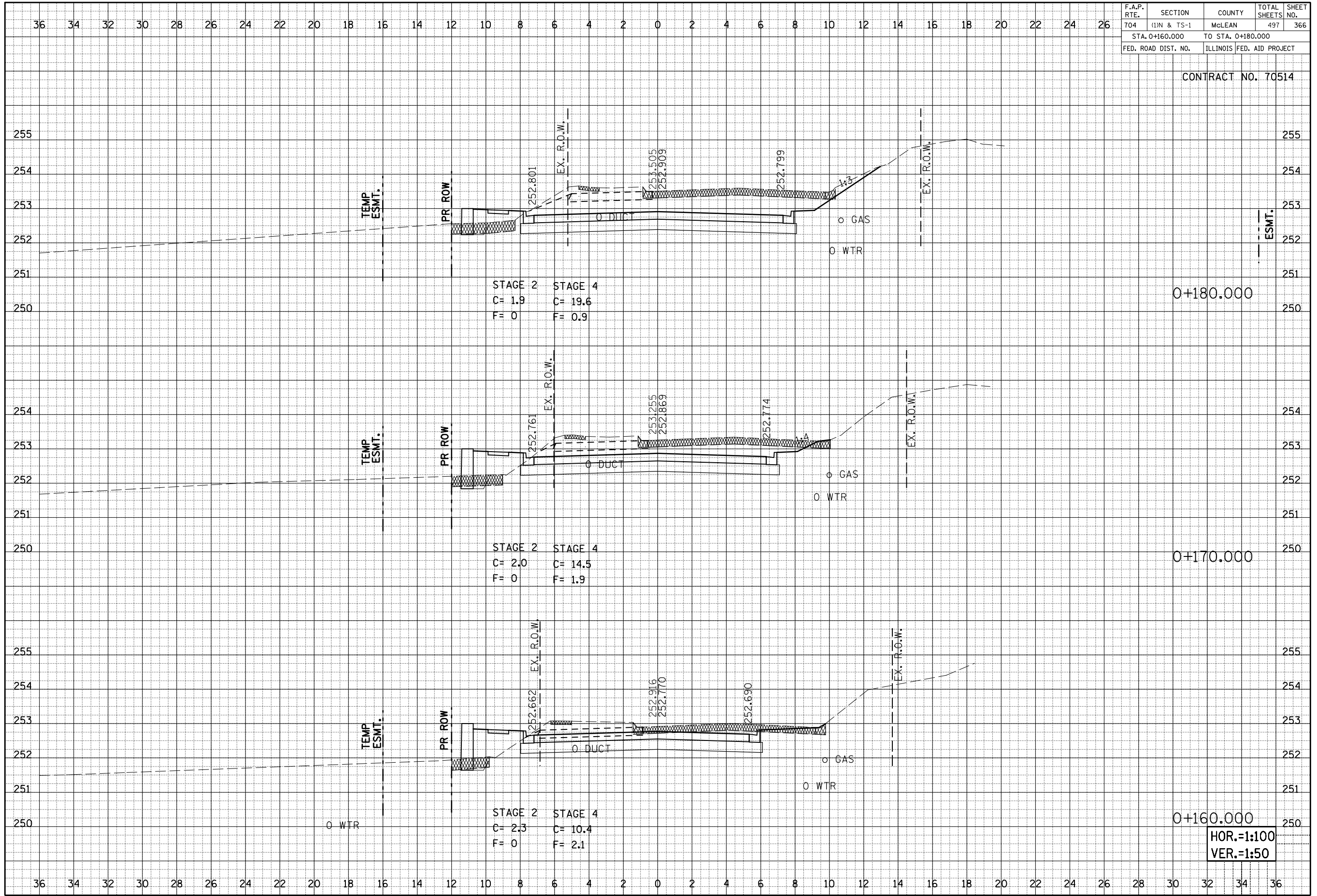

0+180.000

0+170.000

0+160.000

HOR.=1:100
 VER.=1:50

MORRIS AVENUE SOUTH, CROSS SECTIONS STA. 0+160.000 TO STA. 0+180.000