

F.A.P. RTE.	SECTION	COUNTY	TOTAL SHEETS	SHEET NO.
704	(1)N & TS-1	McLEAN	497	389
STA. 0+166.430 TO STA. 0+180.000				
FED. ROAD DIST. NO.		ILLINOIS FED. AID PROJECT		

BY	DATE

FINAL SURVEY NOTE BOOK NO.	SURVEYED PLOTTED AREAS	DATE

BY	DATE

ORIGINAL SURVEY NOTE BOOK NO.	SURVEYED PLOTTED AREAS	DATE

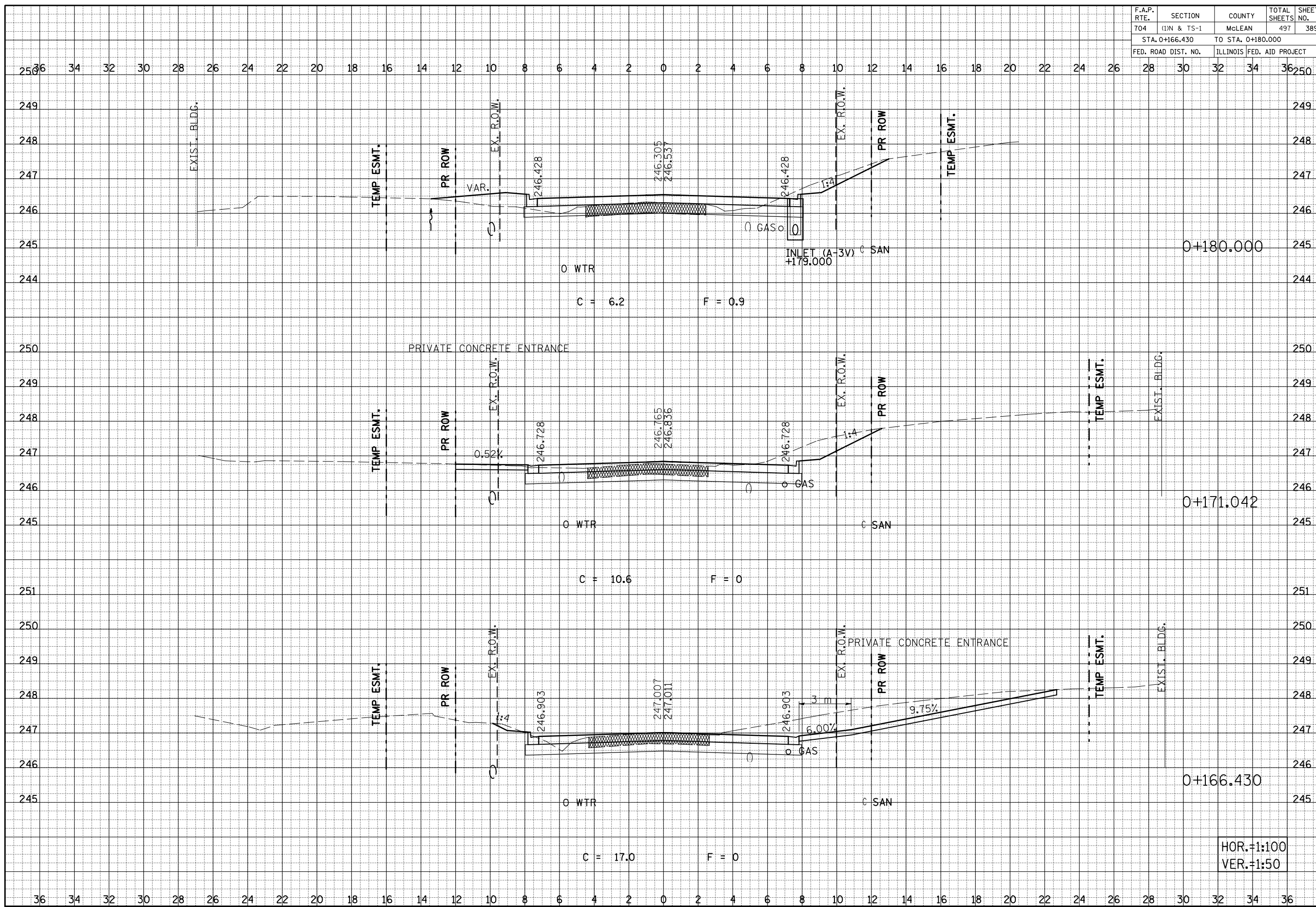

HOR.=1:100
VER.=1:50

SIX POINTS ROAD CROSS SECTIONS, STA. 0+166.430 TO STA. 0+180.000