

F.A.S. RTE.	SECTION	COUNTY	TOTAL SHEETS	SHEET NO.
704	(1)N & TS-1	MCLEAN	497	396
STA. 0+270.000		TO STA. 0+270.000		
FED. ROAD DIST. NO.		ILLINOIS FED. AID PROJECT		

BY	DATE

BY	DATE

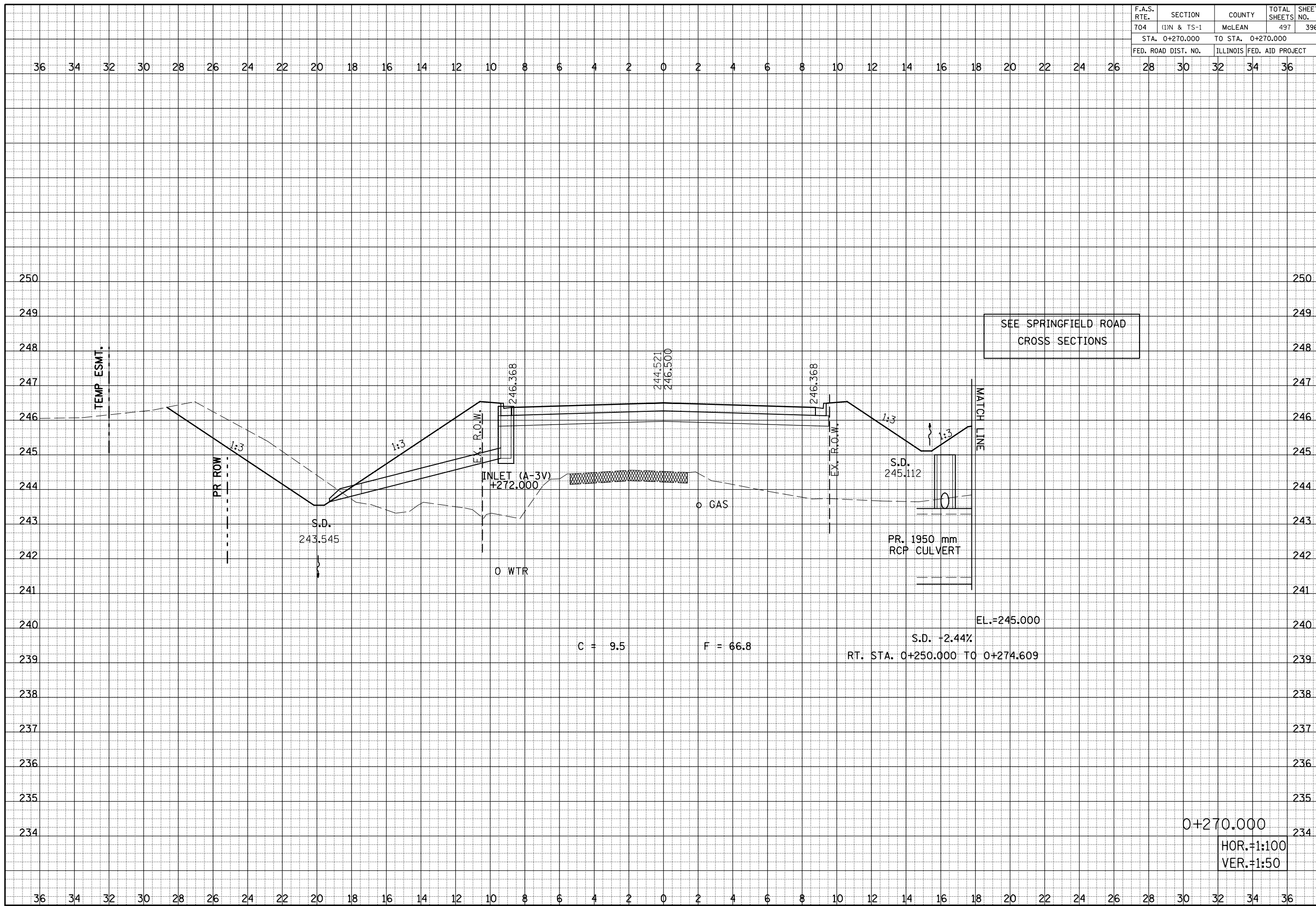

SEE SPRINGFIELD ROAD
CROSS SECTIONS

EL.=245.000
S.D. +2.44%
RT. STA. 0+250.000 TO 0+274.609

0+270.000
HOR.=1:100
VER.=1:50

SIX POINTS ROAD CROSS SECTIONS, STA. 0+270.000