

F.A.P. RTE.	SECTION	COUNTY	TOTAL SHEETS	SHEET NO.
704	(1)N&TS-1	McLEAN	497	418
STA. 0+860.000		TO STA. 0+870.000		
FED. ROAD DIST. NO.		ILLINOIS FED. AID PROJECT		
28		30 32 34 36		
CONTRACT NO. 70514				

BY _____	DATE _____
ORIGINAL SURVEY _____	PLOTTED _____
NOTE BOOK _____	AREAS CHECKED _____
NO. _____	AREAS CHECKED _____

BY _____	DATE _____
ORIGINAL SURVEY _____	PLOTTED _____
NOTE BOOK _____	AREAS CHECKED _____
NO. _____	AREAS CHECKED _____

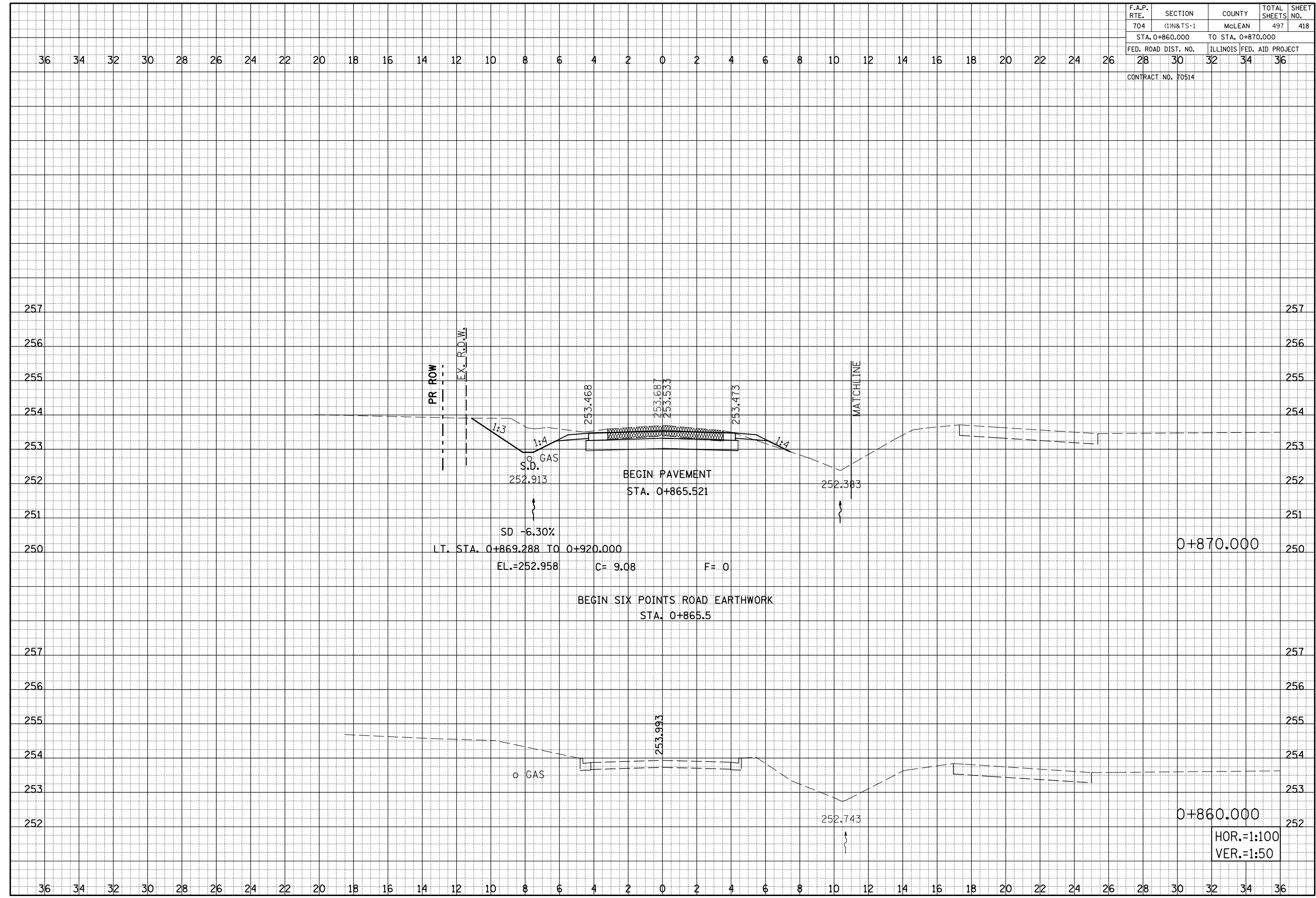

SPRINGFIELD ROAD, CROSS SECTIONS, STA. 0+860.000 TO STA. 0+870.000