

STAGE II CONSTRUCTION

TYPICAL SECTION STAGE II  
ENDS STA. 618+35

TYPICAL SECTION STAGE II  
BEGINS STA. 618+35

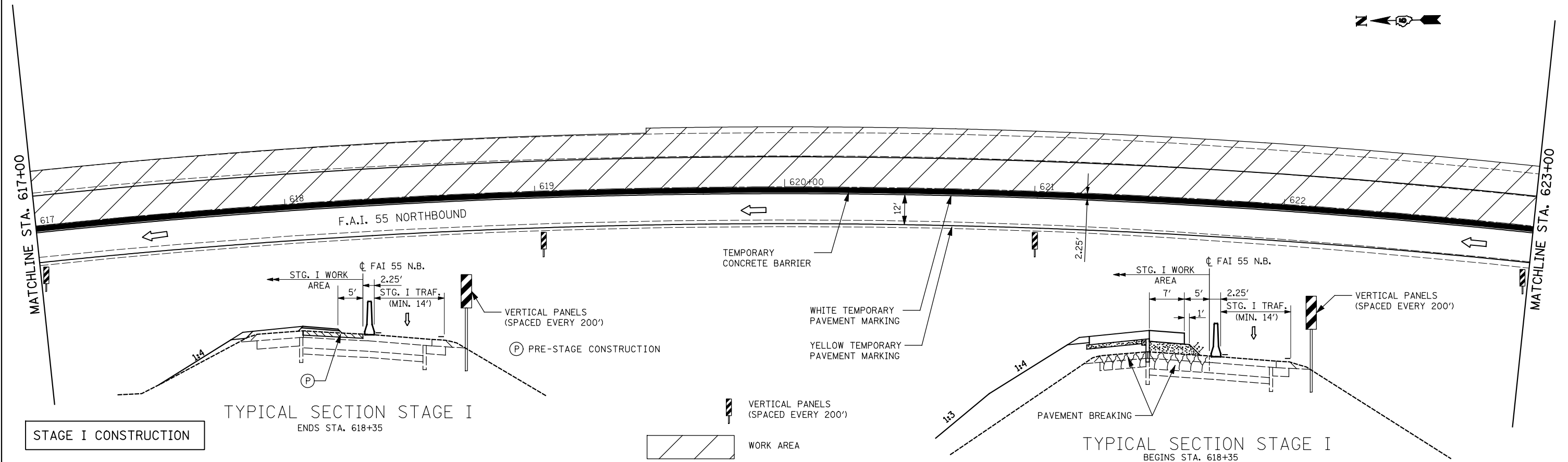

STAGE I CONSTRUCTION

TYPICAL SECTION STAGE I  
ENDS STA. 618+35

TYPICAL SECTION STAGE I  
BEGINS STA. 618+35

FILE NAME =	USER NAME = SJS	DESIGNED -	REVISED -
... \D570520-shr-staging.dgn		DRAWN -	REVISED -
	PLOT SCALE = 40.0000' / IN.	CHECKED -	REVISED -
	PLOT DATE = 08/09/2010 10:55:09	DATE -	REVISED -

**STATE OF ILLINOIS  
DEPARTMENT OF TRANSPORTATION**

<b>STAGING PLANS F.A.I. 55 NORTHBOUND</b>			
SCALE: 1" = 20'	SHEET NO.	OF SHEETS	STA. 617+00 TO STA. 623+00

F.A.I. RTE. 55	SECTION (57-7HB-2 & 57-7HB-1)BR	COUNTY MCLEAN	TOTAL SHEETS 153	SHEET NO. 34
CONTRACT NO. 70520				ILLINOIS FED. AID PROJECT