

NOTES:
 UTILIZE TRAFFIC CONTROL STANDARD 701400 & 701406 FOR PLACEMENT OF TEMPORARY CONCRETE BARRIERS. (FLAGGER REQUIRED UNTIL BARRIER PLACEMENT COMPLETED).

BARRIER WALL REFLECTORS, TYPE C, SHALL BE MOUNTED ON THE TANGENT PORTIONS OF THE TEMPORARY CONCRETE BARRIERS AS SHOWN IN STANDARD 704001. REFLECTORS ON RIGHT SHALL BE CRYSTAL, REFLECTORS ON LEFT SHALL BE AMBER. INCLUDED IN THE COST OF TC&P (SPECIAL) LOCATION 1.

APPLICABLE PORTIONS OF TRAFFIC CONTROL STANDARD 701400 SHALL REMAIN IN PLACE WHEN TC&P (SPECIAL) LOCATION 1 IS IN USE.

① LANE SHIFT (STRIPING) = L/2
 $L/2 = (55)(2)/2 = 55'$ FOR LEFT EDGE STRIPE
 $L/2 = (55)(1)/2 = 27.5'$ FOR CENTER STRIPE

IMPACT ATTENUATOR

(4) VERTICAL PANELS W/LIGHTS @ 25' CTRS. ON TEMPORARY CONCRETE BARRIER WALLS THE LAST 100' OF TAPER PRIOR TO TANGENT.

IMPACT ATTENUATORS, TEMPORARY (NON-REDIRECTIVE NARROW), TEST LEVEL 3

TEMPORARY CONCRETE BARRIER

LIMITS OF BRACED EXCAVATION

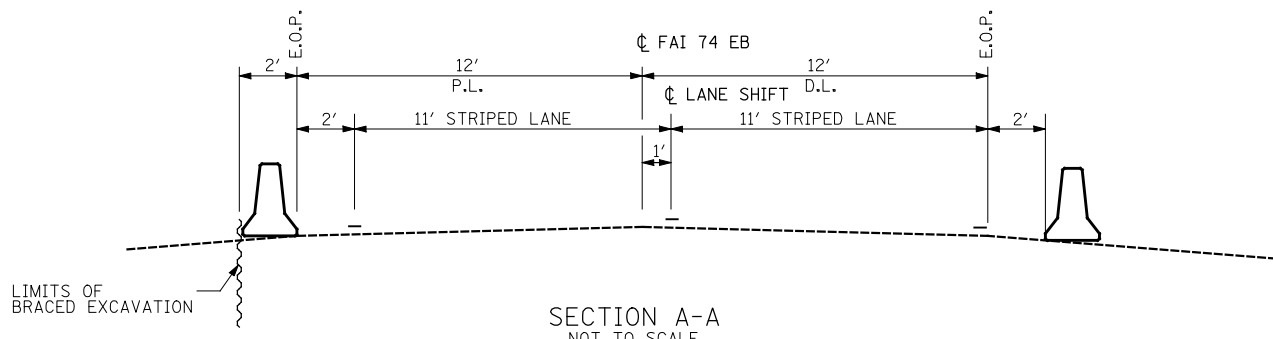
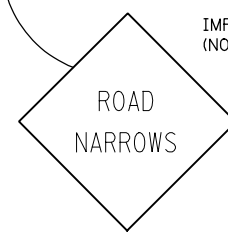
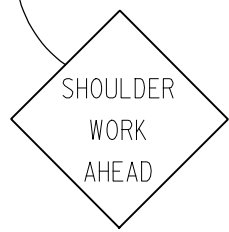
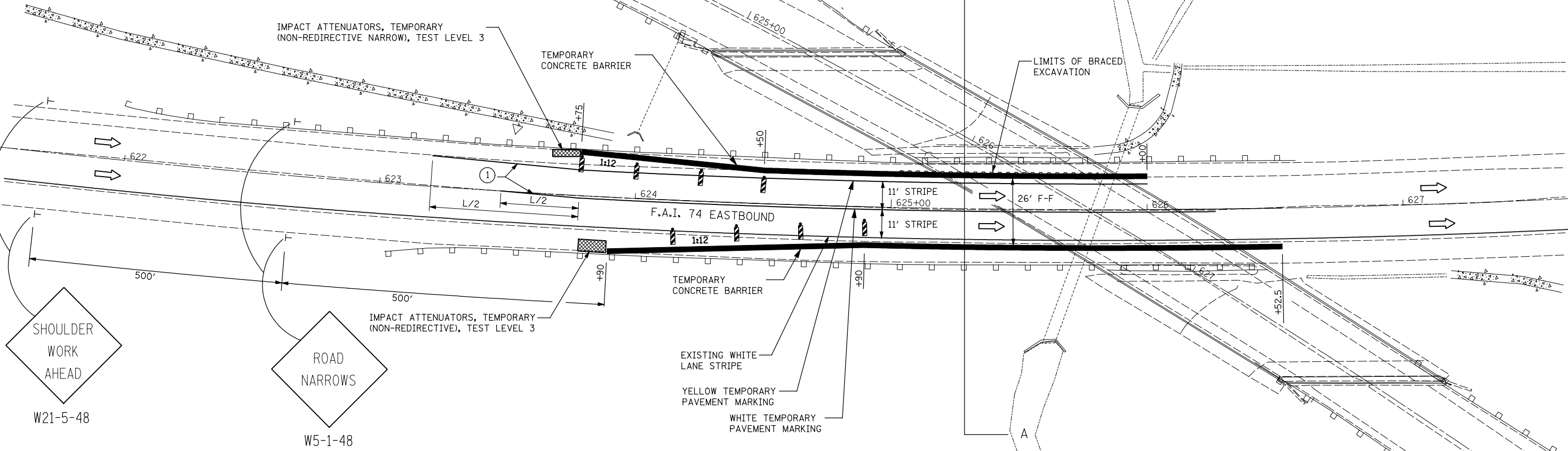

FILE NAME =	USER NAME = SJS	DESIGNED -	REVISED -
... \D570520-sht-TCPI(Special).dgn		DRAWN -	REVISED -
		CHECKED -	REVISED -
		DATE -	REVISED -

STATE OF ILLINOIS
 DEPARTMENT OF TRANSPORTATION

TRAFFIC CONTROL AND PROTECTION
 (SPECIAL) LOCATION 1

F.A.I. RTE.	SECTION	COUNTY	TOTAL SHEETS	SHEET NO.
55	(57-7HB-2 & 57-7HB-1)BR	MCLEAN	153	43
CONTRACT NO. 70520				
ILLINOIS FED. AID PROJECT				

SCALE: SHEET NO. OF SHEETS STA. TO STA.