

STATE OF ILLINOIS  
DEPARTMENT OF TRANSPORTATION

LEFT CURB LINE

Location	Station	Offset	Theoretical Grade Elevations	Theoretical Grade Elevations Adjusted For Grinding
End N. Aprr Slab	625+32.98	-24.00	811.89	811.91
A1	625+42.60	-24.00	811.93	811.95
B1	625+52.23	-24.00	811.97	811.99
End N. Aprr Slab	625+61.86	-24.00	812.00	812.02
End S. Aprr Slab	628+44.36	-24.00	813.13	813.15
A2	628+54.09	-24.00	813.17	813.19
B2	628+63.83	-24.00	813.21	813.23
End S. Aprr Slab	628+73.58	-24.00	813.17	813.19

LEFT EDGE OF PAVEMENT

Location	Station	Offset	Theoretical Grade Elevations	Theoretical Grade Elevations Adjusted For Grinding
End N. Aprr Slab	625+10.45	-12.00	811.43	811.45
A1	625+20.26	-12.00	811.47	811.49
B1	625+30.06	-12.00	811.50	811.53
End N. Aprr Slab	625+39.88	-12.00	811.54	811.56
End S. Aprr Slab	628+26.79	-12.00	812.69	812.71
A2	628+36.66	-12.00	812.73	812.75
B2	628+46.53	-12.00	812.77	812.79
End S. Aprr Slab	628+56.39	-12.00	812.81	812.83

STAGE CONSTRUCTION JOINT

Location	Station	Offset	Theoretical Grade Elevations	Theoretical Grade Elevations Adjusted For Grinding
End N. Aprr Slab	624+97.06	-5.00	811.16	811.18
A1	625+06.98	-5.00	811.20	811.22
B1	625+16.90	-5.00	811.24	811.26
End N. Aprr Slab	625+26.82	-5.00	811.28	811.30
End S. Aprr Slab	628+16.40	-5.00	812.43	812.45
A2	628+26.35	-5.00	812.47	812.49
B2	628+36.29	-5.00	812.51	812.53
End S. Aprr Slab	628+46.24	-5.00	812.55	812.57

ROADWAY & PROFILE GRADE

Location	Station	Offset	Theoretical Grade Elevations	Theoretical Grade Elevations Adjusted For Grinding
End N. Aprr Slab	624+87.39	0.00	810.96	810.98
A1	624+97.39	0.00	811.00	811.02
B1	625+07.39	0.00	811.04	811.06
End N. Aprr Slab	625+17.39	0.00	811.08	811.10
End S. Aprr Slab	628+08.92	0.00	812.25	812.27
A2	628+18.92	0.00	812.29	812.31
B2	628+28.92	0.00	812.33	812.35
End S. Aprr Slab	628+38.92	0.00	812.37	812.39

RIGHT EDGE OF PAVEMENT

Location	Station	Offset	Theoretical Grade Elevations	Theoretical Grade Elevations Adjusted For Grinding
End N. Aprr Slab	624+63.76	12.00	810.50	810.52
A1	624+73.96	12.00	810.54	810.56
B1	624+84.16	12.00	810.58	810.60
End N. Aprr Slab	624+94.36	12.00	810.62	810.64
End S. Aprr Slab	627+90.72	12.00	811.80	811.82
A2	628+00.86	12.00	811.84	811.86
B2	628+10.99	12.00	811.88	811.90
End S. Aprr Slab	628+21.13	12.00	811.92	811.94

RIGHT CURB LINE

Location	Station	Offset	Theoretical Grade Elevations	Theoretical Grade Elevations Adjusted For Grinding
End N. Aprr Slab	624+51.72	18.00	810.26	810.28
A1	624+62.03	18.00	810.30	810.32
B1	624+72.34	18.00	810.34	810.37
End N. Aprr Slab	624+82.64	18.00	810.39	810.41
End S. Aprr Slab	627+81.49	18.00	811.58	811.60
A2	627+91.70	18.00	811.62	811.64
B2	628+01.91	18.00	811.66	811.68
End S. Aprr Slab	628+12.12	18.00	811.70	811.72

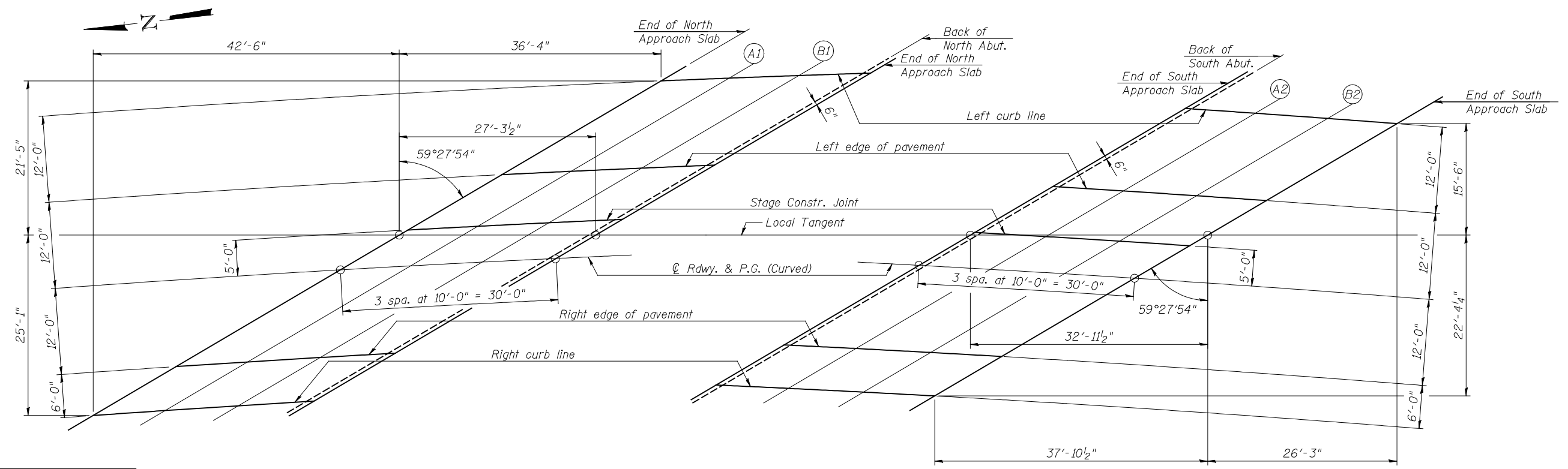

PLAN

TOP OF APPROACH  
SLAB ELEVATIONS  
STRUCTURE NO. 057-0250

**JD** Johnson, Depp & Quisenberry  
CONSULTING ENGINEERS  
Springfield, Illinois

DESIGNED: DCD	DRAWN: SJS
CHECKED: CMV	CHECKED: CMV/DCD

E-AS1 11-1-09

SHEET 7 OF 27	F.A.I. RTE. 55	SECTION (57-7HB-1)BR	COUNTY MCLEAN	TOTAL SHEETS 153	SHEET NO. 57
STA. 626+53.70			CONTRACT NO. 70520		
FED. ROAD DIST. NO. ILLINOIS FED. AID PROJECT					

PRINT DATE: 08/06/2010 20:56:44 SAVE DATE: 8/5/2010 USER: DCD  
 FILE: J:\JDO\10169\_IL-D5\_1-55NB\_McLean\1155NB-174EB\0570250-70520-007-ops\slabelev.dgn