

W12-2(0)-48"x48" (1200x1200)

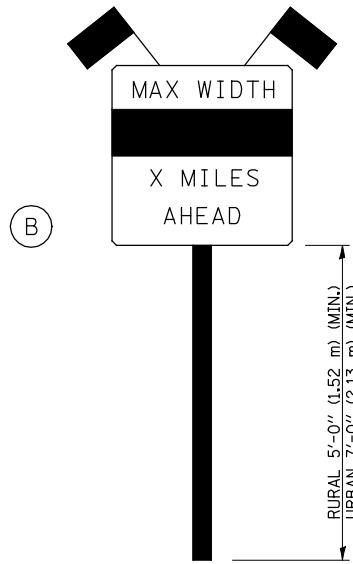

SIGN PANEL, TYPE II

(B)

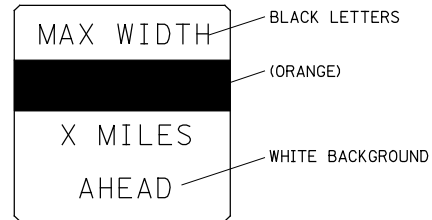

W12-I103(0)-48"x48" (1200x1200)
"D" LETTERS/NUMBERS

SIGN (A) 2 SIGNS - W12-2(0)-48"x48" (1200x1200) ARE TO BE PLACED AS SHOWN IN THE PLANS OR AS DIRECTED BY THE ENGINEER.

SIGN (B) 2 SIGNS - (SIGN PANEL, TYPE II) AS SHOWN ARE TO BE PLACED AS SHOWN IN THE PLANS OR AS DIRECTED BY THE ENGINEER.

GENERAL NOTES

1. ALL TRAFFIC CONTROL DEVICES SHALL BE FURNISHED, ERECTED AND MAINTAINED BY THE CONTRACTOR.
2. ALL (B) SIGNS SHALL HAVE FLAGS INSTALLED UNLESS OTHERWISE DIRECTED.
3. LOCATIONS OF TRAFFIC CONTROL DEVICES MAY BE ADJUSTED BY THE ENGINEER.
4. ALL TRAFFIC CONTROL SHOWN ON THIS SHEET SHALL BE PAID FOR AT THE CONTRACT LUMP SUM PRICE FOR WIDTH RESTRICTION SIGNING.
5. ALL SIGNS SHALL BE POST MOUNTED UNLESS OTHERWISE DIRECTED.
6. ALL SIGNS SHOWN ORANGE (O) SHALL BE FLUORESCENT ORANGE.

Note: All dimensions are in INCHES (millimeters) unless otherwise shown.

DISTRICT 5 DETAIL NO. X7200201

FILE NAME =	USER NAME = SJS	DESIGNED -	REVISED - 11/06
... \D570520-sht-details.dgn		DRAWN -	REVISED - 05/08
	PLOT SCALE = 100.0000' / IN.	CHECKED -	REVISED - 10/08 - KJT
	PLOT DATE = 08/09/2010 10:57:00	DATE -	REVISED - 7/09 - KJT

**STATE OF ILLINOIS
DEPARTMENT OF TRANSPORTATION**

**WIDTH RESTRICTION SIGNING,
I-74 EB SWITCHBACK DETAIL**

SCALE: SHEET NO. OF SHEETS STA. TO STA.

F.A.I. RTE.	SECTION	COUNTY	TOTAL SHEETS	SHEET NO.
55	(57-7HB-2 & 57-7HB-1)BR	MCLEAN	153	117
CONTRACT NO. 70520				
FED. ROAD DIST. NO. ILLINOIS FED. AID PROJECT				

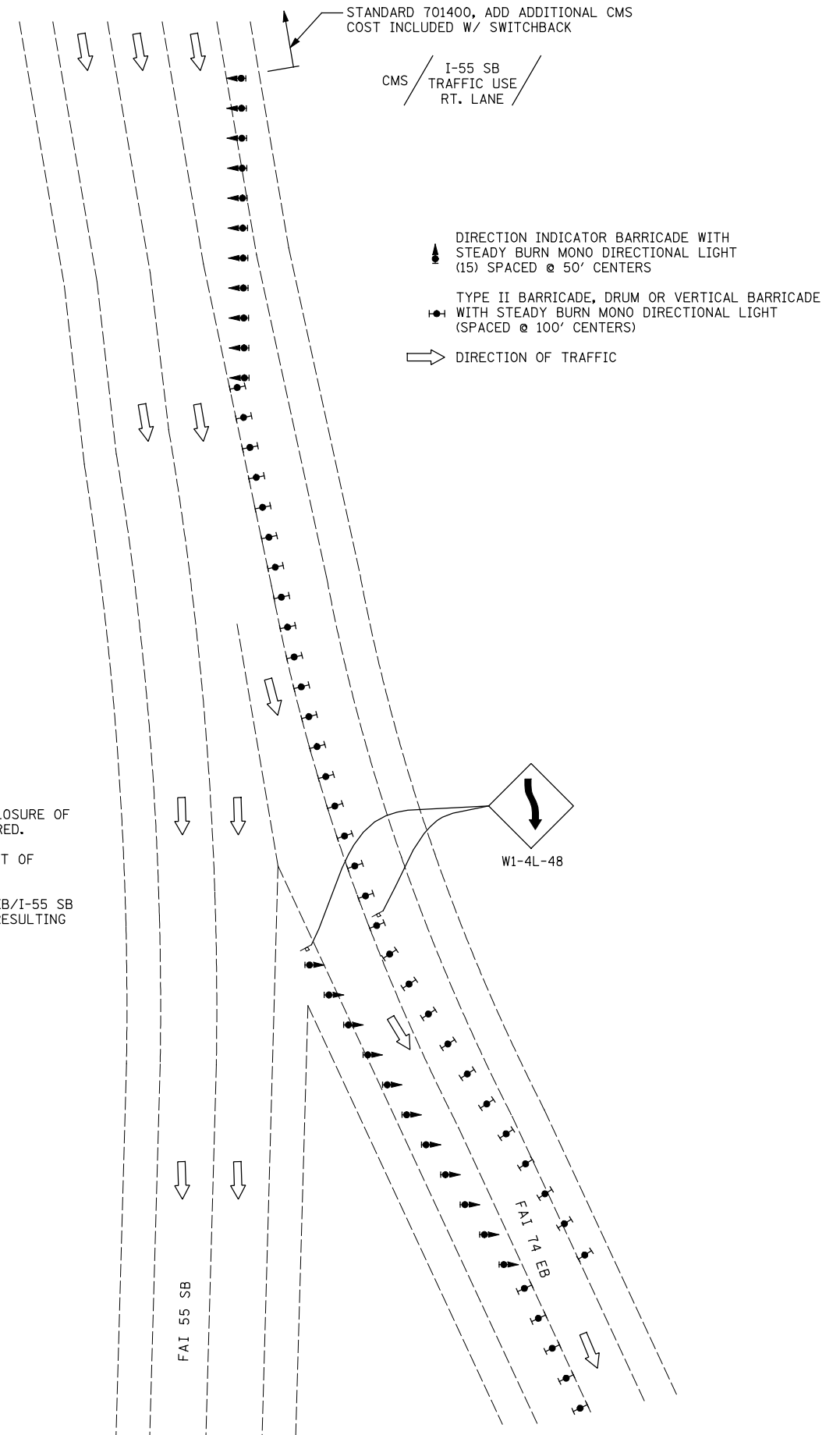

- NOTES:
1. THIS DETAIL IS TO BE USED WHEN CLOSURE OF THE I-74 EB DRIVING LANE IS REQUIRED.
 2. SWITCHBACK DETAIL INCLUDED IN COST OF STANDARD 701406.
 3. INTERIOR LANES UPSTREAM OF I-74 EB/I-55 SB SPLIT MAY NOT BE CLOSED DUE TO RESULTING TRAFFIC QUEUE LENGTHS.

I-74 EB SWITCHBACK
DETAIL