

F.A. RTE.	SECTION	COUNTY	TOTAL SHEETS	SHEET NO.
315	(28)N,TS	HANCOCK	78	20
STA. 74+60.84 TO STA. 79+50				
FED. ROAD DIST. NO. ILLINOIS FED. AID PROJECT				

SW 1/4, SEC. 18, T-5N, R-6W, 4TH P.M.  
 SEE SHEETS 29-32 FOR TRAFFIC SIGNAL DETAILS AND LOCATIONS  
 SEE SHEET 24 FOR INTERSECTION GEOMETRICS

STA 654+75.00 - 33.6' LT  
 REMOVE EXISTING INLET  
 INSTALL 5' RD MH, TYPE 1 FR, CLSD LID  
 7.0 CY CLSM  
 TOP - 670.28  
 ? - 665.20

BM\*103 = 60D SPIKE NAIL IN P.P. IN FRONT OF HOUSE #254  
 S. SIDE US 136 @ STA. 66+42.0, 22.8' RT.  
 NGVD 1929 = 675.00

BEGIN CONSTRUCTION - US 136  
 SECT (28)N,TS  
 STA 74+60.84

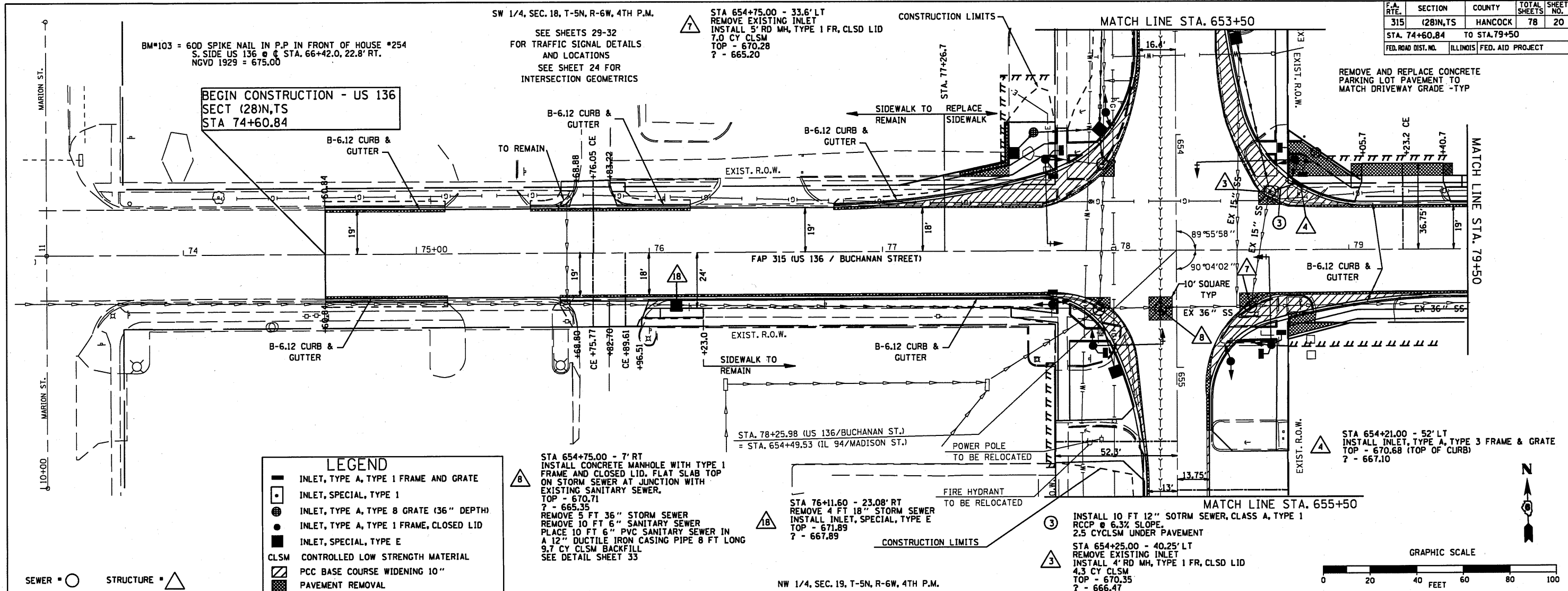

**LEGEND**

- INLET, TYPE A, TYPE 1 FRAME AND GRATE
- INLET, SPECIAL, TYPE 1
- INLET, TYPE A, TYPE B GRATE (36" DEPTH)
- INLET, TYPE A, TYPE 1 FRAME, CLOSED LID
- INLET, SPECIAL, TYPE E
- CLSM CONTROLLED LOW STRENGTH MATERIAL
- PCC BASE COURSE WIDENING 10"
- PAVEMENT REMOVAL

STA 654+75.00 - 7' RT  
 INSTALL CONCRETE MANHOLE WITH TYPE 1 FRAME AND CLOSED LID. FLAT SLAB TOP ON STORM SEWER AT JUNCTION WITH EXISTING SANITARY SEWER.  
 TOP - 670.71  
 ? - 665.35  
 REMOVE 5 FT 36" STORM SEWER  
 REMOVE 10 FT 6" SANITARY SEWER  
 PLACE 10 FT 6" PVC SANITARY SEWER IN A 12" DUCTILE IRON CASING PIPE 8 FT LONG  
 9.7 CY CLSM BACKFILL  
 SEE DETAIL SHEET 33

STA 76+11.60 - 23.08' RT  
 REMOVE 4 FT 18" STORM SEWER  
 INSTALL INLET, SPECIAL, TYPE E  
 TOP - 671.89  
 ? - 667.89

INSTALL 10 FT 12" SOTRM SEWER, CLASS A, TYPE 1  
 RCCP @ 6.3% SLOPE.  
 2.5 CYCLSM UNDER PAVEMENT

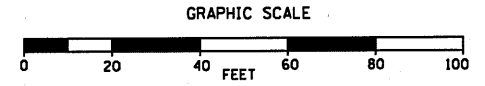

DATE: \_\_\_\_\_ BY: \_\_\_\_\_

PLAN

REVISIONS

NO. DATE BY DESCRIPTION

DATE: \_\_\_\_\_ BY: \_\_\_\_\_

PROFILE

REVISIONS

NO. DATE BY DESCRIPTION

