

FAP 510 (IL 96) PC STA 651+21.24
 N 1,403,464.95 E 1,964,945.38

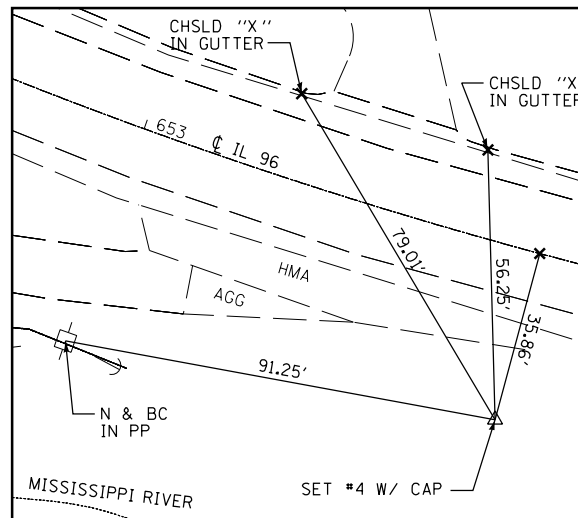

FAP 510 (IL 96) PI STA 653+92.74
 N 1,403,198.46 E 1,964,893.47

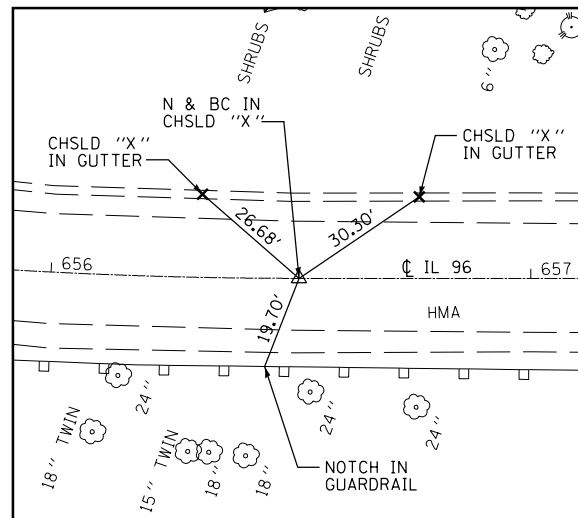

FAP 510 (IL 96) PT STA 656+51.69
 N 1,402,941.86 E 1,964,982.18

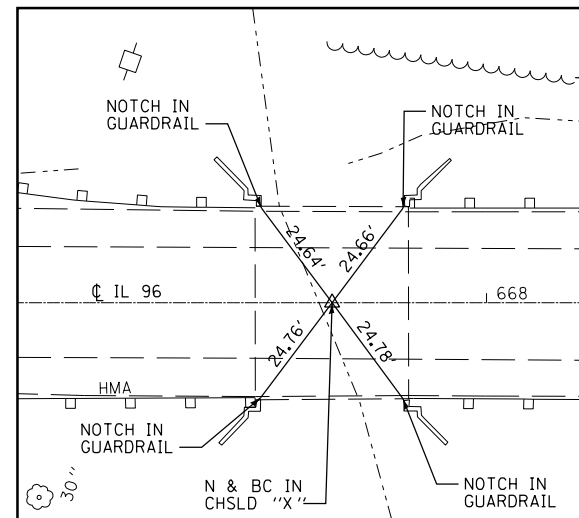

FAP 510 (IL 96) POT STA 667+67.84
 N 1,401,886.99 E 1,965,346.91

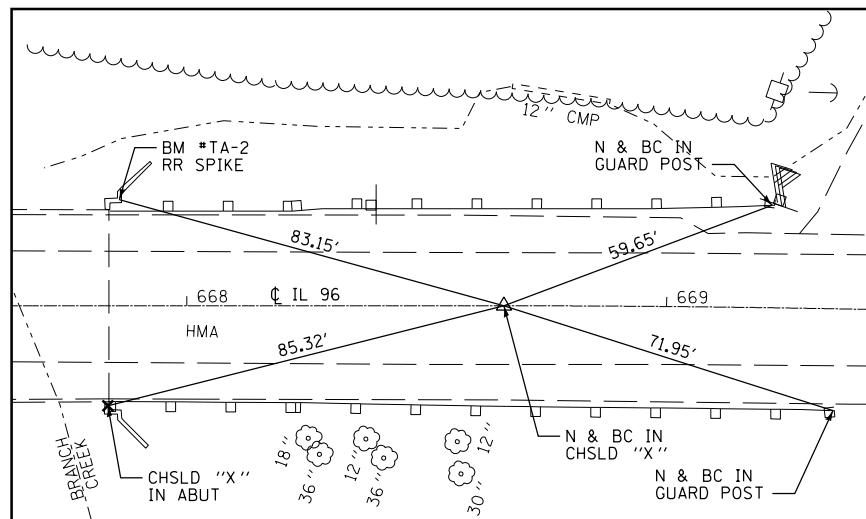

FAP 510 (IL 96) PC STA 668+66.11
 N 1,401,794.11 E 1,965,379.02

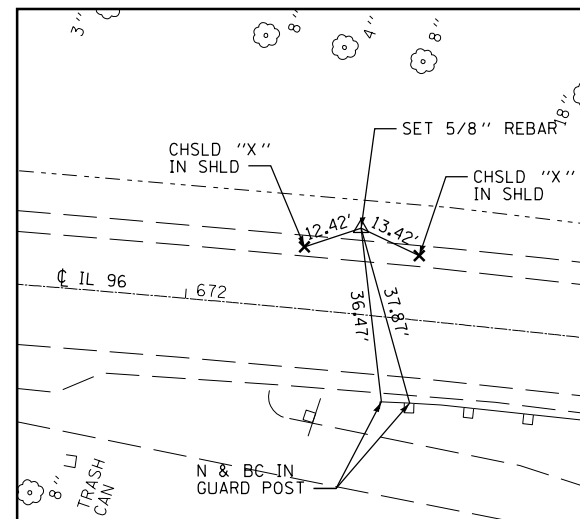

FAP 510 (IL 96) PI STA 672+36.18
 N 1,401,444.36 E 1,965,499.95

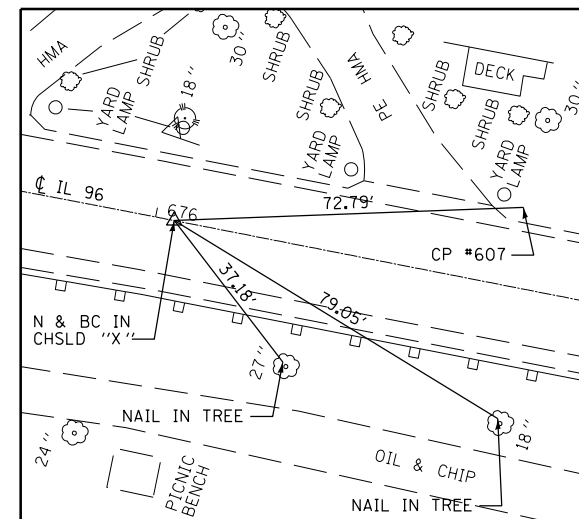

FAP 510 (IL 96) PT STA 676+03.93
 N 1,401,077.86 E 1,965,551.23

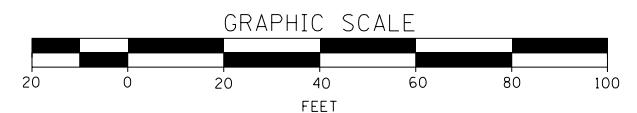

FILE NAME =	USER NAME = laughl1n1	DESIGNED -	REVISED -
et:\pw\work\p1\dot\laughl1n1\d0229631\Ties.dgn		DRAWN -	REVISED -
	PLOT SCALE = 400.0000' / in.	CHECKED -	REVISED -
	PLOT DATE = 8/9/2010	DATE -	REVISED -

**STATE OF ILLINOIS
 DEPARTMENT OF TRANSPORTATION**

HORIZONTAL CONTROL TIES

SCALE: 1"=20' SHEET NO. 1 OF 1 SHEETS

F.A.P. RTE.	SECTION	COUNTY	TOTAL SHEETS	SHEET NO.
510	120 (B-4, B-5)	HANCOCK	80	14
CONTRACT NO. 72A65				
FED. ROAD DIST. NO.		ILLINOIS FED. AID PROJECT		