

3—STA 666+85.4
 PIPE CULVERT, CL. D, TY 1, 15" X 76'
 METAL END SECTIONS, 1 EACH
 USFL 524.00, STA 666+70.0, 31.5' LT
 DSFL 521.00, STA 667+46.0, 31.5' LT
 TRENCH BACKFILL = 2.1 CU YD
 SEE DETAIL IN STRUCTURE PLANS

4—STA 669+50.0
 PIPE CULVERT, CL. D, TY 1, 24" X 48'
 METAL END SECTIONS, 2 EACH
 USFL 523.31, STA 669+72.1, 28.9' LT
 DSFL 522.32, STA 669+25.0, 35.7' LT
 TRENCH BACKFILL = 4.2 CU YD

EXIST. CURVE 11
 PI STA. = 672+36.18
 $\Delta = 11^\circ 06' 28''$ (RT)
 $D = 1^\circ 30' 20''$
 $R = 3,805.84'$
 $T = 370.07'$
 $L = 737.82'$
 $E = 17.95'$
 $e = N.C. \& \text{VARIES (SEE CROSS SECTIONS)}$
 P.C. STA. = 668+66.11
 P.T. STA. = 676+03.93
 S.E. ATTAINED MATCH EXISTING (SEE CROSS SECTIONS)

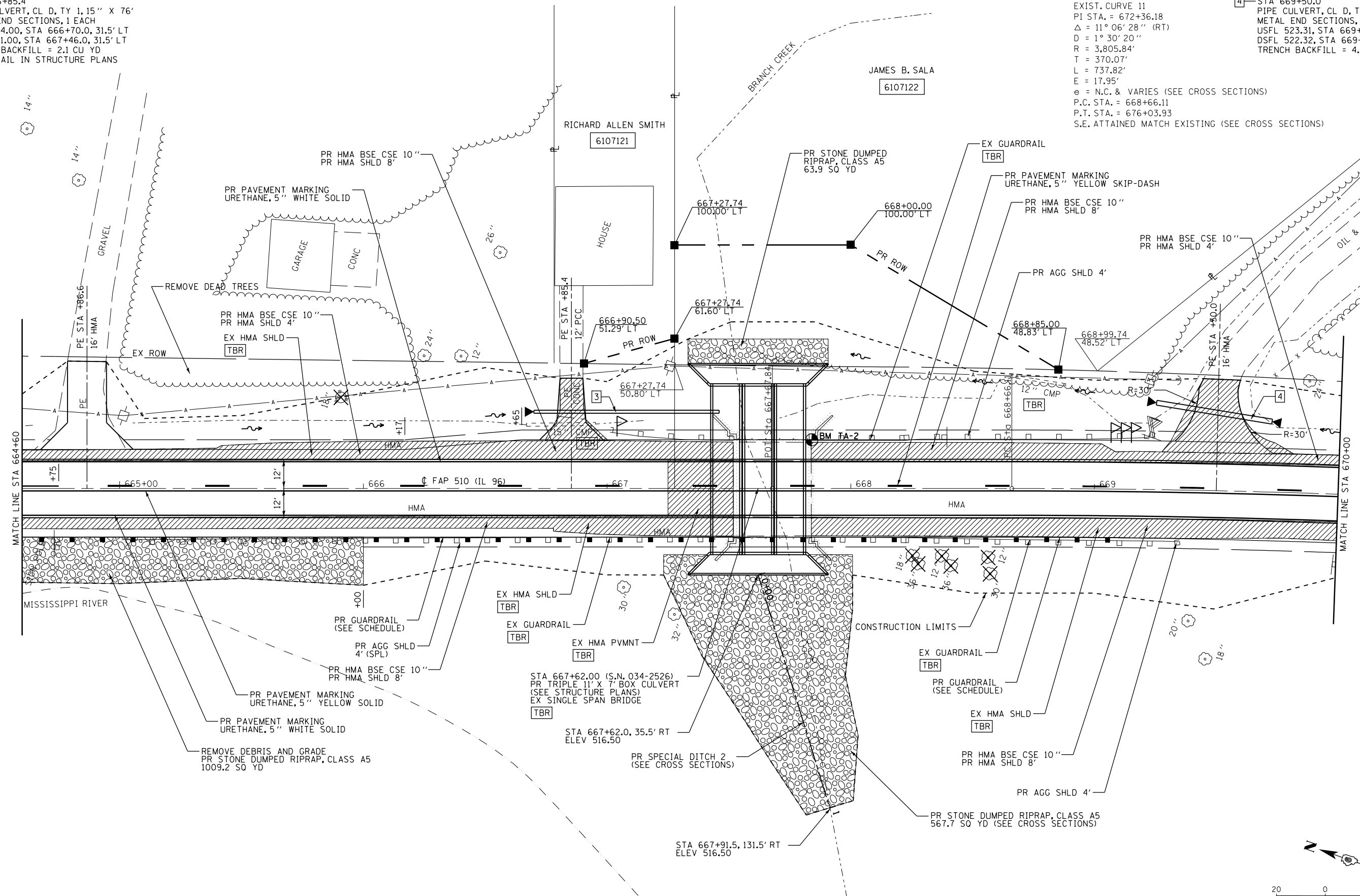

MATCH LINE STA 664+60

MATCH LINE STA 670+00

BM *TA-2 STA ± 667+84, 20.0' LT
 FOUND RAILROAD SPIKE FLUSH TOP OF W. WALL
 SOUTH EAST CORNER SN 034-0023

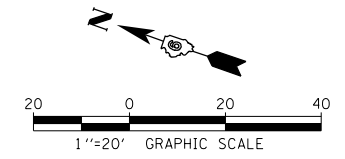

FILE NAME =	USER NAME = laughl1n1	DESIGNED -	REVISED -	STATE OF ILLINOIS DEPARTMENT OF TRANSPORTATION	PLAN	F.A.P. RTE.	SECTION	COUNTY	TOTAL SHEETS	SHEET NO.
et:\pw\work\p1dot\laughl1n1\1d0229630\PP03.dgn		DRAWN -	REVISED -			510	120 (B-4, B-5)	HANCOCK	80	28
PLOT SCALE = 40.0000' / in.		CHECKED -	REVISED -			CONTRACT NO. 72A65				
PLOT DATE = 8/9/2010		DATE -	REVISED -			FED. ROAD DIST. NO. ILLINOIS FED. AID PROJECT				