

DATE	
BY	
FINAL SURVEY	SURVEYED
NOTE BOOK	PLOTTED
NO.	TEMPLATE
	AREAS
	CHECKED

DATE	
BY	
ORIGINAL SURVEY	SURVEYED
NOTE BOOK	PLOTTED
NO.	TEMPLATE
	AREAS
	CHECKED

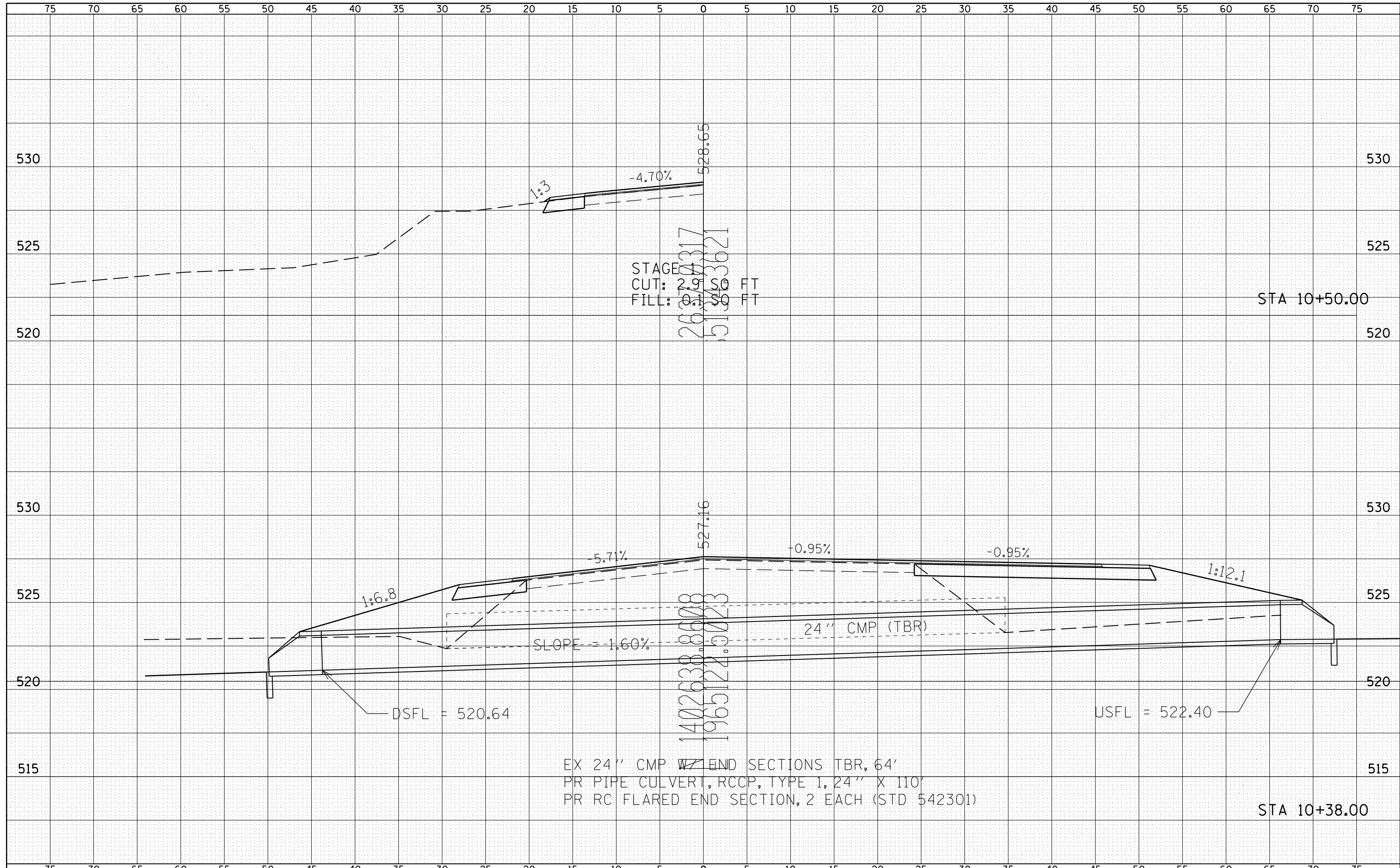

EX 24" CMP W/ END SECTIONS TBR, 64'
 PR PIPE CULVERT, RCCP, TYPE 1, 24" X 110'
 PR RC FLARED END SECTION, 2 EACH (STD 542301)

FILE NAME =	USER NAME = laughl1nr1	DESIGNED -	REVISIED -	STATE OF ILLINOIS DEPARTMENT OF TRANSPORTATION	TR 2130 CROSS SECTION		F.A.P. RTE.	SECTION	COUNTY	TOTAL SHEETS	SHEET NO.	
es:\pw_work\pwidot\laughl1nr1\d0229624\TR2130_xs	SHTS.dgn	CHECKED -	REVISIED -				510	120 (B-4, B-5)	HANCOCK	80	75	
	PLOT SCALE = 10.0000' / in.	DRAWN -	REVISIED -		SCALE: HORIZ 1"=10' VERT 1"=5'		SHEET NO. 1 OF 2 SHEETS		STA. 10+38.00	TO STA. 10+50.00	CONTRACT NO. 72A65	
	PLOT DATE = 8/9/2010	CHECKED -	REVISIED -				FED. ROAD DIST. NO.		ILLINOIS FED. AID PROJECT			