

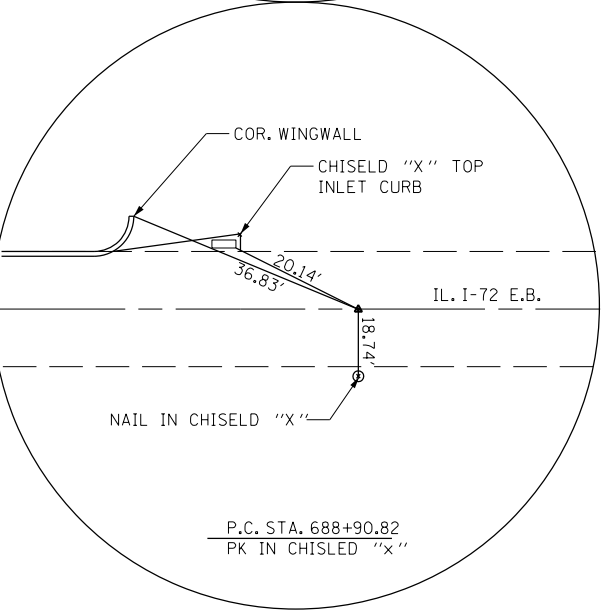

CURVE 321	E.B. I-72
P.I. STA.	693+04.84
DELTA =	20°-22'-59"
D =	02°-29'16"
T =	414.02'
L =	819.29'
R =	2,302.98'
E =	36.92'
CH. =	814.97'
MID ORD =	36.34'
P.C. STA.	688+90.82
P.T. STA.	697+10.11

CURVE 322	E.B. I-72
P.I. STA.	705+75.64
DELTA =	07°-31'-01"
D =	00°-36'-31"
T =	618.36'
L =	1,234.95'
R =	9,412.89'
E =	20.29'
CH. =	1,234.06'
MID ORD =	20.25'
P.C. STA.	699+57.28
P.T. STA.	711+92.22

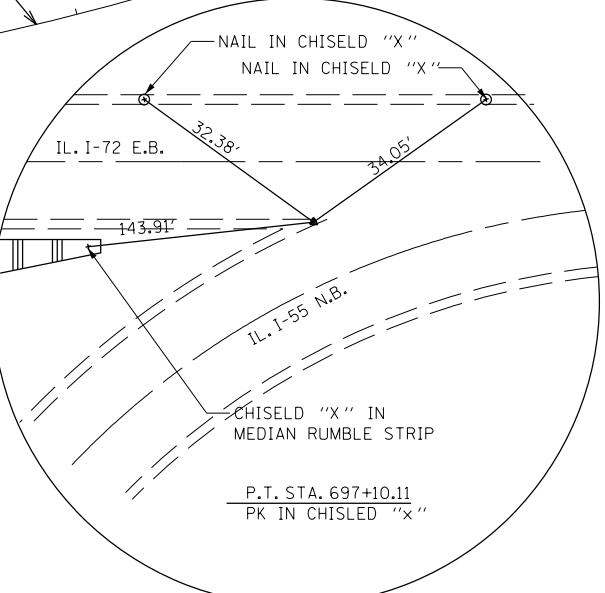
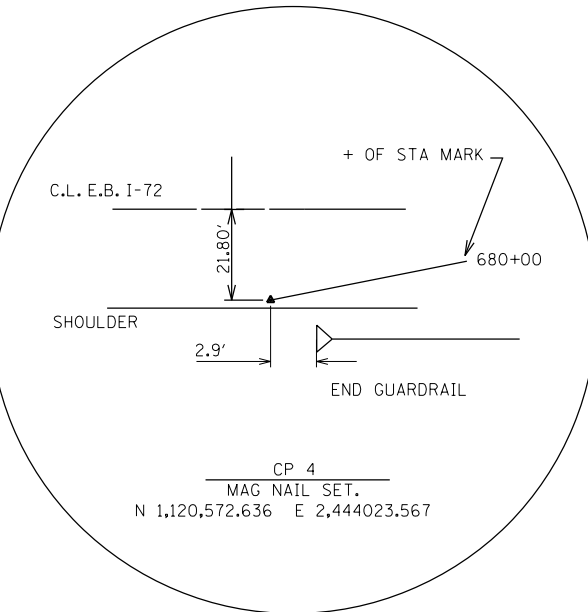
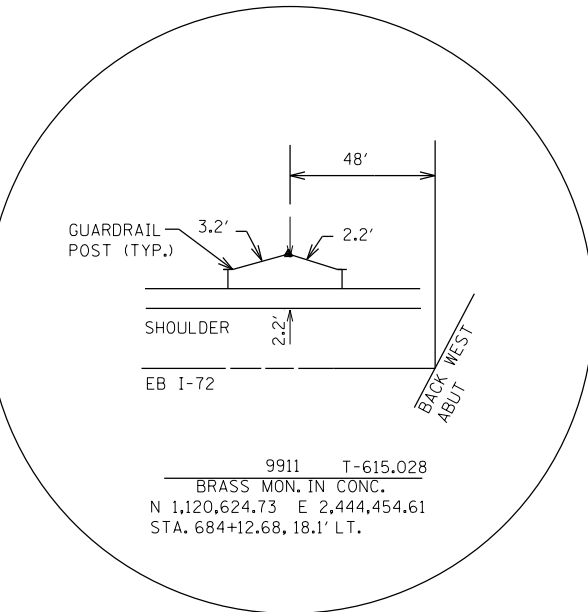
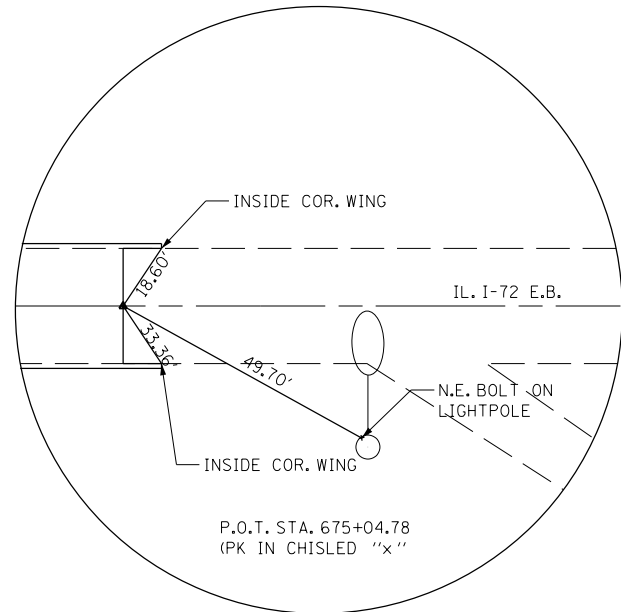
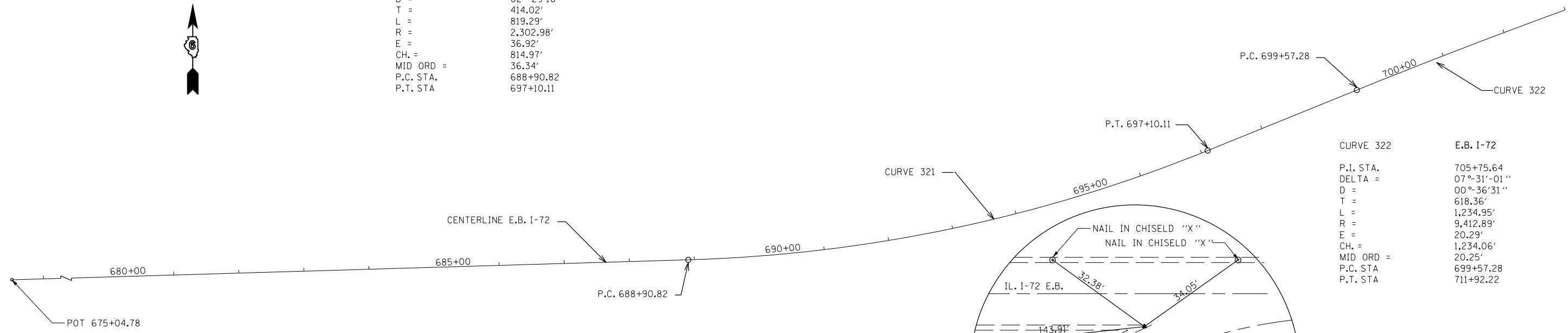

BM 100 CHISELED SQUARE @ SW CORNER OF THE CONCRETE FOUNDATION OF THE EAST PIER OF E.B. I-72 BRIDGE OVER S.B. I-55. ELEV. = 589.75'

BM 101A CHISELED SQUARE ON THE WEST END OF THE NORTH PARAPET WALL OF E.B. I-72 BRIDGE OVER S.B. I-55. ELEV. = 615.80'

NOTE: VERT. CONTROL NAVD 88

B.O.P. STA.	675+04.78	N 1,120,580.04	E 2,443,547.63
CURVE 321			
P.I. STA.	693+04.84	N 1,120,632.85	E 2,445,346.91
P.C. STA.	688+90.82	N 1,120,620.70	E 2,444,933.07
P.T. STA.	697+10.11	N 1,120,788.38	E 2,445,730.61
CURVE 322			
P.I. STA.	705+75.64	N 1,121,113.51	E 2,446,532.75
P.C. STA.	699+57.28	N 1,120,881.22	E 2,445,959.68
P.T. STA.	711+92.22	N 1,121,268.83	E 2,447,131.29
E.O.P. STA.	714+05.50	N 1,121,322.40	E 2,447,337.73

FILE NAME = c:\pwork\pwork\1\laughlin\1\0231206\062A64-sh-t-atb.dgn

USER NAME = laughlin1
 2A64-sh-t-atb.dgn
 PLOT SCALE = 40.0000' / in.
 PLOT DATE = Aug-11-2010 01:04:17PM

DESIGNED - LLO
 DRAWN - JJS
 CHECKED - MTM
 DATE - JANUARY 2010

REVISED -
 REVISED -
 REVISED -
 REVISED -

STATE OF ILLINOIS
 DEPARTMENT OF TRANSPORTATION

EXISTING ALIGNMENT, TIES AND BENCHMARKS OF E.B. I-72

SCALE: 1IN. = 20FT. SHEET NO. 1 OF 1 SHEETS STA. 682+25.59 TO STA. 690+32.59

F.A.I. RTE.	SECTION	COUNTY	TOTAL SHEETS	SHEET NO.
72	(84-3HB-5)BR	SANGAMON	84	8
S.N. 084-0078		CONTRACT NO. 72C70		
FED. ROAD DIST. NO. 6 ILLINOIS FED. AID PROJECT				