

FAI 72 & US 36

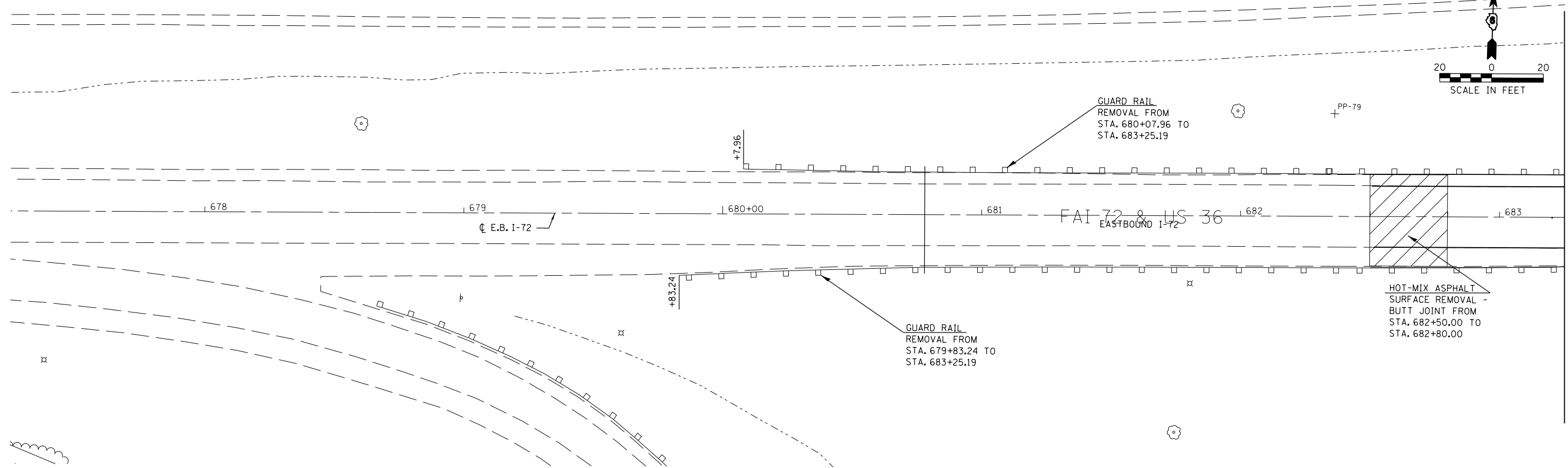

MATCH STATION 683+25.19

**LEGEND**

- APPROACH SLAB REMOVAL
- PAVEMENT REMOVAL
- BUTT JOINT

FILE NAME =	USER NAME = laughlinc1	DESIGNED - LLO	REVISED -
et:\pwork\pwork\laughlinc1\0231206\062A64-shr-rem.dgn		DRAWN - JJS	REVISED -
	PLOT SCALE = 40.0000' / in.	CHECKED - MTM	REVISED -
	PLOT DATE = Aug-11-2010 01:11:15PM	DATE - JANUARY 2010	REVISED -

**STATE OF ILLINOIS  
DEPARTMENT OF TRANSPORTATION**

**I-72 EB REMOVAL PLANS**

SCALE: 1"=20'      SHEET NO. 1 OF 3 SHEETS      STA. 678+00.00 TO STA. 683+25.19

F.A.I. RTE.	SECTION	COUNTY	TOTAL SHEETS	SHEET NO.
72	(84-3HB-5)BR	SANGAMON	84	34
S.N. 084-0078			CONTRACT NO. 72C70	
FED. ROAD DIST. NO. 6      ILLINOIS FED. AID PROJECT				