

F.A.I. RTE.	SECTION	COUNTY	TOTAL SHEETS	SHEET NO.
72	(84-3HB-5)BR	SANGAMON	84	1

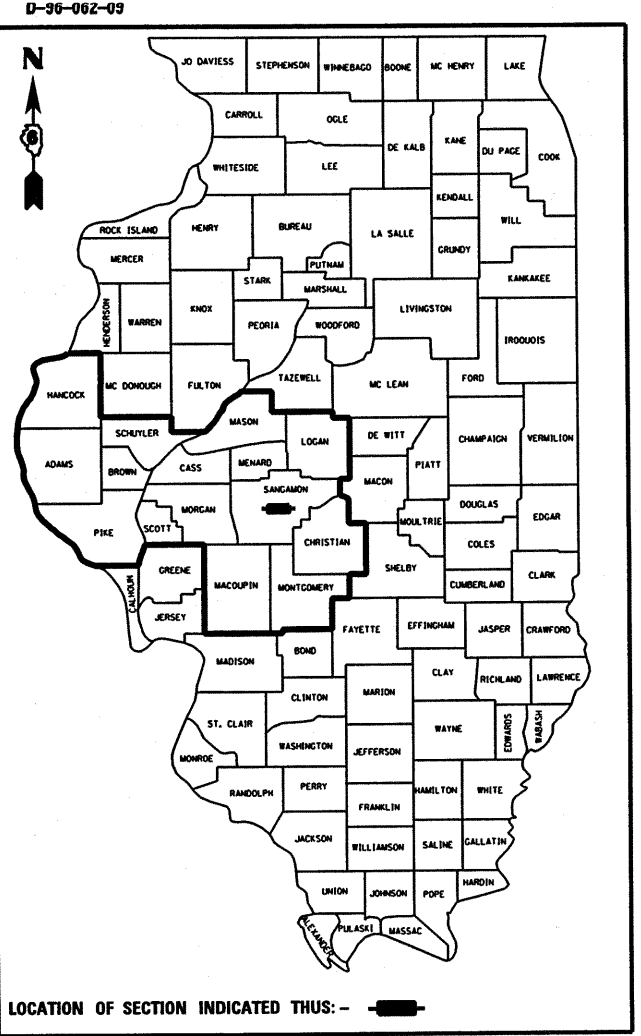

DESIGN DESIGNATION

SECTION (84-3HB-5)BR I-72 EB;	SECTION (84-3HB-5)BR I-55 SB;
SPEED LIMIT: 65 MPH ADT = 15,600 (2009) PV = 90% SU = 2.4% MU = 7.6%	SPEED LIMIT: 65 MPH ADT = 24,450 (2009) PV = 85.3% SU = 3.6% MU = 11.1%

HIGHWAY CLASSIFICATION
SECTION (84-3HB-5)BR: INTERSTATE

STATE OF ILLINOIS
DEPARTMENT OF TRANSPORTATION
DIVISION OF HIGHWAYS

SUBMITTED August 13 2010
Roger Z Smiley
DEPUTY DIRECTOR OF HIGHWAYS, REGION ENGINEER

October 1 2010
Scott E. Stitt, P.E.
acting ENGINEER OF DESIGN AND ENVIRONMENT

October 1 2010
Christine M. Rosler
DIRECTOR OF HIGHWAYS, CHIEF ENGINEER

**PRINTED BY THE AUTHORITY
OF THE STATE OF ILLINOIS**

STATE OF ILLINOIS
DEPARTMENT OF TRANSPORTATION
DIVISION OF HIGHWAYS

**PROPOSED
HIGHWAY PLANS**

F.A.I. 72 (I-72)
SECTION (84-3HB-5)BR
PROJECT : ACIM-072-3(007)098
SANGAMON COUNTY

C-96-062-09

(84-3HB-5)BR: BRIDGE DECK REPLACEMENT I-72 EB OVER I-55 (SB)
INTERSTATE RESURFACING

INDEX OF SHEETS	TOTAL SHEETS
1	COVER SHEET
2	GENERAL NOTES
3-4	SUMMARY OF QUANTITIES
5	TYPICAL SECTIONS
6-7	SCHEDULE OF QUANTITIES
8	ALIGNMENT, TIES AND BENCHMARKS
9-11	PLAN & PROFILE SHEETS
12-21	STAGES OF CONSTRUCTION
22-25	ADVANCED WARNING & MAINTENANCE OF TRAFFIC
26-27	DETOUR ROUTE SIGNING
28-30	EROSION CONTROL PLANS
31-33	PAVEMENT MARKING PLANS
34-36	REMOVAL PLANS
37-78	BRIDGE PLANS
79-79A	DETAILS
80-84	CROSS-SECTIONS

FOR LIST OF STANDARDS, SEE SHEET NO. 2

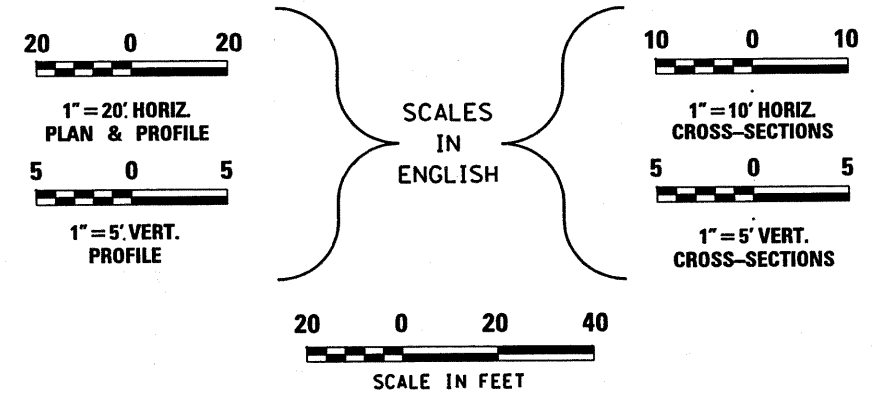

FULL SIZE PLANS HAVE BEEN PREPARED USING STANDARD ENGINEERING SCALES, REDUCED SIZED PLANS WILL NOT CONFORM TO STANDARD SCALES, IN MAKING MEASUREMENTS ON REDUCED PLANS, THE ABOVE SCALES MAY BE USED.

MICROFILMED _____
REEL NUMBER _____
AWARDED _____
RESIDENT ENGINEER _____
AS BUILT CHANGES WERE MADE
ON THE FOLLOWING SHEETS _____

J.U.L.I.E.
JOINT UTILITY LOCATION INFORMATION FOR EXCAVATION
1-800-892-0123

DISTRICT 6 NO. (217) 782-7301
PROJECT ENGINEER: SAL MADONIA (217) 782-4761
TEAM ENGINEER: JEFF MYERS (217) 524-7940
CONTRACT NO. 72C70

**Farnsworth
GROUP**
2709 McGraw Drive
Bloomington, Illinois 61704
309/663-8435, 309/663-1571 fax

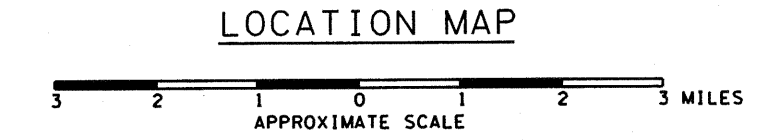
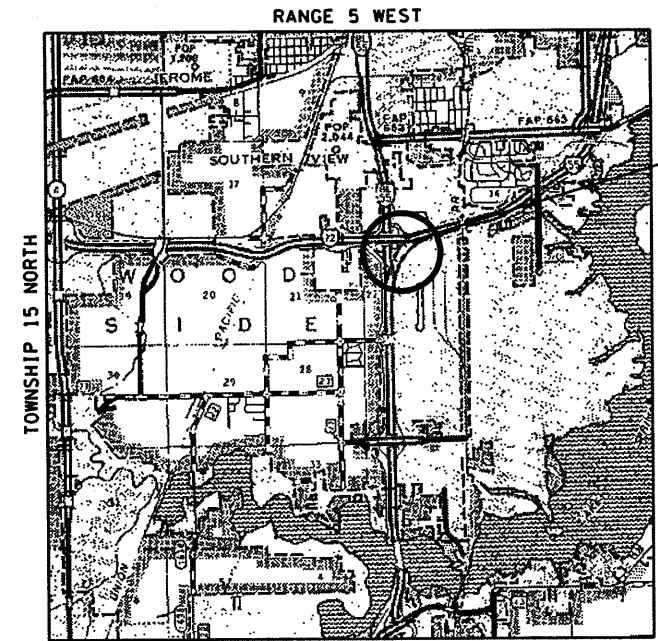

GROSS LENGTH (SN 084-0078) = 972.00 FT. = 0.184 MI.
NET LENGTH (SN 084-0078) = 972.00 FT. = 0.184 MI.

LICENSED PROFESSIONAL ENGINEER
MICHAEL T. MATZKE
062-038471
STATE OF ILLINOIS

Michael T. Matzke
SIGNATURE
8/10/2010
DATE
LIC. EXP. DATE : 11/30/2011