

PLAN
 SURVEYED
 ALIGNED
 CHECKED
 DATE
 BY
 NO. OF PAV CHECKED
 ROAD FILE NAME

PROFILE
 SURVEYED
 GRADES CHECKED
 DATE
 BY
 NO. OF PAV CHECKED
 PROFILE NOTATION

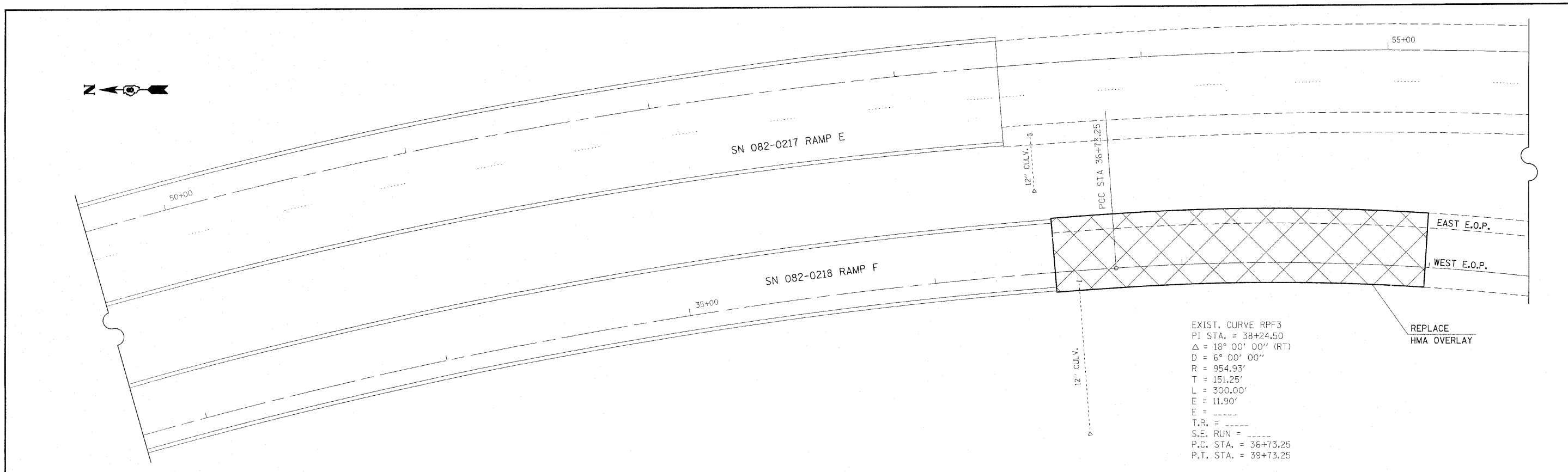

EXIST. CURVE RPF3
 PI STA. = 38+24.50
 $\Delta = 18^\circ 00' 00''$ (RT)
 $D = 6^\circ 00' 00''$
 $R = 954.93'$
 $T = 151.25'$
 $L = 300.00'$
 $E = 11.90'$
 $T.R. =$
 $S.E. RUN =$
 $P.C. STA. = 36+73.25$
 $P.T. STA. = 39+73.25$

REPLACE
 HMA OVERLAY

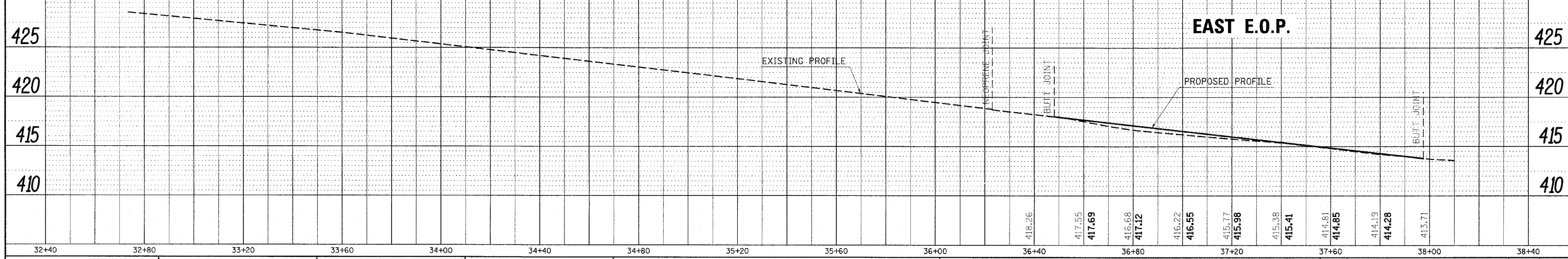
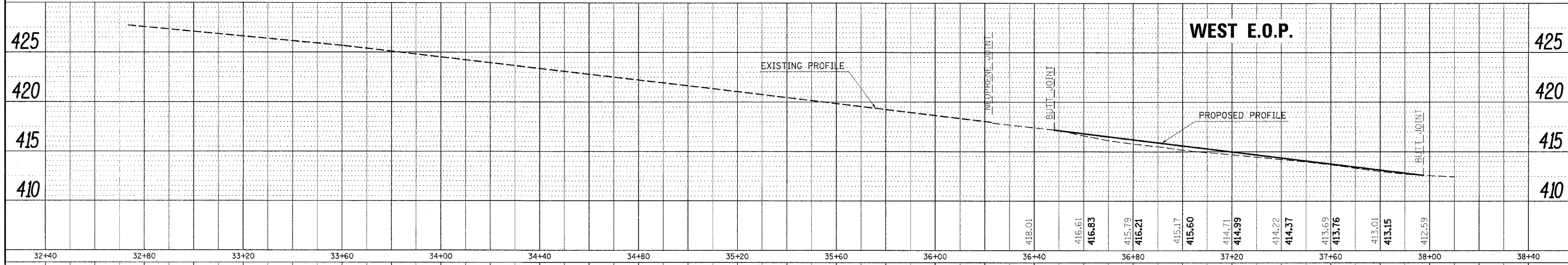

FILE NAME =	USER NAME = owebj	DESIGNED -	REVISED -	STATE OF ILLINOIS DEPARTMENT OF TRANSPORTATION	RAMP F PROFILES		F.A.T. TOTAL	SECTION	COUNTY	TOTAL SHEETS	SHEET NO.
c:\pwwork\pwwork\owebj\dms66748\d876c33	sht-plan.dgn	CHECKED -	REVISED -		255	82-THB-I	ST. CLAIR	43	5		
PLOT SCALE = 20,0000' / IN.		DRAWN -	REVISED -		SCALE: SHEET NO. OF SHEETS STA. TO STA.		CONTRACT NO. 76C33		ILLINOIS FED. AID PROJECT		
PLOT DATE = 8/11/2010		CHECKED -	REVISED -								