



**SCHEDULE OF QUANTITIES**

TEMPORARY CONCRETE BARRIER	STATION TO STATION	FEET
	827+89.15 - 831+89.15	400
	TOTAL	400

TEMPORARY BRIDGE TRAFFIC SIGNALS - 1 EACH

IMPACT ATTENUATORS, TEMPORARY (NON-REDIRECTIVE), TEST LEVEL 3 - 2 EACH

**LEGEND**

- TRAFFIC SIGNAL WITH BACKPLATE, SIGNAL DIRECTION INDICATED
- BASE COURSE WIDENING, 10"
- TEMPORARY RAMP
- PAVEMENT REMOVAL

**GENERAL NOTES**

- TRAFFIC CONTROL SHALL BE ERECTED AS SHOWN AND ACCORDING TO "TRAFFIC CONTROL AND PROTECTION, STANDARD 701321."
- SEE SPECIAL PROVISIONS FOR ADDITIONAL TRAFFIC CONTROL REQUIREMENTS.
- COORDINATE LOCATION OF SIGNALS WITH FINAL WORK AS DIRECTED BY THE ENGINEER.
- SIGNS SHOWN IN ADVANCE OF THE STOP BARS ON STANDARD 701321 ARE ALSO REQUIRED ALONG COUNTY ROAD 7. LOCATIONS OF SIGNS SHALL BE AS DIRECTED BY THE ENGINEER.
- ADDITIONAL SIGNAGE FOR SIDE ROADS AND ENTRANCES SHALL BE INCLUDED IN THE COST OF STANDARD 701321.
- THE DIMENSION SHOWN ON THE WIDTH RESTRICTION SIGN (W12-1102(0)-48) SHOWN ON STANDARD 701321 SHALL BE 11'-0" FOR STAGE I CONSTRUCTION.

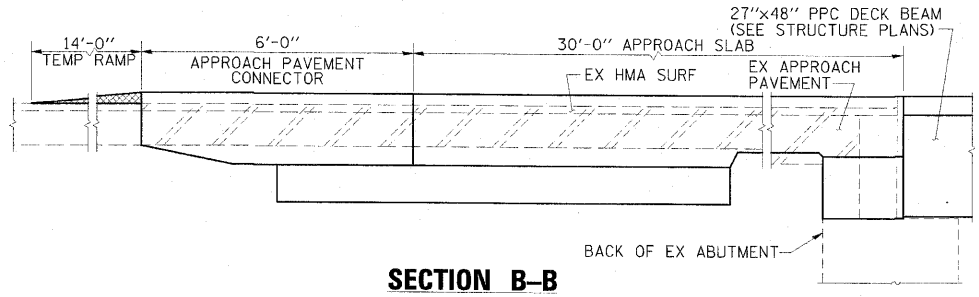
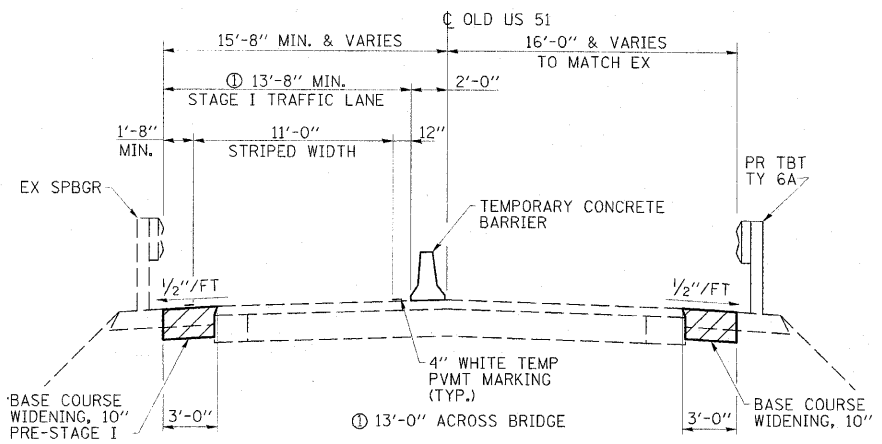
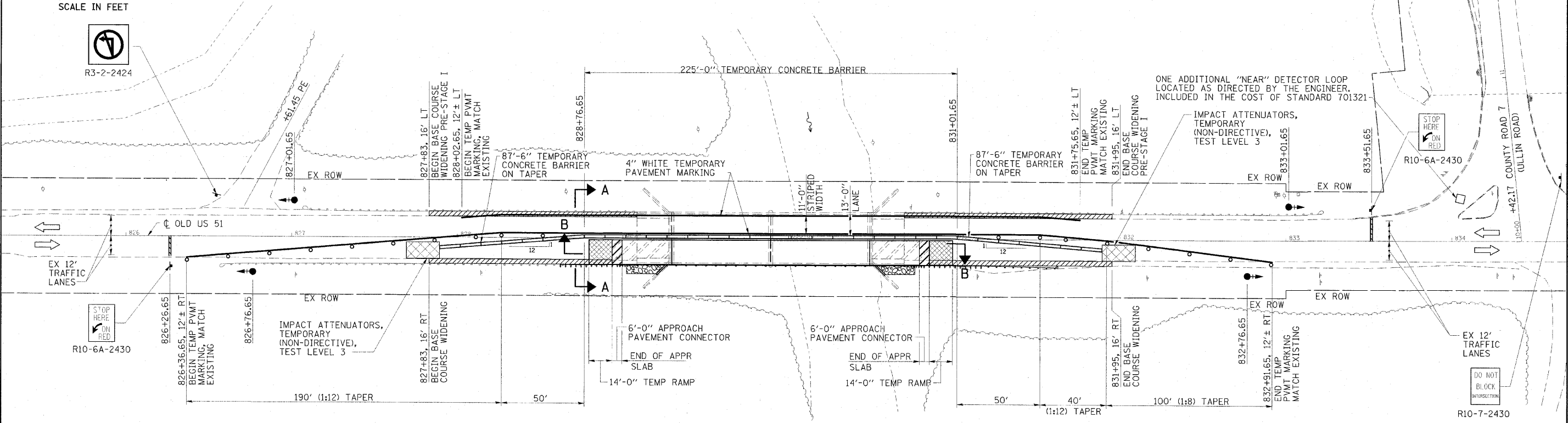
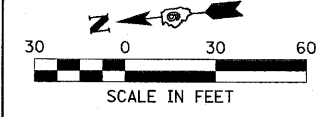

FILE NAME: 0978071-ahv-staging51.dgn	USER NAME: HAS	DESIGNED: DAJ	REVISED:	<b>STATE OF ILLINOIS DEPARTMENT OF TRANSPORTATION</b>	<b>STAGE I CONSTRUCTION</b>	F.A.S. RTE. 2936	SECTION 14BR-1	COUNTY PULASKI	TOTAL SHEETS 68	SHEET NO. 10		
PLD SCALE: 1/8" = 1'-0"	CHECKED: MTD	REVISOR:	SCALE: 1" = 30'-0"			SHEET NO. 1 OF 2 SHEETS	STA. 825+50 TO STA. 834+50	FED. ROAD DIST. NO. ILLINOIS FED. AID PROJECT	CONTRACT NO. 78071			
PLD DATE: 5/17/2010	DATE: 5/10	REVISOR:										