

PLAN SURVEYED BY DATE
 PLOTTED BY
 NOTE BOOK NO. OF WAY CHECKED
 NO. FILE NAME

PROFILE SURVEYED BY DATE
 PLOTTED BY
 NOTE BOOK NO. OF WAY CHECKED
 NO. FILE NAME

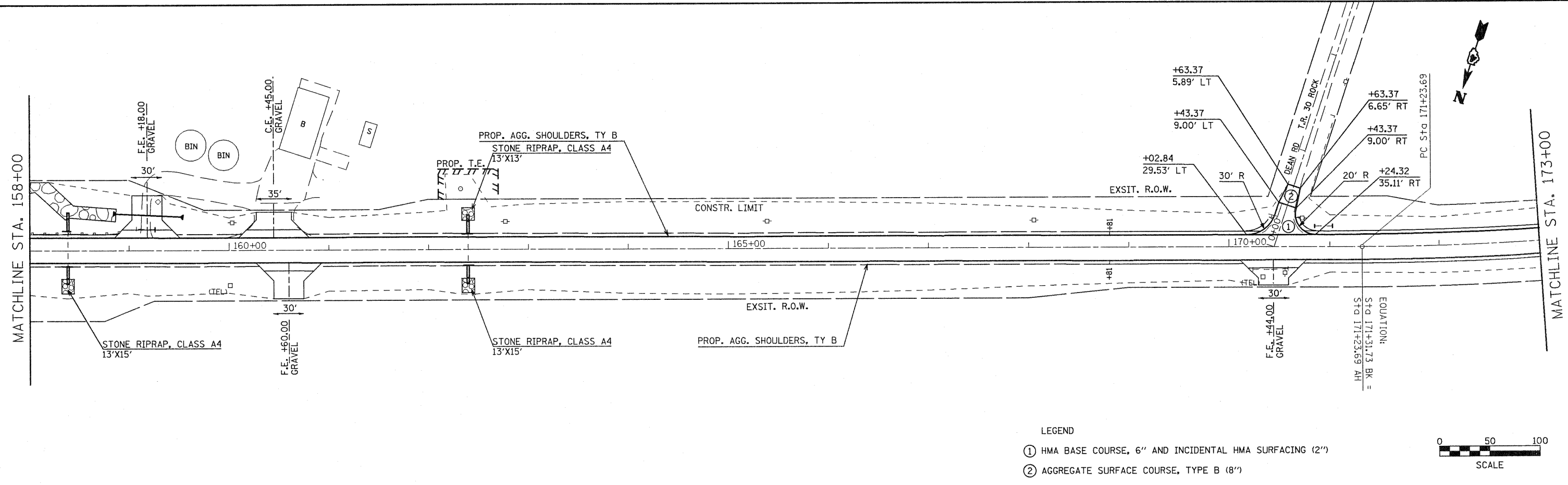

- LEGEND
- ① HMA BASE COURSE, 6" AND INCIDENTAL HMA SURFACING (2")
 - ② AGGREGATE SURFACE COURSE, TYPE B (8")

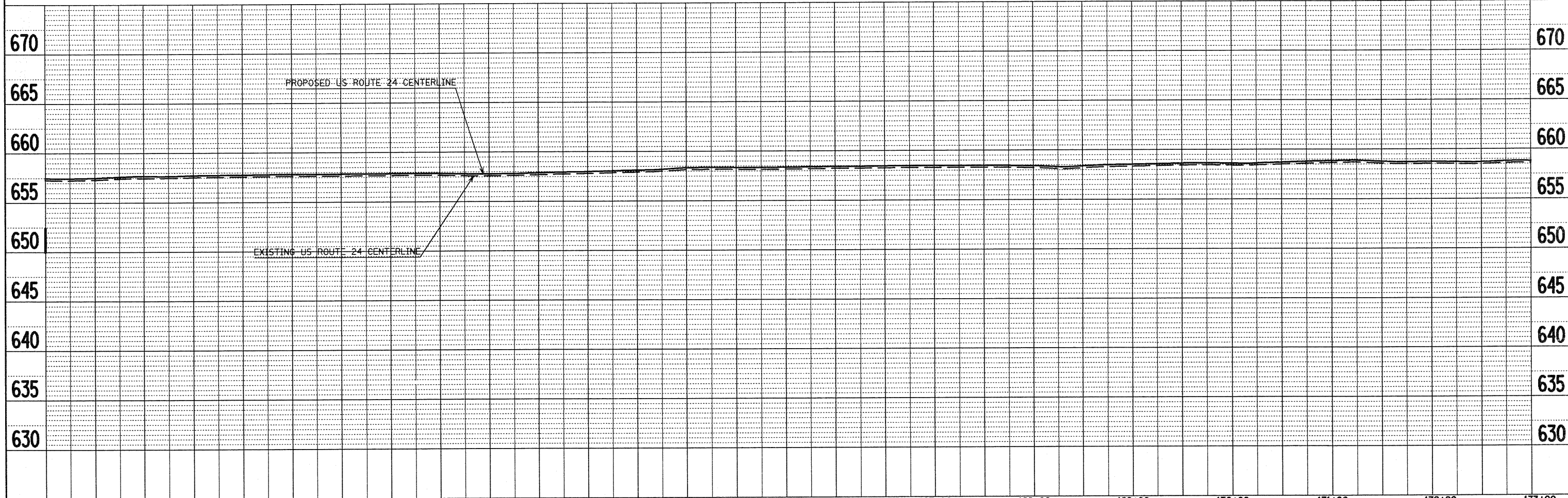

FILE NAME = plan01.dgn	USER NAME = horatkj	DESIGNED - DRAWN - JGJ	REVISED - REVISED -	CHECKED - KJH	REVISED -	DATE -	REVISED -	STATE OF ILLINOIS DEPARTMENT OF TRANSPORTATION	PLAN & PROFILE	F.A.P. RTE. 317	SECTION 15W-2,RS-3;16W-3,RS-5	COUNTY FULTON	TOTAL SHEETS 171	SHEET NO. 52
PLOT SCALE = 100.0000' / IN. PLOT DATE = 8/10/2018								SCALE: SHEET NO. 10 OF 14 SHEETS STA. 158+00 TO STA. 173+00		CONTRACT NO. 88098 FED. ROAD DIST. NO. ILLINOIS FED. AID PROJECT				